



British Inherited Metabolic Disease Group

# **Annual Symposium 2025**

## **John McIntyre Conference Centre, The University of Edinburgh**



**Tuesday 17 - Wednesday 18 June 2025**

# **Supporter & Exhibitor Pack**

# About the BIMDG Annual Symposium 2025



The British Inherited Metabolic Diseases Group (BIMDG) Annual Symposium is a cornerstone event for healthcare professionals, researchers, and academics dedicated to the field of inherited metabolic diseases. This gathering provides a unique platform for multidisciplinary collaboration, with specialists in clinical practice, research, and patient care coming together to discuss the latest advancements in diagnosis, treatment, and management of metabolic disorders.

Held annually, the BIMDG symposium features a range of presentations and workshops, including clinical case studies, research findings, and discussions on emerging therapies. Attendees benefit from keynote lectures delivered by leading experts, offering insights into cutting-edge developments in metabolic medicine. The event fosters open dialogue on the challenges and opportunities in the field, with ample opportunities for networking and collaboration among professionals across different areas of expertise.

The symposium is known for its focus on continuing education, offering professionals updates on guidelines, treatment protocols, and innovative approaches to managing inherited metabolic diseases. Poster sessions and oral presentations allow for a deeper dive into specific research projects, while interactive workshops provide hands-on learning experiences. Overall, the BIMDG Annual Symposium plays a crucial role in advancing knowledge and enhancing patient care in this highly specialised area of medicine.



# Platinum Supporter Package

(1 available)  
**£7,000+VAT**

## Includes:

- Exhibition space: 3x3m Stand in a premium location within the exhibition space where refreshments & catering will be served
- Company logo on all signage at the Symposium
- 4 x Exhibitor Passes including refreshments
- Option to purchase 2 additional Exhibitor Passes
- 4 x Dinner Passes

## New for 2025:

- Digital advert on the main homepage
- 1 x Screen time advert on the main screen
- 1 x Event App push notification to all delegates during the Symposium
- Your logo on every page of the event programme, as well as your logo, hyperlink and 500 word company overview on the Exhibitor page of the event website
- Your logo on all pre and post event marketing material (including delegate emails)
- Your logo on every delegate badge
- Company logo on event holding slides
- Access to delegates before, during, and after the event via the App

**Pharmaceutical company attendance is not permitted during the parallel sessions**

Please note all content of symposia, adverts and push notifications are subject to approval of the BIMDG Organising Committee.  
All stands, including those within the sponsorship packages, includes power to their stand

## Gold Supporter Package

(5 available)  
**£5,500+VAT**

### Includes:

- Exhibition space: 3x2m Stand within the exhibition space where refreshments & catering will be served
- 3 x Exhibitor Passes including refreshments
- Option to purchase 2 additional Exhibitor Passes
- 3 x Dinner Passes

### New for 2025:

- Digital support on the Event App
- 3 x Scrolling banner ads on the app
- 1 x Email push notification to be sent to all delegates during the Symposium
- Your logo, hyperlink and 500 word company overview on Exhibitor Page of the event website
- Access to delegates before, during, and after the event via the App

## Silver Supporter Package

(13 available)  
**£4,500+VAT**

### Includes:

- Exhibition space: 2x2m Stand within the exhibition space where refreshments & catering will be served
- 2 x Exhibitor Passes including refreshments
- Option to purchase 2 additional Exhibitor Passes
- 2 x Dinner Passes

### New for 2025:

- Digital support on the Event App
- Your logo, hyperlink and 500 word company overview on Exhibitor Page of the event website
- Access to delegates before, during, and after the event via the App

**Pharmaceutical company attendance is not permitted during the parallel sessions**

Please note all content of symposia, adverts and push notifications are subject to approval of the BIMDG Organising Committee.  
All stands, including those within the sponsorship packages, includes power to their stand

# Additional Supporter Items

<b>Conference Dinner</b> Support includes your banners stands displayed at the venue along with a short spoken welcome to the attendees. Including 4 tickets	<b>£2,500+VAT</b>
<b>Exhibition Drinks Reception</b> Support includes your banners stands displayed along with a short spoken welcome to the attendees	<b>£1,000+VAT</b>
<b>Delegate Lanyard only</b> Branded lanyards with your logo and BIMDG (limited to one)	<b>£800+VAT</b>
<b>Digital Advert</b> on the Conference App	<b>£500+VAT</b>
<b>Push Notification</b> to all delegates on the Conference App	<b>£500+VAT</b>
<b>Scrolling Banner</b> on the Conference App	<b>£500+VAT</b>
<b>Push Notification &amp; Scrolling Banner</b> to all delegates on the Conference App	<b>£900+VAT</b>



**Frosted Magenta Pen**  
**£500+VAT**  
1 colour printed logo



**A5 Soft Feel Notebook**  
**£1,360+VAT**  
1 colour printed logo



**Americano Cup**  
**£1,000+VAT**  
1 colour printed logo

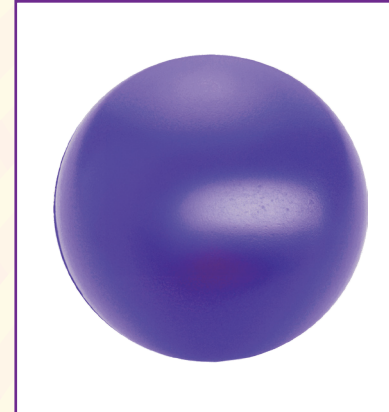

**Stress Ball**  
**£500+VAT**  
1 colour printed logo

# Exhibition Floor Plan

## Key

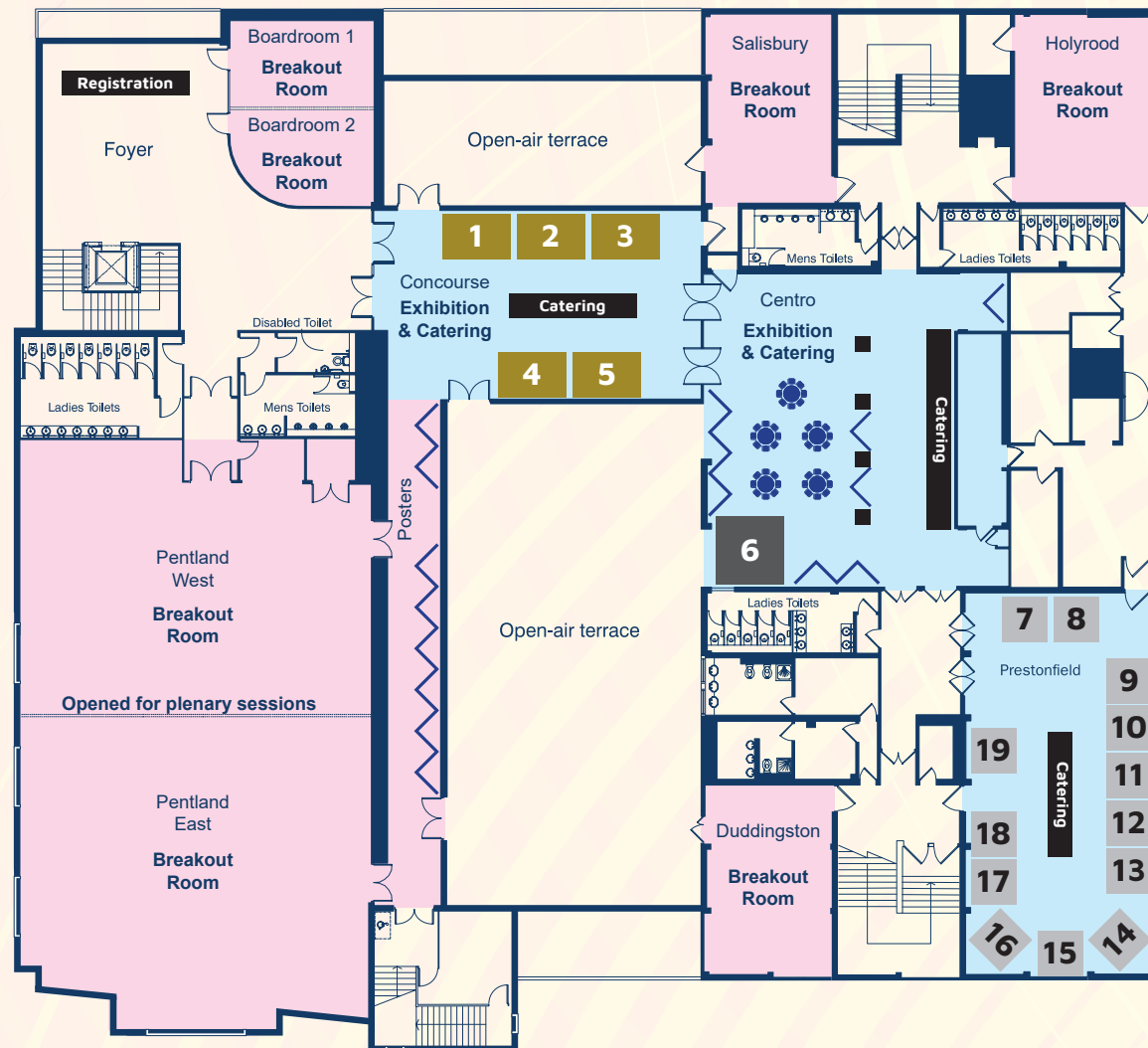
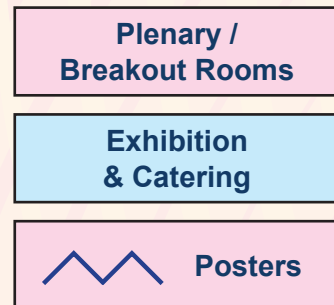

## Stand Options





# The Venue



British Inherited Metabolic Disease Group

## John McIntyre Conference Centre, The University of Edinburgh

Pollock Halls, 18 Holyrood Park Road, Edinburgh EH16 5AY

### INSPIRED BY THE PAST, BUILT FOR THE FUTURE

The John McIntyre Conference Centre (JMCC) is a prominent event venue located in Edinburgh, Scotland, part of the Pollock Halls of Residence, which is the accommodation complex of the University of Edinburgh. Nestled at the base of Arthur's Seat, an iconic extinct volcano, the JMCC offers a scenic and accessible location for various conferences, meetings, and events.

Surrounded by attractive landscapes and located close to Edinburgh's historic city centre, the JMCC combines the charm of Edinburgh with modern amenities, making it a versatile and well-regarded location for events. Its proximity to Pollock Halls also allows for convenient accommodation options for delegates attending multi-day events.

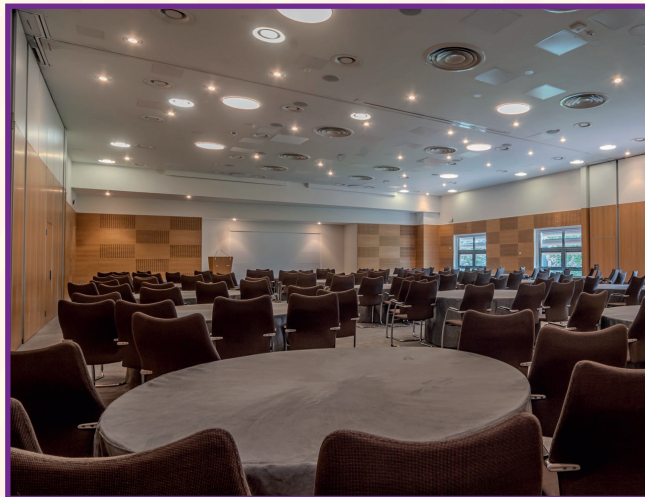

[www.bimdgconference.co.uk](http://www.bimdgconference.co.uk)



## Getting to JMCC by Bus, Rail & Air

**By Bus:** Edinburgh's primary bus terminal is at St Andrews Square, offering connections across the UK. For routes, visit: [National Express](#) or [City Link](#). For local services, check [Lothian Buses](#).

**By Train:** Edinburgh boasts two railway stations although we recommend using Waverley Station, Check [Scot Rail](#) for more information:

- Waverley Station: 1.4 miles from JMCC, with direct routes nationwide.

From Waverley a taxi will take 5-10 mins. For a bus from Waverley you should exit the station on to Princes Street and turn right. Cross to the other side of North Bridge and turn right on to the bridge. From the first bus stop, take a number 14, 30 or 33 to the Commonwealth Pool Stop. Turn back along the way you have come and turn right on to Holyrood Park Road and you will see Pollock Halls on your right. This is likely to take about half an hour.

**From Edinburgh Airport by Bus:** Take Airlink 100 for a frequent service to the city centre. Visit [Lothian Buses](#) for more info.

**Travelling to Edinburgh by Plane:** Edinburgh has one of the UK's fastest growing airports and new flights are always being added. Edinburgh Airport is 8 miles away. A taxi from Edinburgh Airport to the venue should cost £25/£30. There is a bus from the airport to Waverley Bridge ("Airlink"), from there, see above for directions from Waverley (the station).

For more information on which airlines and destinations connect to Edinburgh visit [www.edinburghairport.com](http://www.edinburghairport.com).



British Inherited Metabolic Disease Group

## Location Map

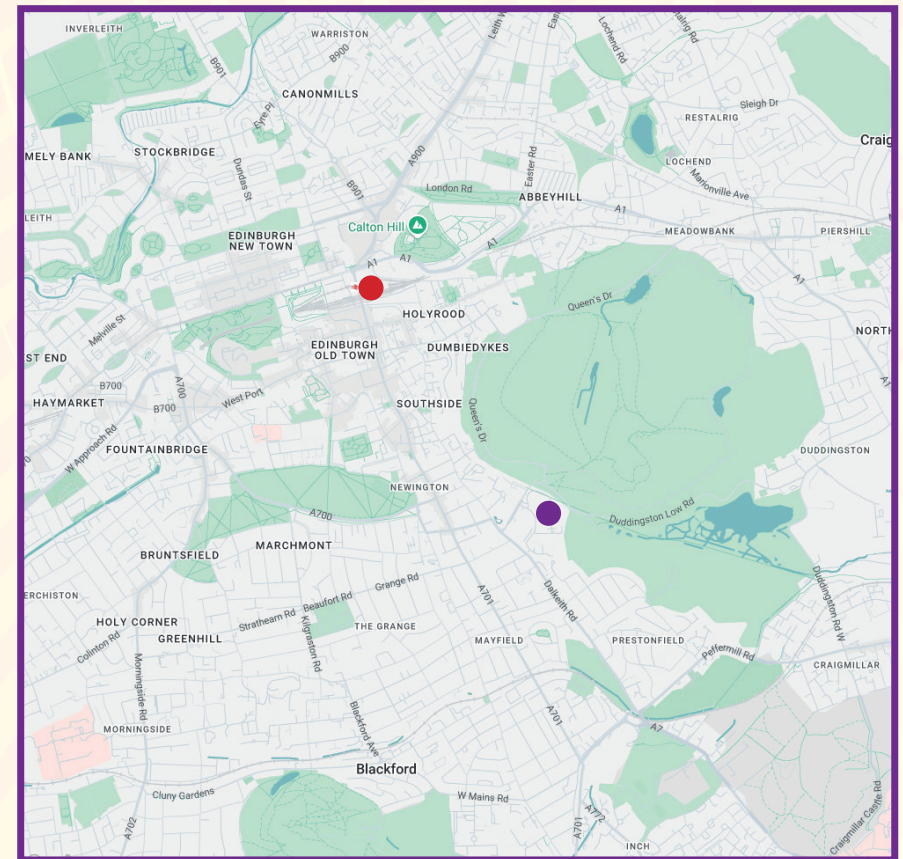

● Train Station ● JMCC



British Inherited Metabolic Disease Group

## We hope you can join us

The British Inherited Metabolic Diseases Group (BIMDVG) Annual Symposium is a significant event for professionals and researchers involved in the study and treatment of inherited metabolic disorders. Typically, it serves as a platform for sharing the latest research, advancements in treatment, and case studies related to metabolic diseases. The conference draws clinicians, scientists, and healthcare providers from across the UK and beyond.

All bookings are made via the website, in real time, which will allow you to choose your stand number at the time of agreement. The stand sizes are based on the supporter packages.

Please contact us to discuss any of the opportunities listed in this document or if you would like to discuss any other bespoke packages.

For further information please visit the Conference website:

[www.bimdgconference.co.uk](http://www.bimdgconference.co.uk)

Managed and payment processed by:

KC Jones conference&events

1 Duffield Road, Little Eaton, Derby, DE21 5DR

Or contact the team on: 01332 947072

e: [bimdg@kc-jones.co.uk](mailto:bimdg@kc-jones.co.uk)

[www.bimdgconference.co.uk](http://www.bimdgconference.co.uk)