



Annual Scientific Meeting

DoubleTree by Hilton Brighton Metropole

Sunday 9 - Tuesday 11 November 2025

Supporter &
Exhibitor Pack

About BSBR

The British Society of Breast Radiology (BSBR) is a specialist organisation for medical professionals, consultant radiographers and advanced radiographic practitioners with an interest in breast imaging.

The aim of the BSBR is to foster interest in breast imaging, to support education of breast imaging professionals and to promote research. It also has a role in developing national guidance and providing advice on professional matters such as workforce planning.

The Breast Group of the Royal College of Radiologists was founded in 1988 and in 2014 the Group became the British Society of Breast Radiology (BSBR).

The BSBR:

- Provides a forum for discussion of radiological matters relating to breast disease and breast screening, arranging its own annual scientific meeting specifically for this purpose
- Supports local and national initiatives for research into breast imaging and related topics
- Acts as an authoritative source of advice to the Royal College of Radiologists and the Department of Health on issues such as professional standards and training requirements relating to breast imaging
- Maintains close liaison with other professional groups with interests in breast disease, related diagnostic practices and other associated activities

Key Facts & Figures

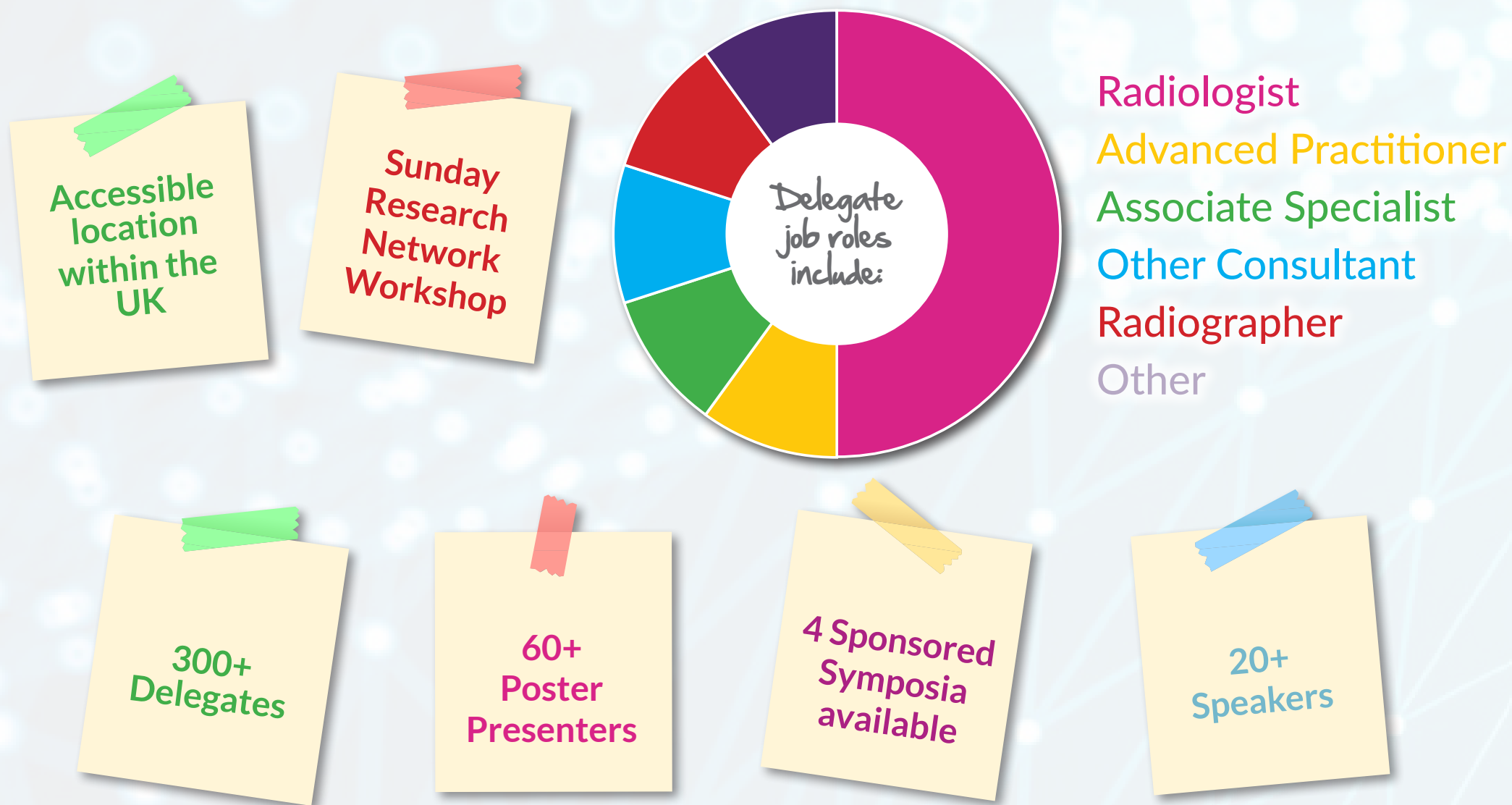

Reasons to invest in BSBR ASM

- An exciting programme with a wide range of topics which will attract a broad spectrum of delegates
- A series of dedicated networking opportunities, as well as two social events
- Introduce new or improved materials to a well-engaged audience
- Use the event as a platform to launch/showcase new technology
- Build on and strengthen existing relationships. Unmissable opportunity to contribute to the healthcare debate
- Increase your company profile and product to your target audience
- Access to delegates before, during, and after the conference

Key Points:

- Practical 'how to...' sessions
- Real life case presentations
- Tips and tricks
- Renowned international radiologist speakers
- Unrivalled networking opportunities with delegates

Platinum Plus Conference Symposium Supporter Package

(One available)
£7,500+VAT

Includes:

- 45 minute Symposium Sponsorship within the main Conference programme to ALL delegates
- Spoken acknowledgment from BSBR Chair in his welcome address
- Exhibition space: 5x2m**
- 5 x Exhibition stand passes
- Your logo on the delegate badge
- Your logo added on to all pre and post event marketing material (including delegate emails)
- Access to delegates before, during, and after the conference
- 1 x Conference App push notification to be sent to all delegates on the day of your symposia
- Digital advert on the Conference App homepage
- Company logo on every page of the conference website with hyperlink to own website (250 words)
- Branding on Conference slides showing supporters logo
- 25% discount on all additional support opportunities

*Symposia content

Support of a symposium will allow companies to present a scientific programme relevant to the main theme of the conference. This is subject to the programme being acceptable to the Organising Committee, who will be happy to advise on the structure of the symposium programme and, ideally will involve Case Studies / Radiologists within their presentation.

This package Symposium will be in the main Programme for all delegates to attend.

**Package includes 2 x tables, 5 x chairs and electricity

For your symposium the package includes:

- Hire of conference stage set with your company branding
- Hire of audio visual equipment and technician
- Staff x 2 to assist i.e. with distribution of material and roving microphones during the symposium

Please note all content of symposia, adverts and push notifications are subject to approval of the BSBR Organising Committee.

Platinum Lunchtime Symposium Supporter Package

(Two available)
£5,500+VAT

Includes:

- 45 minute lunchtime Symposium Sponsorship*
- Spoken acknowledgment from BSBR Chair in his welcome address
- Exhibition space: 5x2m**
- 4 x Exhibition stand passes
- Your logo on the delegate badge
- Your logo added on to all pre and post event marketing material (including delegate emails)
- Access to delegates before, during, and after the conference
- 1 x Conference App push notification to be sent to all delegates on the day of your symposia
- Digital advert on the Conference App homepage
- Company logo on every page of the conference website with hyperlink to own website (250 words)
- Branding on Conference slides showing supporters logo
- 25% discount on all additional support opportunities

*Symposia content

Support of a symposium will allow companies to present a scientific programme relevant to the main theme of the conference. This is subject to the programme being acceptable to the Organising Committee, who will be happy to advise on the structure of the symposium programme and, ideally will involve Case Studies / Radiologists within their presentation.

This package Symposium will take place on either Monday or Tuesday lunchtime.

**Package includes 2 x tables, 4 x chairs and electricity

For your symposium the package includes:

- Hire of conference stage set with your company branding
- Hire of audio visual equipment and technician
- Staff x 2 to assist i.e. with distribution of material and roving microphones during the symposium

Please note all content of symposia, adverts and push notifications are subject to approval of the BSBR Organising Committee.

Platinum Morning Symposium Supporter Package

(One available)
£5,500+VAT

Includes:

- 45 minute breakfast Symposium Sponsorship*
- Spoken acknowledgment from BSBR Chair in his welcome address
- Exhibition space: 5x2m**
- 4 x Exhibition stand passes
- Your logo on the delegate badge
- Your logo added on to all pre and post event marketing material (including delegate emails)
- Access to delegates before, during, and after the conference
- 1 x Conference App push notification to be sent to all delegates on the day of your symposia
- Digital advert on the Conference App homepage
- Company logo on every page of the conference website with hyperlink to own website (250 words)
- Branding on Conference slides showing supporters logo
- 25% discount on all additional support opportunities

*Symposia content

Support of a symposium will allow companies to present a scientific programme relevant to the main theme of the conference. This is subject to the programme being acceptable to the Organising Committee, who will be happy to advise on the structure of the symposium programme and, ideally will involve Case Studies / Radiologists within their presentation.

This package Symposium will take place on either Monday or Tuesday morning.

**Package includes 2 x tables, 4 x chairs and electricity

For your symposium the package includes:

- Hire of conference stage set with your company branding
- Hire of audio visual equipment and technician
- Staff x 2 to assist i.e. with distribution of material and roving microphones during the symposium

Please note all content of symposia, adverts and push notifications are subject to approval of the BSBR Organising Committee.

Supporter Opportunities

Gold Supporter Package

£4,000+VAT

Includes:

- Exhibition space: 4x2m**
- 3 x Exhibition stand passes
- Access to delegates before, during, and after the conference
- Digital advert on the Conference App
- 1 x Conference App push notification
- Company logo on the conference website with hyperlink to own website (150 words)
- 20% discount on all additional supporter opportunities

Silver Supporter Package

£3,000+VAT

Includes:

- Exhibition space: 3x2m**
- 3 x Exhibition stand passes
- Access to delegates before, during, and after the conference
- Acknowledgment on the Conference App
- Company logo on the conference website with hyperlink to own website (150 words)
- 10% discount on all additional supporter opportunities

Bronze Supporter Package

£2,000+VAT

Includes:

- Exhibition space: 2x2m**
- 2 x Exhibition stand passes (worth £150+VAT each)
- Access to delegates before, during, and after the conference
- Acknowledgment on the Conference App
- Company logo on the conference website with hyperlink to own website (150 words)

**Package includes 1 x table, chairs per exhibitor and electricity.

New for 2025 - Workshops

We are thrilled to announce that this year, we're offering a series of engaging workshop sessions designed to help you connect with more delegates in an interactive, hands-on environment. You'll have the opportunity to showcase your equipment during these sessions, carefully tailored to help the delegates discover its potential with expert guidance directly from you.

Additionally, your logo will be prominently displayed on a giant deckchair in the exhibition area, providing excellent visibility for your brand. This offers a unique opportunity for your logo to be shared across social media as delegates capture and post photos, extending your reach even further.

The additional cost to add this to your package will be £1000+VAT. This can be shared between two exhibitors if you would like to host a combined session.

Limited to 4 companies / collaborations.



Deckchair to be branded with the logos of all exhibitors booking the workshops.

Additional Supporter Items

Conference Drinks Reception & Dinner Support includes your banners stands displayed at the i360 along with a short spoken welcome to the attendees. Including 4 dinner tickets. (limited to one)	£1,250+VAT
Delegate Lanyard only Branded lanyards with your logo and BSBR (limited to one)	£1,000+VAT
Digital advert on the Conference App	£1,000+VAT
Push notification to all delegates on the Conference App	£500+VAT
Scrolling Banner on the Conference App	£500+VAT
Push Notification & Scrolling Banner to all delegates on the Conference App	£900+VAT
Website listing ; your company logo on the conference website with hyperlink to own website (150 words)	£250+VAT

Promotional Items



Delegate Bags
£750+VAT
1 colour printed logo



A5 Soft Feel Notebook
£1,250+VAT
1 colour printed logo



Frosted Magenta Pen
£350+VAT
1 colour printed logo



Delegate Bag Inserts
£250+VAT
Supplied by sponsor

Please note: Items will be given out at registration if no-one purchases the delegate bag option.

Exhibition Floor Plan

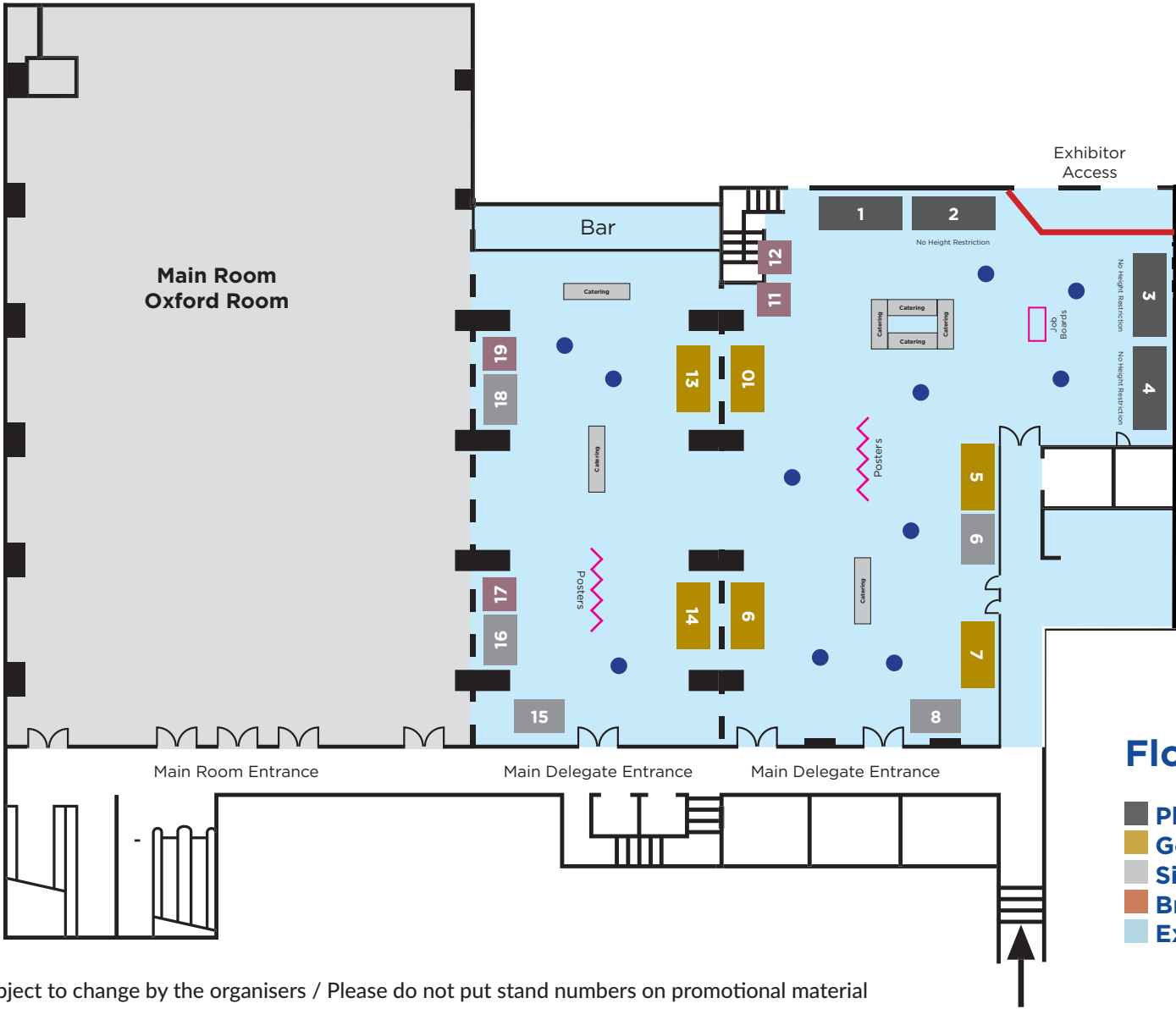

Height Restriction
All stands have a 2.8m height restriction apart from stands 2, 3 & 4.

- Floor Plan Key**
- Platinum Stand - 5m x 2m
 - Gold Stand - 4m x 2m
 - Silver Stand - 3m x 2m
 - Bronze Stand - 2m x 2m
 - Exhibition

This plan is subject to change by the organisers / Please do not put stand numbers on promotional material



DoubleTree by Hilton Brighton Metropole
Kings Road, Brighton and Hove,
Brighton, BN1 2FU



Exhibitor Information

BSBR Conference will take place on Monday 10 and Tuesday 11 November 2025 at DoubleTree by Hilton Brighton Metropole.

Catering will be located within the exhibition areas, to ensure maximum contact between exhibitors and delegates.

The Research Workshop will take place on Sunday 9 November 2025.

The Conference Dinner will be held on Monday 10 November at the i360. Guests will begin the evening with a drinks reception followed by dinner.

This is a ticketed event.

Date	Time	Exhibition
Sunday 9 November 2025	11:00 -17:00	Exhibition build
Monday 10 November 2025	08:00 -18:00	Exhibition open
Tuesday 11 November 2025	08:00 -14:00	Exhibition open
Tuesday 11 November 2025	16:30 -20:00	Exhibition breakdown
Please note the breakdown of stands is not permitted until after 16:30. Stand collateral can be packaged from 15:00 but not moved until after the delegates have departed.		

The DoubleTree by Hilton Brighton Metropole

Overlooking the Brighton seafront, our historic hotel with modern interiors, built in 1890, is a short walk from The Brighton Centre. Brighton Palace Pier, the Royal Pavilion, and the boutiques and bars of The Lanes are all within a half-mile. Enjoy our on-site health club, offering an indoor pool, sauna, and steam room.



Gatwick Airport to Brighton by train is around 30 minutes
Heathrow Airport to Brighton by train is around 2 hours



Driving to Brighton & Hove is simple with the A27 connecting the city to the East & the West and the M23 / A23 linking Brighton to the capital. We do however suggest travelling by train and parking is restricted in the city.



London St Pancras International - Direct train 1 hour 20 minutes

London Victoria - Direct train 50 minutes

London Bridge - Direct train 1 hour

Brighton Station is 0.5 miles from the venue, an approx 7-10 minute walk

Exit the station on Queens Road and walk straight down past the Clock Tower, as far as you can without going into the sea! Turn right onto the King's Road and we are 1 minute along the seafront!



Annual Scientific Meeting

DoubleTree by Hilton Brighton Metropole

Sunday 9 - Tuesday 11 November 2025

We do hope you can join us

The British Society of Breast Radiology provides a forum for discussion of radiological matters relating to breast disease and breast screening. The conference supports local and national initiatives for research into breast imaging and related topics.

All bookings are made via the website, in real time, which will allow you to choose your stand number at the time of agreement. The stand sizes are based on the supporter packages, Platinum, Gold, Silver and Bronze.

Please contact us to discuss any of the opportunities listed in this document or if you would like to discuss any other bespoke packages.

For further information please visit the Conference website: www.bsbrevents.org

KC Jones conference&events
1 Duffield Road, Little Eaton, Derby, DE21 5DR

Or contact the team on: 01332 227773
e: bsbr@kc-jones.co.uk