



NASDAP 2025

Te rangapū ā motu mō ngā Tumuaki tuarua

Tākina, Wellington | 30 July - 1 August 2025

**Leadership resilience in times
of complexity & change**

Conference Programme 2025

TUESDAY 29 JULY

3.00 - 5.00pm	PLD workshop for New Deputy & Assistant Principals (Level 1, Tākina Wellington Convention & Exhibition Centre) RSVP only.	Room: Matiu (L1)
5.30 - 7.30pm	Meet & Greet @ Shed 22 (former Mac's Brewbar), 4 Taranaki Street <i>This is an informal meet up giving you a chance to catch up with friends and colleagues. Casual, no formal programme. A complimentary drink ticket and some shared platters will be on offer. Order additional kai and beverages direct as it suits you. Name badge pick-up also available.</i>	<i>Shed22, 4 Taranaki Street</i>



PROGRAMME 2025

WEDNESDAY 30 JULY							
9.00am	Registration & Exhibition opens Tākina (Level 1, Tākina Wellington Convention & Exhibition Centre)						
9.45 - 10.40am	Mihi Whakatau Kura Moeahu & Dr Alishia Moeaha (Te Rūnanganui o Te Āti Awa) Welcome from MC Mirama Kamo & NASDAP <i>2025 Event Partner introduction - Commbbox</i>						Room: Rongomātāne (L1)
10.40 - 11.40am	Keynote: Dr Linda Bendikson <i>Waves against rocks in the sea - leadership resiliency in times of complexity and change</i>						Room: Rongomātāne (L1)
11.40 - 12.40pm	Lunch in the Exhibition Area						
Rooms	Rongomātāne (L1)	Mākaro (L1)	Mokopuna (L1)	Matiu (L1)	Whātaïtai (L2)	Tāwhirimātea C (L2)	Tāwhirimātea E (L2)
12.40 - 1.40pm Workshops Session 1	Pedagogical Quick Wins Linda Bendikson (LB Schooling Improvement)	Strengths-based Leadership in Action Rob Clarke (Learning Architects)	AI in Schools: The Good, The Bad, and the Ugly Danielle Vandendungen (Ministry of Education)	Poutama Reo - A Māori language movement for your school Brianne Te Paa, Kaia Morehu & Students (Kaipara College)	Meaningful Mentoring: Guidelines for practice Adele Scott, Hayley Corney & Joseph Durkin-Gorman (PPTA Te Wehengarua)	Navigating Belonging, Growth, and Connection in a Disconnected World Lawrence Naicker & Chris Sullivan (Sancta Maria College)	Implementing effective financial education in a changing landscape Yasmin Frazer & Erin Thompson (Sorted in Schools - Retirement Commission)
1.40 - 1.50pm	Transition						
1.50 - 2.50pm Workshops Session 2	Vocational Education programmes as part of the curriculum Craig Dyason (Albany Senior High School)	Activating Niho Taniwha to improve teaching and learning for ākonga Māori at Pukekohe High School Renée Neville & Suzanne Powar (Evaluation Associates)	Woke Stuff like Wellbeing & Belonging Jane Townsend (Putāruru College)	Discover, Play & Transform with the CommBox S5! Natalie Tubman (Commbbox)	Stepping up: Navigating Leadership as a new Deputy Principal Gus Shirley & Rowan Taigel (Waimea College & Nayland College)	AI-Powered Leadership: Reclaim Your Time Bex Rose & Sam Gibson (Ai Surge & Noel Leeming Commercial)	Teacher Learning Communities - A Journey Through Improvement Stephanie Harford (Rototuna Senior High School)
2.50 - 3.20pm	Afternoon kai in the Exhibition Area						
3.20 - 4.00pm	Panel Discussion - Mentoring and Coaching: Building capability in ourselves and others Chair: Kate Thornton (Victoria University of Wellington) Panellists: Chris Matthews (Papakura High School); Rachel Peak (Rosmini College) & Pip Woodward (Ōtūmoetai College) <i>Supported by Victoria University of Wellington</i>						Room: Rongomātāne (L1)
4.00 - 5.00pm	Keynote: Prof Deidre Le Fevre <i>Courageous leadership in complex times</i>						Room: Rongomātāne (L1)
5.00 - 6.30pm	Networking Reception Hosted in the exhibition area, join your colleagues and exhibitors for canapes, beverages, and great conversation.						Exhibition Area



PROGRAMME 2025

THURSDAY 31 JULY

8.00am	Informal coffee and networking time - Exhibition & Registration open - arrival tea/coffee plus coffee carts will be open!						
9.00 - 10.00am	Keynote: Dr Nina Hood <i>Unpacking the Science of Learning</i>						Room: Rongomātāne (L1)
10 - 10.20am	NASDAP AGM						Room: Rongomātāne (L1)
10.20 - 11.00am	Morning kai in exhibition area						
Rooms	Rongomātāne (L1)	Mākaro (L1)	Mokopuna (L1)	Matiu (L1)	Whātaïtai (L2)	Tāwhirimātea C (L2)	Tāwhirimātea E (L2)
11.00am - 12.00pm Workshops Session 3	The Science of Learning in the classroom Nina Hood (The Education Hub/ The Teachers' Institute)	Growing Leadership– Mentoring and Coaching in Secondary School in Aotearoa Pip Woodward & Kate Thornton (Ōtūmoetai College & Victoria University of Wellington)	From Data to Dialogue – Leading Attendance Change Through Kōrero and Whānau partnership Philippa Wintle (Albany Senior High School)	Mahi Tahi - A research informed approach to lesson observation James Heneghan & Lauren Wing (Long Bay College)	Senior Leaders as Employers – The fundamentals of effective employment relationships James Morris & Kathleen Kaveney (PPTA Te Wehengarua)	Adaptive Leadership in Action: Strategies for Navigating Complexity with Curiosity and Courage Deidre Le Fevre (University of Auckland)	Beyond the Headlines: The Reality of Leading a New School Naomi Bates, Toni Brewer, Samantha Farook & Elsie Leslie (Mangakōtukutuku College)
12.00pm	Lunch in exhibition area						
1.00 - 2.00pm Workshops Session 4	Individual and organisational stress and burnout - Management and prevention Ian Harper (STEM NZ)	Leading the use of data to inform teacher learning Hamish Chalmers (Albany Senior High School)	Introduction to Leading by Learning: Practical applications for your important conversations Karen Spencer & Ben Laybourn (Evaluation Associates)	Making use of the strengths of junior secondary Gwyneth Cooper (Lytton High School)	Professional supervision for educational leadership – what is it, why bother, and how to make it worth your while? Rachel Hawthorne (Transforming Conversations)	Pathways to secondary school principalship – enablers and challenges Craig Morrison, Meredith Raukura & Kate Thornton (Wakatipu College, One Tree Hill College & Victoria University of Wellington)	Leading Learning and Change: How Cashmere High School Introduced Financial Education Across Year Levels Kellie Fenemor & Matt Benassi (Cashmere High School & Banquer)
2.00 - 2.10pm	Transition						
2.10 - 3.10pm Workshops Session 5	Leading with confidence, safety and care in the age of generative AI Sean Lyons (Netsafe)	Learning to Learn Tonia Calverley (Dilworth School)	Strategic leadership in the careers system Nina Ive (Tertiary Education Commission)	Leading What Matters: Building Capability and Culture Across Your Teams Karen Stimson & Libby Waddel (Rototuna Senior High School)	Leading Culturally Responsive Relational Pedagogies in your kura with Kaha and Mana Huia Toia-coll (Whangārei Boys' High School)	Google for Education: What do I need to know as a leader and what's new in the tools? Steve Smith (Google for Education)	Wisdom from two worlds - Building deep resilience for climate change Rachel Bolstad & Steve Katene (NZCER & Heretaunga Intermediate)
3.10pm	Afternoon kai in exhibition area						



PROGRAMME 2025

Rooms	Rongomātāne (L1)	Mākaro (L1)	Mokopuna (L1)	Matiu (L1)	Whāitaitai (L2)	Tāwhirimātea C (L2)	Tāwhirimātea E (L2)
3.40 - 4.40pm Workshops Session 6	Ensuring all students pathway into Level 2 - helping all students be the best version of themselves, with a qualification! Karen Dobric, Liz Carrick & Esther Williams (Papatoetoe High School, Ashburton College & Pukekohe High School)	Connecting the elements in a Professional Growth Cycle; recognising naturally occurring evidence in the Standards for the Teaching Profession Kim Bonnington (Teaching Council)	A Message to Our Past Selves - What We've Learned in Leading Change and Where to From Here Alyssa Johnstone & Alicia Harrison (Central Southland College)	From Reflection to Impact: How Video and AI are Shaping the Future of Teacher Learning Melissa Campbell & Christophe Mullings (Rangi Ruru Girls' School & Iris connect)	'Finger on the Pulse' - Leading an observable culture that supports student wellbeing Andrew Sylvester (Linewize)	Beyond Ratios: Building Leadership Resilience in EOTC Risk Management Fiona McDonald (Education Outdoors NZ)	Support Personal and Professional Health and Wellbeing in Complex Learning Environments Cale Begley (Team Teach)
7.00 - 11.45pm	NASDAP Gala Dinner (RSVP Required) Guest Speaker: Abbas Nazari ...and a live band following dessert!						

FRIDAY 1 AUGUST

8.30am	Light breakfast & Networking time - Exhibition & Registration open						
Rooms	Rongomātāne (L1)	Mākaro (L1)	Mokopuna (L1)	Matiu (L1)	Whāitaitai (L2)	Tāwhirimātea C (L2)	Tāwhirimātea E (L2)
9.00 - 10.00pm Workshops Session 7	The important information that I want to leave behind Margaret Ross (Ross Communication)	What’s love got to do with it - The secret to leadership well being John Peachey (The Think Farm)	Finding our way to Flourishing Richard van Dam (Dilworth School)	Change and resistance: Effective practices for leaders Amira Aman (Leadership Development)	A Pastoral Care Journey – From Reaction to Proactive Support Gail Colliar (Whangaparāoa)	Artificial Intelligence Framework for Education in Aotearoa, New Zealand Andrew Churches (Digital Technology Teacher Aotearoa)	Leading the Way Forward: Embracing a New Student Management System for School Success Grace Copeland (Helix)
10.00 - 10.10pm	Transition						
10.10 - 11.10pm Workshops Session 8	Smart Tools at School for making everyday tasks digital and easy! Sheldon Lendrum & Chris Lambdin (Inbox Design Limited)	Investigatingmisconduct/ complaints - tips for a fair investigation process Bindy Tatham (Professional Insight)	Seeing Clearly: Leading with Courage and Clarity in Assessment and Data Practices Melissa Denzler (Rangahau Mātauranga o Aotearoa – NZCER)	Building System Capability through Learning Walks Alana Madgwick & William Madgwick (Educatalysts)	Tahatu Career Navigator: Making strategic careers system leadership relevant for all New Zealanders Nina Ive (Tertiary Education Commission)	AI for School Leadership in New Zealand Tony Gilbert (New Era Technology)	Hacked in 30 minutes - Leading through the chaos of a cyber-attack Andrew Hood (Network for Learning)
11.10 - 12.00pm	Lunch in the Exhibition Area						
12.00 - 1.00pm	Keynote: Hoturoa Barclay-Kerr <i>Waka as a Symbol of Mana in the 21st Century</i>						Room: Rongomātāne (L1)
1.00 - 1.15pm	Conference Closing						Room: Rongomātāne (L1)



Event Partner



CommBox

CommBox understands the challenges that educators face when it comes to teaching in today's modern classrooms. That's why we have designed our interactive and non-interactive screens with education in mind, providing a simple and engaging way to present, collaborate, inform, and manage your classroom.

Major Sponsors



Banqer

Banqer is the leader in classroom-based financial education, with innovative tools to make it easy for teachers to deliver impactful, engaging learning experiences. Through real-world financial simulations, Banqer empowers students to thrive financially and reach their full potential beyond the classroom.



Netsafe

Netsafe is New Zealand's leading online safety Not-for-Profit, with a 25-year history supporting schools to develop their approach to online safety and digital citizenship. Our 7-day a week confidential helpline supports schools through online incident management and our harm prevention products and services are increasingly delivered flexibly online.



Evaluation Associates Ltd

At Evaluation Associates | Te Huinga Kākākura Mātauranga, we know what keeps educators up at night — making sure every ākonga gets a great deal. That means putting effective teachers in front of them, building strong leadership, and achieving equitable outcomes. We work with schools and kura to strengthen pedagogical practice, grow leadership capability, refine school-wide systems, and build cultural capability.



Network for Learning

Network for Learning is a crown-owned company, providing fully funded, faster, safer internet to more than 2,500 schools and kura and 900,000 tumuaki, kaiako and ākonga across Aotearoa. Our safety and security solutions, including web filtering, firewalls, DDoS protection, email security, segmented networks, and cybersecurity services, help schools keep ākonga safer online.



FACTS

With over 35 years of experience, FACTS partners with 12K+ schools and 3M families globally, delivering innovative education technology. Our School Management platform streamlines student and family management with a flexible API library for tailored ecosystems.



Sorted in Schools - Retirement Commission

The Retirement Commission operates Sorted.org.nz and Sorted in Schools, reaching over 80% of New Zealand secondary schools since 2018. It also leads the National Strategy for Financial Capability, bringing together 1000+ partners from the financial sector to improve the financial wellbeing of New Zealanders, the latest strategy having a strong focus young people.



Google For Education

Google for Education tools work together to transform teaching and learning so every student and educator can pursue their personal potential.



PPTA Te Wehengarua

PPTA Te Wehengarua is the professional association and union of teachers and principals committed to improving secondary education for New Zealand students. We welcome principals and senior leaders as members of the PPTA and offer support and practical advice.



Linewize

We help schools protect students and support their wellbeing in an increasingly online world. Our solutions empower every member of the school community to take an active role in safeguarding children online. By providing insights into what's happening to and for their students, we enable educators and parents to better understand and address the challenges our tamariki face.

Associate Sponsors



EATucation

EATucation is a Social Enterprise founded by a Michelin-Trained chef and Hospitality/Food Technology teacher. Our ready-made resources and NZQA assessments save schools money, give teachers the gift of time, and improve learning outcomes!



Education Perfect

The Education Perfect Group is the leading Australia and New Zealand group of EdTech companies. Combining Education Perfect, Essential Assessment and EdPotential, the Education Perfect Group serves more than 5,250 primary and secondary schools and 2.2 million enrolled students worldwide.



Learning Spaces Global

At LSG, we're a Kiwi-owned company based in Nelson, creating school furniture that brings out the best in every space—and everyone in it. We work with primary and secondary leaders to reimagine classrooms, libraries, staffrooms, and breakout areas using premium birch plywood.



New Era Technology

Partnering with schools across New Zealand to deliver tailored IT solutions that enhance learning and streamline operations. From secure cloud services and cyber security to managed IT and classroom collaboration tools, we help schools create future-ready digital environments.



Officemax

OfficeMax is New Zealand's leading education solutions provider, with tens of thousands of products available – from educational tools and classroom furniture, to cleaning essentials and technology, we've got everything you need to build an innovative learning environment.



PhotoLife

PhotoLife is New Zealand's leading school photography company as we combine a unique understanding of school environments through three previous teachers across three generations and a dedicated team with a passion for school photography.



tes

Tes powers schools and enables great teaching worldwide, by creating intelligent online products and services to make the greatest difference in education. Tes is an international provider of software services to make life easier for schools and teachers.

Supporting Sponsor



Rotorua Education Network

Offering tailored experiences for schools travelling to Rotorua and throughout New Zealand. We provide a range of services to make school trips as smooth and stress-free as possible, including; customised itineraries tailored to your specific requirement, accommodation options to suit all budgets and group sizes, transport options, expert advice and support from our team of experienced professionals.



www.hauoraotearoa.com

5 WEEK PROGRAMME

For ākonga to learn about **Te Whare Tapa Whā** and how to use this model as a practical mental health wellbeing tool.

 **25-30 Students**
1 Champion kaiako

 **5 sessions**
90 - 120min

\$3,000 +GST

15 WEEK PROGRAMME

For Year 11 -13 ākonga to deepen their understanding of **Te Whare Tapa Whā** and use this model as a practical mental health wellbeing tool. Working towards **15 NCEA credits (L3)** with visits to a local ECE.

Whanaungatanga | Manaakitanga | Pūkengatanga

 **25-30 Students**
1 Champion kaiako

 **15 sessions**
90 - 120min

\$5,000 +GST



KIA ORA PAI
Live well



KIA AKO PAI
Learn well



KIA RANGATIRA PAI
Lead well

APPLY NOW!

Contact Jerreau

Kaitakawaenga - Schools coordinator

jerreau@hauoraotearoa.com

Tākina, Level 1 - Exhibition, Catering, Plenary & Breakouts

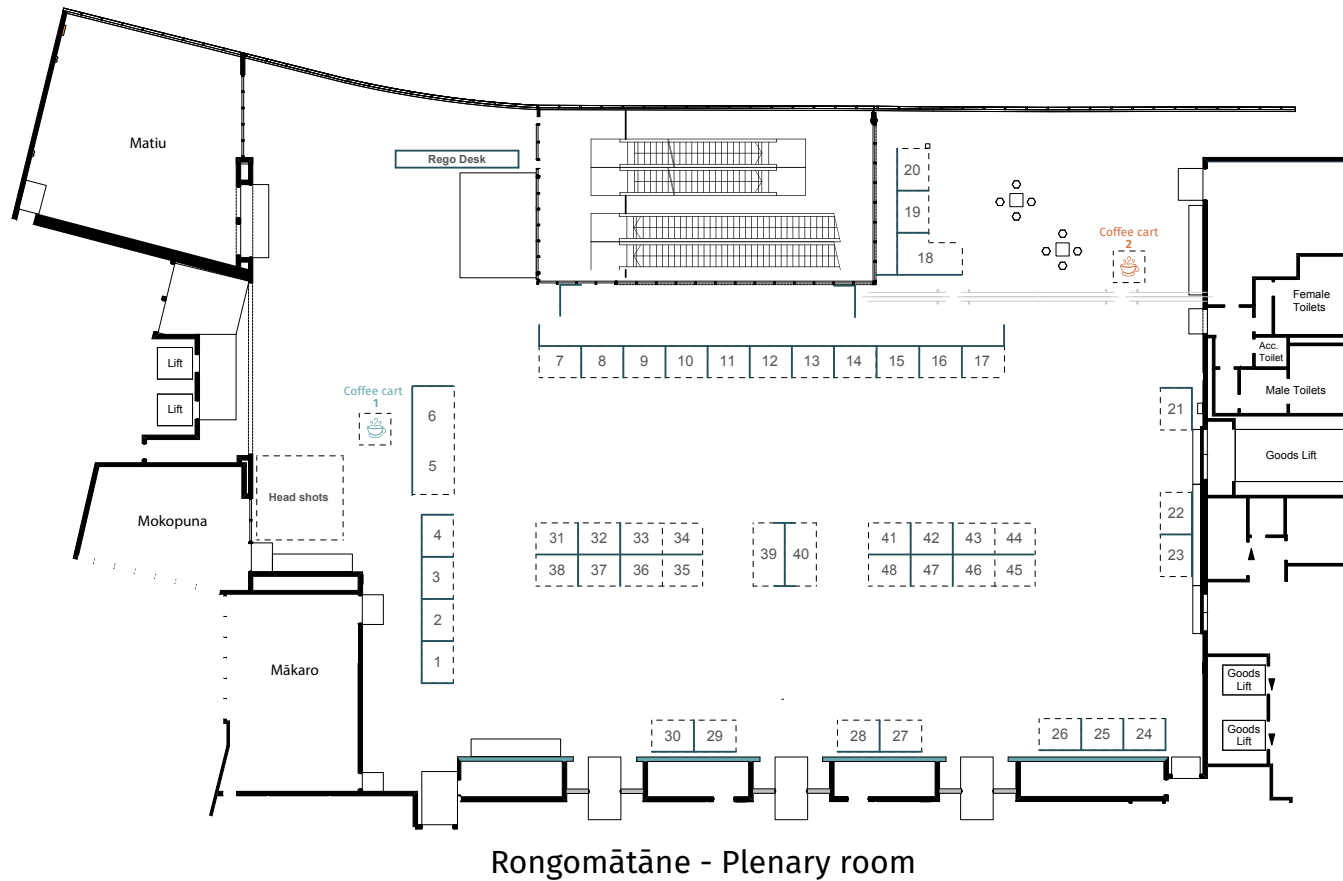

Arena Commercial	33	National Library	25
Banquer	44	Netsafe	08
class* Furniture	01 & 02	Network for Learning	34
Coach for Life	46	New Era Technology	40
CommBox	05 & 06	NZ Esports	04
Crisis Prevention Institute	11	NZ KNIT	29
Defining Moments	36	NZCER	43
EATucation	17	Officemax	27
Education Perfect	47	PB Tech	16
Evaluation Associates	07	PhotoLife	Head shots
FACTS	41	PPTA Te Wehengarua	31
Gonogo	14	Rotorua Education Network	35
Google for Education	21	Sebel	45
Helix	39	Skool Loop	18
Inbox Design Limited	28	Sorted in Schools	Coffee Cart 2
Instant Education Solutions Limited	37	Soul Learning®	19
Interlead	12	Te Tari Pūreke	03
Iris Connect NZ	20	Tertiary Education Commission	30
Komodo Wellbeing	22	Tes	32
Launchpad	10	The Learning Place	23
Learning Spaces Global	15	Tour Time	26
Linewize	48	Uniform Group	13
Master Travel Group	38	Victoria University of Wellington	09
Museum of New Zealand	24		
Te Papa Tongarewa	24		
MyMahi	42		



Tākina, Level 2 - Breakouts

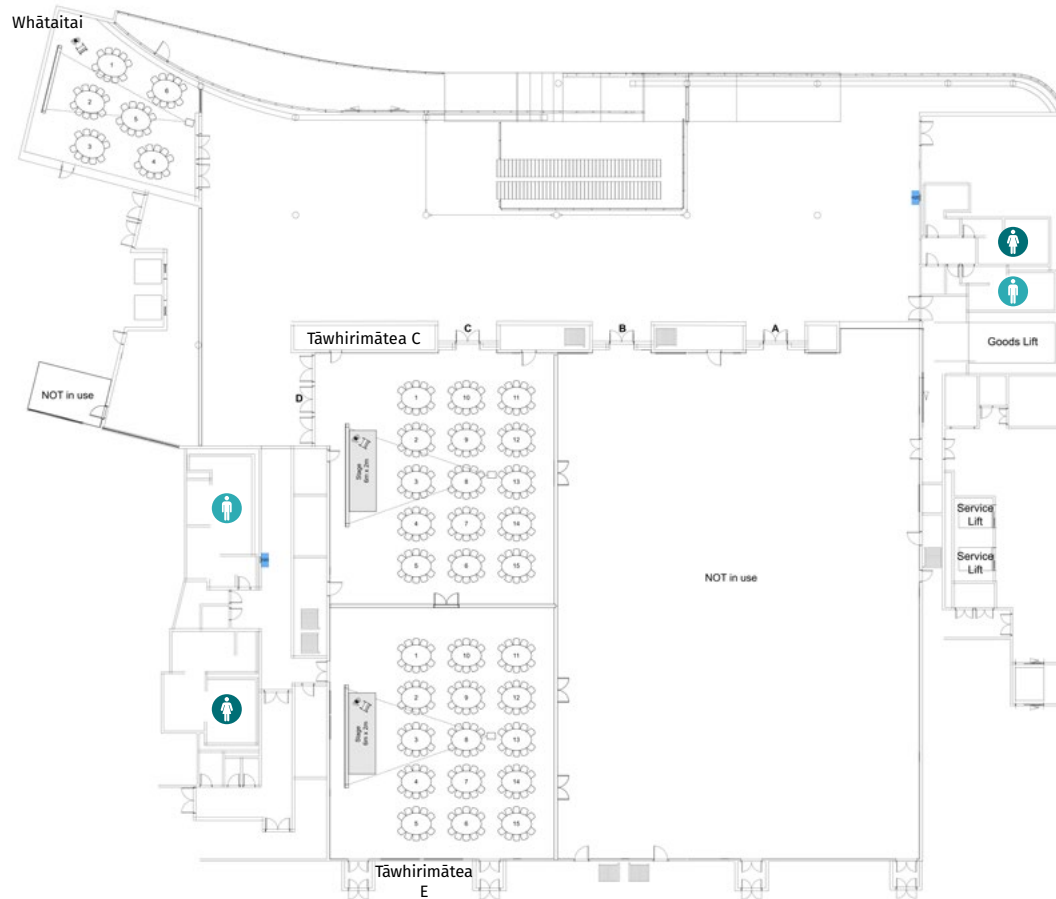

Micro-credentials for Educators

Micro-credentials, each worth 5 points, can be stacked towards postgraduate qualifications such as the Master of Secondary School Leadership (MSSL) and the Master of Education (MED) at Te Herenga Waka—Victoria University of Wellington.

**5 points + 5 points + 5 points =
Masters paper in Education**

CONTEMPORARY TEACHING APPROACHES FOR AOTEAROA

Learn about effective and inclusive pedagogical approaches to use across all levels of secondary schooling. Suitable for teachers at all levels.

SUPPORTING STUDENT SUCCESS IN MATHEMATICS LEARNING

Grow your confidence to teach fractions, decimals and percentages using approaches and strategies. Suitable for teachers at all levels from beginning to experienced.

EMPOWERING ALGEBRA TEACHING

A course to support successful, confident and effective algebra teaching. Suitable for teachers at all levels from beginning to experienced.

EFFECTIVE MENTORING PRACTICES FOR TEACHERS IN AOTEAROA NZ

Gain the skills and knowledge to become an effective mentor within a New Zealand secondary school setting. Suitable for anyone mentoring others.

WORKING COLLABORATIVELY AND BUILDING LEADERSHIP CAPABILITY

A course focussed on developing leadership capability through indigenous models of leadership for those working in secondary schools in Aotearoa. Suitable for aspiring and middle leaders.

WOMEN IN EDUCATIONAL LEADERSHIP SHORT COURSE

A leadership programme for women working within a secondary school environment who want to develop the confidence to navigate challenges and lead with impact. Suitable for SCTs, HODs, AP/DP and Principals.

SCAN TO VISIT
OUR WEBSITE



Kāpuhipuhi
Wellington Uni
Professional

A SUBSIDIARY OF

