

INTRODUCTION

The Asian Development Bank (ADB) and Bank Indonesia welcomes you to the 2023 Asian Regional Forum on Investment Management of Foreign Exchange Reserves. The event will be held on 25–27 October 2023, in Bali, Indonesia.

Participants will be presented with Indonesian hospitality at all times and shall be mesmerized by Bali’s breath- taking nature and culture.

This document provides logistical and other general information about arrangements for the event.

1. Venue

The Forum will be held at:

Conrad Bali

Jl. Pratama No.168, Tj. Benoa, Kec. Kuta Sel.,
Kabupaten Badung, Bali 80363, Indonesia

Phone: (62) 361 778788

Website: <https://www.hilton.com/en/hotels/bpncici-conrad-bali/>

25–27 October 2023

Venue: Kecak Ballroom, 1st Floor Conference Center



Conrad Hotel Floor Map:



I. South Wing	level 1: 1101-1129 level 1: 1130-1224	level 2: 2101-2129 level 2: 2130-2224	level 3: 3101-3129 level 3: 3130-3224	level 4: 4101-4129 level 4: 4130-4224	II. North Wing	level 1: 1225-1316 level 1: 1501-1515	level 2: 2225-2324 level 2: 2501-2515	level 3: 3301-3324 level 3: 3501-3515	level 4: 4301-4324 level 4: 4501-4515
III. Central Wing					IV. Conrad Suite				
					V. Conrad Pool Villa	level 1: 1601-1606			

- | | | | | |
|--|-------------------------------|--|------------------------------|-----------------------------------|
| 1. Main Entrance | 7. Water Garden | 12. East Lobby Lounge (level 3) | 18. Fitness Club (level 1) | 23. Conrad Suites Pool |
| 2. Conference Center and Group Entrance | 8. Ocean Garden | 13. Eight Degrees South Restaurant (level 1) | 17. Kura Kura Kids Club | 24. RIN Restaurant (level 1) |
| 3. Main Lobby (level 3) | 9. Infinity Chapel | 14. Spice Function Room (level 3) | 16. Beach Ball | 25. Baris Function Room (level 3) |
| 4. Kacak Ballroom and Legong Meeting Rooms | 10. Infinity Garden | 15. Azure and Azure Court | 19. Water Sports | 26. Jwa Spa Beach Bale |
| 5. Pendak Board Room (level 1) | 11. Main Pool | 16. Jwa Spa Pool (level 1) | 20. Tennis Club (level 3) | 21. Conrad Suites Entrance |
| 6. Floating Garden (level 7) | 12. Sub, Restaurant (level 1) | 16. Jwa Spa (level 3) | 21. Retail Village (level 3) | |

Meeting Area:

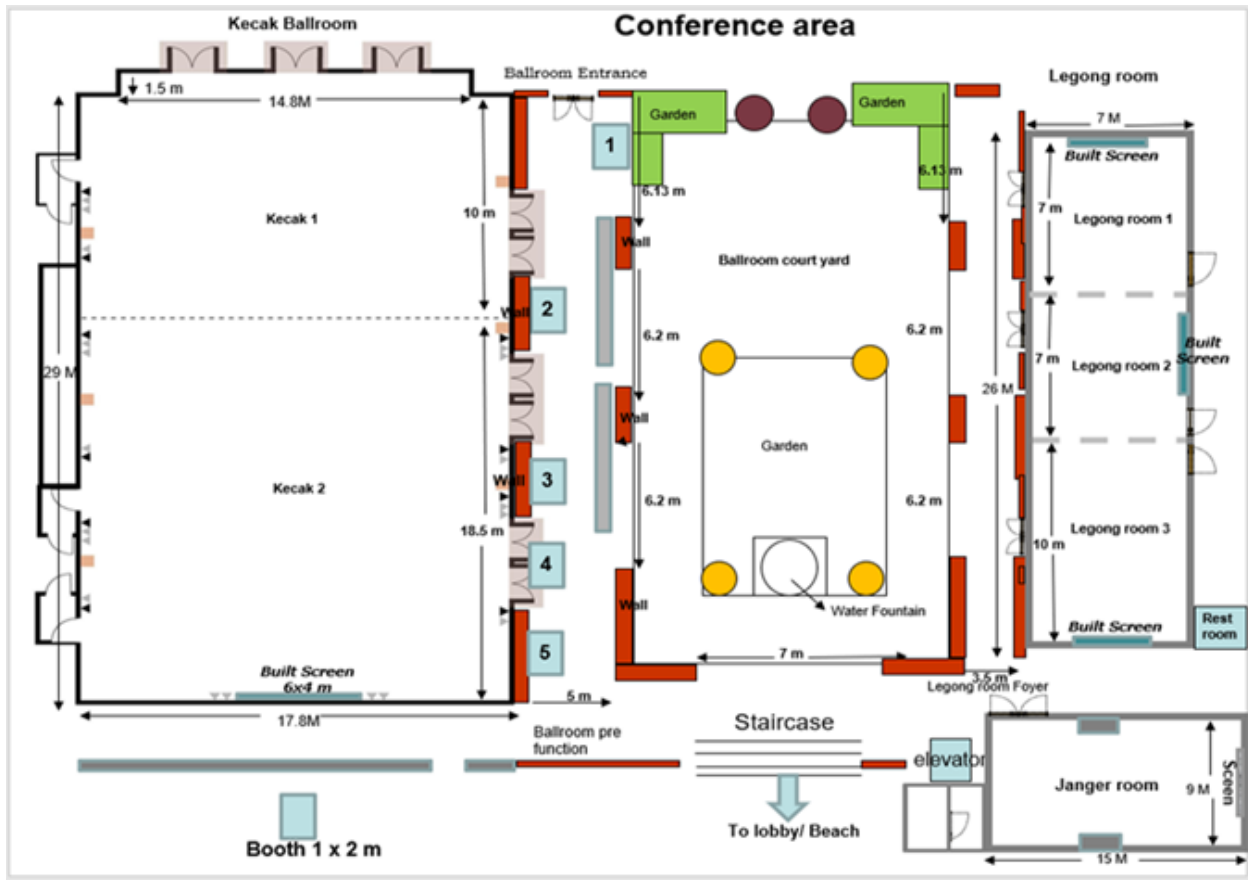

The general agenda can be found as below:

Day	Date	Time (UTC+8)	Agenda
1	Wednesday, 25 October 2023	08.30 - 09.00	Registration
		09.00 - 17.05	RM Forum Day 1: Sessions 1 - 4
		18.30 - 20.30	Welcome Dinner at Ocean Garden (Hosted by Bank Indonesia)
2	Thursday, 26 October 2023	08.30 - 09.00	Registration
		09.00 - 18.00	RM Forum Day 2: Session 5 - 9

3	Friday, 27 October 2023	08.30 - 09.00	Registration
		09.00 - 12.00	RM Forum Day 3: Session 10 - 11
		12.00	Lunch

2. Accommodation

Participants will be billeted at Conrad Bali Hotel.

ADB will shoulder the cost of the room accommodation for the duration of the Forum. Room accommodation is inclusive of (i) Buffet Breakfast for 2 pax at Suku Restaurant, which opens at 7:00 am; and (ii) wireless internet access.

Any incidental charges (i.e., laundry, mini bar, international calls, room service, extended stay, additional guest room accommodation cost and meals etc.) will be charged to the participant's personal account. Upon check-out, participants are expected to settle all personal accounts directly with the Hotel.

3. Visa Information

To obtain information about the visa process, please refer to the attached visa information note. Procedures for visa application may vary from country to country so we suggest checking all the information needed.

The committee will provide accreditation confirmation letter for all registered participants.

4. Arrival in Bali and Access to Hotel

Participants will arrive at Ngurah Rai International Airport (Denpasar International Airport code DPS). Conrad Bali is 12.6 kilometers from the Airport. Participants may choose to take taxi, or hotel limousine pick-up (arranged by the participants). For Taxis: Ngurah Rai Airport Taxi, Grab Taxi (with Grab application), or Blue Bird Group Taxi are easily available at Ngurah Rai International Airport. Taxis in Bali are generally comfortable and safe. The journey to and from the hotel takes about 25–35 minutes, and costs approximately IDR100,000 to IDR400,000, excluding the toll road fee. Participants are encouraged to choose the most direct flight to Bali.

However, if domestic transit is necessary, delegates are encouraged to travel through Soekarno-Hatta International Airport, Jakarta (Airport code: CGK).

5. Forum Time

The Forum will be for 3 days from 25–27 October 2023 (Wednesday–Friday). The Session on Wednesday will start at 9:15 am and on Thursday and Friday, the sessions will start at 9:00 a.m.

Dress code: Smart casual business attire

6. Registration

The registration desk which is located at the ballroom foyer will be open daily from 8:30 to 9:00 am on 25–27 October 2023. Participants will be provided with an ID upon registration. Seats will be assigned.

7. Forum Presentations

To promote a more sustainable conference, ADB considered posting presentations to the forum website rather than printing copies to distribute. Participants are requested to visit the forum website ([RM_2023 \(eventsair.com\)](http://RM_2023_eventsair.com)) to download the presentations, respond to feedback form and generate the certificate of participation. Hardcopies and USBs will **not** be provided during the forum.

8. Miscellaneous Travel Allowance and Reimbursement

ADB will provide ADB-funded participants with standard per diem and a fixed lump-sum miscellaneous travel allowance to cover costs of airport transfers, airport taxes, in-city transports, terminal fees, and other incidental travel expenses during stay in Bali, Indonesia. These allowances and reimbursements shall be distributed upon review of submitted required documents. For ease of issuance of allowances and reimbursements, participants are kindly requested to prepare and submit the following documents to Mr. Desi Arvin Diaz and/or the Secretariat upon registration on **25 October 2023**:

Ø Original boarding pass (from country of origin to Denpasar leg);

Ø If applicable, participants who will request for reimbursement of airfare are kindly requested to prepare and submit the following additional documents:

- o Original purchase receipt (or **proof of air ticket payment**); and
- o Copy of e-ticket or used paper air ticket.

9. Health Protocol

All documents requirement for domestic and foreign travelers which include the obligation to download and use the SATUSEHAT application and show a COVID-19 vaccine certificate are no longer required since 21st June 2023.

However, the Government of the Republic of Indonesia recommends that all domestic and foreign travelers, people who are involved in public facilities, and people who are involved in large-scale continue to try to protect themselves personally from the transmission of Covid-19.

It is recommended to continue carrying out the COVID-19 vaccination until the second booster or fourth dose, especially for people who have a high risk of contracting COVID-19. For people who are unwell and at risk of contracting or transmitting Covid-19, it is recommended to keep their distance or avoid crowds of people to prevent transmission of Covid-19. It is recommended to keep using the SATUSEHAT application to monitor personal health.

Airlines/carriers may have different requirements to board their transport vehicle regarding PCR test.

10. Customs

Indonesian national laws govern the importation and exportation of prohibited or controlled items into or out of Indonesia, including medications.

Participants are allowed to bring medication, strictly for personal use. However, drugs containing narcotics are prohibited from entering Indonesia. Those containing psychotropic substances are restricted and must be declared. In addition, delegates must be able to present a letter from their physician and/or a copy of the original prescription stating the list of medication(s) and amount used per day. These documents are essential to prove the legality of prescribed medication, should there be questioning by the customs officer.

The government exempts some excisable goods purchased abroad for personal use from import duties, excise, and taxes for every adult on every arrival with a limited amount:

- a. 18 years old or above: 200 cigarettes, 25 cigars, or 100 grams of sliced tobacco or other tobacco products, and/ or
- b. 21 years old or above: 1 liter of alcoholic beverages

Any excess of the excisable goods will be destroyed.

Non-residents carrying cash more than USD 10,000 (or equivalent in other foreign currencies) or IDR 100,000,000 should declare to the Customs.

As additional information, currently Ngurah Rai International Airport Customs and Excise has innovated by presenting the Customs Declaration service electronically (E-CD). By accessing the cdbali.net address, you can complete the E-CD filling form starting 2 days before departure until shortly after landing before entering the Customs area.

11. Liability

Participants should make their own arrangement with respect to personal insurance since the host institution shall not be liable for personal accidents, loss, or damage of private properties.

12. Contact Persons

For any emergency assistance, please contact the following persons:

Mr. Deepak Taneja Mobile No.: +63 917 888 8232 dtaneja@adb.org

Mr. Desi Arvin Diaz Mobile No.: +63 915 005 1199 ddiaz@adb.org

Ms. Shermaine Enriquez Mobile No.: +63 942 447 4363 senriquez@adb.org

Ms. Irmayanti Mobile No.: +62 85 759 810 410 irmayanti@bi.go.id

Mr. Mathew Yose Hananta Mobile No.: +6281252352875 mathew_yose@bi.go.id

General Information

A. Bali

Bali, the island of gods, is located in the east of Java and is approximately 8 degrees south of the equator. The island is surrounded by coral reefs; the beaches are mostly white sand on the south side and black sand on the north side. Bali also boasts mountains in its central part, the highest being Mount Agung (3,031 m, 9,944 ft), known as the mother mountain of Bali.

Not only blessed with beautiful sceneries, Bali is also well known for having diverse and sophisticated cultures. Art forms such as painting, wood carving, and hand crafting thrives in the island, as well as performing arts such as Kecak and Legong dances, Rindik musical instrument, and many more.

Bali's population is around 4,3 million people, mostly adhering to Balinese Hinduism, which urges them to keep nature's balance in their lives. The majority of Bali's economy is related to the tourism industry.

B. Climate

Indonesia is a tropical country. The dry season runs from April to October and the wet season runs from November to March. The weather is warm, more often than not. The sun usually quickly returns and you can hardly even notice it has rained.

C. Time Zone

Local time in Bali is Central Indonesia Time - CIT (UTC+8).

D. Working Language and Interpretation

All meetings will be conducted in English. No interpretation services will be available.

E. International Dialing Codes

Indonesia's country code is +62, and Bali's local code is 361. Therefore, to call a local number, you can dial +62 followed by 361 and then dial the number you wish to call. Likewise, to call Indonesia's mobile number, you should dial +62

followed by the mobile number you want to contact. Participant intending to use an Indonesian SIM card can obtain from an official mobile network operator outlet to have 90-day access.

F. Electricity and Water Supply



The electricity supply voltage in Indonesia is 220 Volt with plug types C and F. The committee will provide a general adaptor only in the meeting venue. Tap water is not drinkable. Therefore, we advise the delegates to consume bottled water.

G. Currency and Banking



The currency in Indonesia is the Indonesian Rupiah (Rp). The government regulates that all transactions done in Indonesia must use Rupiah as a legal tender. Authorized money changers are available at the airport and near the meeting venue. Delegates can also withdraw Rupiah through Automated Teller Machines (ATMs), which are widely available in Bali. You can withdraw money from any ATM with the logo of your card network operator. Major credit cards are widely accepted in most hotels, restaurants, and stores.

Cashless payment options in Bali were becoming increasingly popular and widely accepted particularly in more touristy areas and establishments. Some common cashless payment methods are credit and debit cards, mobile payment applications with Quick Response Code Indonesian Standard (QRIS), also Contactless Payment Cards.

H. Wireless Internet

Free wireless internet will be available at the venue during the meeting. Access details will be provided at the information help desk.

I. Prayer Room

A prayer room will be available at the venue during the meeting. We provide limited prayer supplies for Muslims, but we suggest that each delegate to bring their own. The prayer room can be found by following the signage in the venue.

J. Photography and Videography

Participants may be filmed or photographed by the committee or photographers. In addition, photos and a short video compilation of the forum may be available on the website following the conclusion of events. Pictures may be further distributed through ADB or Bank Indonesia social media.

K. Tipping

Tipping is not mandatory in Indonesia. However, service charges might sometimes be added to the bills in restaurants ranging from Rp15.000 – Rp80.000 (approx. 1 USD – 5 USD). A 10% VAT is also applied for hotels and restaurants services in Bali.

L. Food

Balinese cuisine is generally famous for its rich use of aromatic herbs and spices, creating dishes that are flavorful and often pack a spicy punch from the generous use of chili peppers. Balinese traditional cuisine come from age-old recipes that have been passed down through generations.

The use of vegetables, coconuts, shellfish, fish, nuts, and sesame are very common in Indonesian and Balinese cuisine. Please be mindful of food allergies and restrictions including religious belief, or dietary preference. Halal food caterers are widely available in Bali, also will be provided during the forum.

For coffee enthusiasts or those who just appreciate a good cup of joe, exploring Bali's coffee culture and trying its diverse offerings can be a delightful and aromatic experience. Bali's coffee is renowned for its unique flavors and high quality. Please always protect yourself from 'Bali Belly' as well. "Bali Belly" is frequently used to describe the symptoms of food poisoning, which are accompanied by diarrhea or vomiting. Sometimes the symptoms that appear are accompanied by flatulence, loss of appetite, fever, and stomach pains. Bali's stomach issue is often caused by a virus found in contaminated food and air.

M. First Aid

An emergency medical support unit will be available at the hotel and in the meeting venue during the meeting.

The nearest hospital from the hotel and the meeting venue:

1. BIMC Hospital Nusa Dua, Kawasan ITDC Blok D, Jl. Nusa Dua, Benoa, Kec. Kuta Sel., Kabupaten Badung, Bali 80363, Indonesia, +623613000911, <http://www.bimcbali.com/bimc-siloam-nusa-dua>;
2. Rumah Sakit Umum Surya Husadha Nusa Dua, Jalan Siligita, Jl. Nusa Dua No.14, Benoa, Kec. Kuta Sel., Kabupaten Badung, Bali 80363, Indonesia, +62361775827, <http://www.suryahusadha.com>.