



HIP SOCIETY MEETING

Rutherford Hotel, Nelson

4-5 November 2023



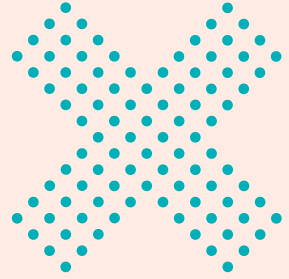

>> Kia Ora and welcome to the 2023 biannual Hip Society meeting!

We are excited you're here

We are combining with the Paediatric Society for our Saturday morning session.

For the hip programme, we have a fantastic line up of exceptional international speakers with Richard Field (London), Michael Millis (Boston), Michael Solomon (Sydney), John Timperley (Exeter) and Chris Wilson (Adelaide) to bolster our inclusive membership offering.

Be prepared for a stimulating and interactive programme covering the breadth of hip disease with something for everyone: sports, technology, infection, fractures, and revision.

We're looking forward to partnering with the Paediatric Society for our conference dinner at The Boathouse.

Enjoy!

Ramez Ailabouni

Georgina Chan

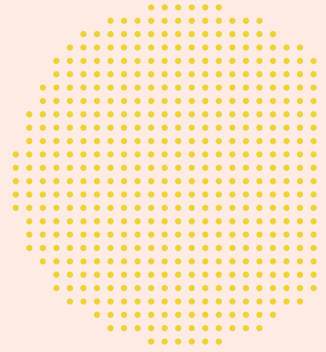

Welcome> 2

Information> 6 - 7

Guest Speakers> 8 - 9

Our Sponsors> 10 - 13

Programme.....> 14 - 16

Sports Afternoon.....> 17

Floor Plan> 18 - 19

Delegates.....> 20 - 21



>>> Our Sponsors

GOLD SPONSORS



SILVER SPONSORS



BRONZE SPONSORS



EXHIBITORS





Catering

All catering will be held in the exhibition hall (Maitai room #2) and registration area during the event.

Dinner – Combined Hip & Paediatrics Society The Boathouse | Saturday 4th November.

Transport to the combined Boathouse dinner will be provided by Bromells Coachlines, from the Rutherford Hotel, departing at 6:15pm, with the dinner commencing at 6:30pm. There will be two return transfer options at either 9:30pm or 10:30pm back to the Rutherford Hotel.

If you are joining us but have accommodation at other hotels, please either make your own way to The Boathouse, or ensure you join us by 6pm in the reception lobby of the Rutherford Hotel to catch the bus.

COVID 19

The New Zealand Government no longer requires you to be vaccinated or wear a mask at indoor events. We will not be enforcing mask wearing, however, we will have masks available, should you choose to wear them. Hand sanitiser will be provided at the registration desk. If you develop COVID symptoms, please stay home or in your hotel and contact NZOA Conference and Events Manager, Nikki Wright immediately: 027 2801131, nikki@nzoa.org.nz.

CPD Points

NZOA members can claim 4 CPD points per half day, or 12 CPD points for attendance for 1.5 days at each meeting. If you require a certificate of attendance and/or presentation of a paper, please contact Nikki post event.

Dietary Requirements

If you have indicated your dietary requirements upon registration, you will be catered for on a dedicated dietary table in the catering areas. You must have indicated you had dietary requirements when registering to be catered for. Food preferences are not considered dietary requirements and are not catered for. If you have any issues, please see Nikki or Prue.

Event Support

If you require assistance during the event, please ask Nikki or Prue on the registration desk or call/text Nikki on 027 280 1131 or Prue on 027 586 4336.

Exhibition Hall

The Exhibition Hall is located on the ground floor of the Rutherford Hotel. As you walk into the hotel, turn left, and ensure you register before entering the trades area in Maitai room #2. All catering will be situated in the exhibition hall and registration area on the ground floor during the event.

Presentations

If you have an accepted podium presentation, please ensure to load your presentation on Friday the 3rd of November, between 12pm and 4pm with the AV tech at the speaker prep desk, located in the Riwaka foyer on the ground floor of the Rutherford Hotel. If you cannot be there on Friday to load prior to the Hip meeting, you will need to do so during the morning sessions before the morning tea break. Note, you will need to bring your presentations on a USB stick for the AV tech. Once you have loaded your presentation, no changes can be made.

Programme

Please note, the first half of Saturday is a combined meeting with the Paediatric Society. This will be held in the Maitai room #1 on the ground floor. The Hip Society meeting will continue in Maitai room #1 after lunch, with the Paediatric Society heading upstairs to the Waimea room to resume their own society meeting.

Registration

Please register and collect your name badges and lanyards from the Hip Society registration on the ground floor of Rutherford Hotel. Please follow the directional signage.

Welcome Function

The industry welcome function will be held from 4:30pm – 6:30pm on Friday the 3rd of November in the trades area and ASM registration space on the ground floor of the Rutherford Hotel.

This is immediately following the end of both the Paediatric and Hip meetings.

Wi-Fi

The Wi-Fi password for the ASM is **NZOA2023**

Please select “**Rutherford Conference Wireless**” > “**Visitors**”

Then enter **NZOA2023**

Note, the password is not case sensitive.

Select “**Connect**”

Contact Details:

Nikki Wright

Conference & Events Manager

nikki@nzoa.org.nz

027 280 1131

Prue Elwood

Education & Training Manager

prue@nzoa.org.nz

027 586 4336

Rutherford Hotel:

Address: 27 Nile Street, Nelson 7010

Phone: 03 548 2299



RICHARD FIELD

London-based Prof Field comes from the highest-volume arthroplasty centre in the UK and specialises in all aspects of hip surgery including arthroscopy, preservation, primary and revision arthroplasty. Richard will be covering the ins and outs of the anterior approach with experience of over 2000 cases.



MICHAEL SOLOMON

Prof Solomon hails from Sydney, with special subspecialty interest in hip preservation and hip arthroplasty including hip resurfacing and anterior approach hip replacement.

Michael will cover tips and tricks on arthroplasty for paediatric and adolescent hip disorders and advancing technology for primary hip replacements.



MICHAEL MILLIS

Prof Millis is a world-renowned child and young adult hip preservation surgeon from Boston Children's Hospital and founding director of the Hip Preservation Unit. Michael will be covering hot topics in paediatric and adolescent preservation techniques.



JOHN TIMPERLEY

Prof Timperley is a household name in the orthopaedic world, with a wealth of experience from Exeter and now practices advances in hip arthroplasty such as using a muscle-sparing posterior approach and robotic technology. John will be sharing his experience with day-stay Arthroplasty and MAKO Hip.



CHRIS WILSON

Associate Prof Wilson from Adelaide is a primary and revision arthroplasty surgeon with keen interest in periprosthetic joint infections. He is a research director at Flinders and is heavily involved in the Arthroplasty Society of Australia and in Arthroplasty Joint Registry panels.



STUART WEINSTEIN

Dr. Weinstein is the Ignacio V. Ponseti Chair and Professor of Orthopaedic Surgery and Professor of Pediatrics at The University of Iowa. Dr. Weinstein received his A.B. Honors degree in Political Science and History from the University of Illinois in 1968. He received his medical degree (Alpha Omega Alpha) from the University of Iowa in 1972. After interning in Internal Medicine at The University of California San Francisco, he returned to the University of Iowa for a residency in Orthopaedic Surgery. In 1976 he joined the faculty of the Department of Orthopaedic Surgery at The University of Iowa.

Dr. Weinstein was an NIH funded researcher. He has published more than 270 scientific articles in peer review journals (including first author publications in NEJM, JAMA, The Lancet, Nature). His research work has focused on spinal deformity in children and the natural history and long-term outcome of pediatric musculoskeletal conditions. He has edited six major textbooks including The Pediatric Spine: Principles and Practice; Lovell and Winter's Pediatric Orthopaedics and Turek's Orthopaedics.



Robotic-Assisted Solution

Please refer to the instructions for use for a complete list of indications, contraindications, warnings, and precautions. The third-party trademarks used herein are the trademarks of their respective owners.
©DePuy Synthes 2021. All rights reserved. 161772-201204 DSUS JULY 2021
182821-210712 NZ



VELYS

Designed to improve accuracy with simplicity in mind.¹⁻²

Stop by our booth for a demonstration.



1. Doan G, Curtis P, Wyss J, Clary C. Resection Accuracy Improved during Robotic-Assisted Total Knee Arthroplasty (March 2021). Internal Report 103720852. 2. Cool CL, Jacofsky DJ, Seeger KA, Sodhi N, Mont MA. A 90-day episode-of-care cost analysis of robotic-arm assisted total knee arthroplasty. J Comp Eff Res. 2019;8(5):327-336.



Gamma4

Hip Fracture Nailing System

We aren't proven because we have a legacy.
We have a legacy because we are proven.

Redefined
nail design

Streamlined
workflow¹

Integrated
instrumentation
platform

Defined by science²

**Instrumentation
made easy**

One portfolio

References

1. Stryker EPS report: D0000205786, internal document, Stryker, Trauma & Extremities, 2022
2. Stryker VOC report: A0000377, internal document, Stryker, Trauma & Extremities, 2020

A surgeon must always rely on his or her own professional clinical judgment when deciding whether to use a particular product when treating a particular patient. Stryker does not dispense medical advice and recommends that surgeons be trained in the use of any particular product before using it in surgery. The information presented is intended to demonstrate the breadth of Stryker product offerings. A surgeon must always refer to the package insert, product label and/or instructions for use before using any Stryker product. Products may not be available in all markets because product availability is subject to the regulatory and/or medical practices in individual markets. Please contact your Stryker representative if you have questions about the availability of Stryker products in your area. Stryker Corporation or its divisions or other corporate affiliated entities own, use or have applied for the following trademarks or service marks: Gamma4, Stryker. All other trademarks are trademarks of their respective owners or holders.

ZBEdge™

by  ZIMMER BIOMET



ROSA™ Robotic



Work from Anywhere with myZBedge™
with Patient Care Connect™



Connectivity with Apple Watch™

**Pursuing Optimised Care.
Accelerating Insights.
Unrivalled Experiences.**

Persona™
The Personalized Knee®



ZBEdge is Zimmer Biomet's suite of **integrated digital and robotic technologies**, built to unlock data-powered insights across the continuum of care.

ZBEdge harnesses data to create new value and new capability through an unrivalled user experiences, with the goal of improving efficiencies and optimising patient outcomes.

Designed to **support and complement** Zimmer Biomet's long history in clinically proven implants, ZBEdge **connects and integrates** Zimmer Biomet's medical technology solutions.



For more information visit
zimmerbiomet.com/anz/zbedge

All content herein is protected by copyright, trademarks and other intellectual property rights, as applicable, owned by or licensed to Zimmer Biomet or its affiliates unless otherwise indicated, and must not be redistributed, duplicated or disclosed, in whole or in part, without the express written consent of Zimmer Biomet. This material is intended for health care professionals. Distribution to any other recipient is prohibited. For indications, contraindications, warnings, precautions, potential adverse effects and patient counselling information, see the package insert or contact your local representative; visit <http://www.zimmerbiomet.com/anz> for additional product information. Check for country product clearances and reference product specific instructions for use. Patients must have an iPhone 6 or higher (excluding 2016, 2017 iPhone SE) to use the myZBedge app. Not all patients are candidates for unsupervised physiotherapy and surgeons need to evaluate which patients are appropriate candidates for this pathway. Apple, iPhone and Apple Watch are trademarks of Apple, Inc., registered in the U.S. and other countries.

*Australian Orthopaedic Association National Joint Replacement Registry (AOANJRR). Hip, Knee & Shoulder Arthroplasty: 2020 Annual Report, Adelaide, AOA, 2020: 1-674. [Accessed from: <https://aoanjrr.sahmri.com/annual-reports-2020/>]

 ZIMMER BIOMET
Moving You Forward.™

Sponsor
Zimmer Biomet Pty Ltd
Level 3, 12 Narabang Way
Belrose NSW 2085 Australia
Tel: +612-9483-5400 Fax: +612-9986-1453

Sponsor
Zimmer Biomet New Zealand Company
210 Khyber Pass Road
Grafton Auckland New Zealand
Tel: +64-9925-5200 Fax: +64-9368-5360

www.zimmerbiomet.com/anz
© Zimmer Biomet 2021

+ Precision powered performance

A new standard in value

Use in all your open orthopaedic procedures for hemostasis of soft tissue and bone, via coagulation. Experience the power of the **FASTSEAL 6.0 Hemostasis Wand** utilising the WEREWOLF+ System, now available to use for your sports medicine, ENT and orthopaedic procedures.

Smith+Nephew

WEREWOLF[◇]
FASTSEAL 6.0
Hemostasis Wand

Smith & Nephew Pty Ltd (Australia) smith-nephew.com/en-au. Smith & Nephew Ltd (New Zealand) smith-nephew.com/en-nz. [◇]Trademark of Smith+Nephew. All trademarks acknowledged. © October 2023 Smith+Nephew. 29947-anz V1 10/23. This material is intended for healthcare professionals. For detailed product information, including indications for use, contraindications, precautions and warnings, please consult the product's applicable Instructions for Use (IFU) prior to use.



If someone tells you that you need a traction table to do DAA ...

... they're pulling your leg



The goal of our **SMART DAA** technique was to flatten the learning curve & reduce complications.

We've learnt the best way to achieve this:

- is without a traction table
- with patients in lateral decubitus
- with comprehensive training & support

If you're interested in joining our growing community of **SMART DAA** surgeons, stop by the Mathys booth to find out more.

"I've tried every way to learn DAA, this is by far the best."
-NZ surgeon testimonial

MATHYS 
a company of **enovis**.

Corin OPS Insight™

Connected Orthopaedic Insight

Interactive, cloud-based 3D planning platform for THA

- Revolutionising total hip arthroplasty designed to optimise stability, longevity, biomechanics and patient outcomes.
- Unique component alignment for each patient tailored to their spinopelvic mobility, combined with dynamic analysis of contact mechanics, prosthetic and bony impingement.

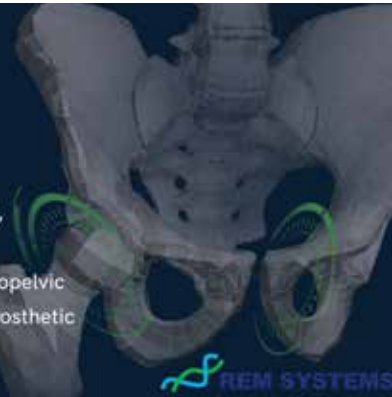

 REM SYSTEMS

Friday 3rd November

4:30pm - 6:30pm **Welcome Function**, Rutherford Hotel trades area.

Saturday 4th November

Combined with Paediatric Society. M Boyle, J Donovan

8:00am-9:00am Registrations

9:00am - 9:10am **Introduction.** M Boyle, J Donovan

9:10am-9:20am **SUFE/DDH long term outcomes.** H Crawford

9:20am-9:45am **Earlier diagnosis and effective treatment in developmental hip conditions.** M Millis

9:45am - 10:10am **Paediatric Hip.** S Weinstein

10:10am - 10:20am **PAO for SUFE and Dysplasia: early results from 300 consecutive cases.**
M Boyle

10:20 - 10:30am Discussion

10:30-11:00AM MORNING TEA

11:00am - 11:20am **Team building in Hipology: essential for best decisions and outcomes.**
M Millis

11:20am - 11:40am **THA in paediatric hip disorders.** M Solomon

11:40am - 11:50am **Outcomes of total hip arthroplasty in teenage patients - a case series.**
K Matenga

11:50am - 12:00pm Discussion

12:00PM - 1:00PM LUNCH

DAA. R Ailabouni and G Chan

1:00pm- 1:40pm **DAA in the UK and the DAA learning curve.** R Field

1:40pm - 2:40pm **NZ DAA Surgeons' Panel Discussion.** H Tobin, M Flint, D Templeton,
N Lash, N Gormack



2:40pm - 2:50pm	DAA THA, timing of early post operative functional milestones and gait analysis. P Ortega Auriol
2:50pm - 3:00pm	DAA Short Stay. D Templeton
3:00PM - 3:30PM	AFTERNOON TEA
	TECHNOLOGY IN HIP. T Lamberton
3:30pm - 3:45pm	Early discharge protocols. J Timperley
3:45pm - 4:00pm	Advances and Innovations in THA. M Flint
4:00pm - 4:15pm	3D Planning in primary and revision hip replacement. M Solomon
4:15pm - 4:30pm	MAKO Hip. J Timperley
4:30pm - 4:40pm	Discussion

Sunday 5th November

8:00am - 9:00am	AGM. M Boyle
	SCOPES AND REVIEWS. M Street
9:00am - 9:15am	Microinstability of the Hip: Fact or Fiction? M Brick
9:15am - 9:30am	Indications for hip arthroscopy in 2023: how to pick the winners. M Boyle
9:30am - 9:40am	Does pre-operative dysplasia severity influence functional outcomes after periacetabular osteotomy? N Lightfoot
9:40am - 9:50am	Surgical hip dislocation for selected acetabular fracture fixation. P Navarre
9:50am - 9:55am	Discussion
9:55am - 10:05am	99 Birmingham Resurfacing - 15 year follow up. H Tobin
10:05am - 10:15am	Clinical Update on Monitoring and Investigation for Patients with Metal on Metal Hip Replacement. N Keddell

- 10:15am - 10:25am **A study of the relative excursion and mechanical advantage of the short external rotator and capsular repair with respect to its ability to resist dislocation. A pilot study in live patients undergoing THA.** P Pechon
- 10:25am - 10:30am Discussion
- 10:30AM - 11:00AM MORNING TEA**
- PERIPROSTHETIC JOINT INFECTIONS AND FRACTURES.** G Chan
- 11:00am - 11:10am **Management of PJI: Contemporary approaches and results.** A Sandiford
- 11:10am - 11:20am **An Australian algorithm to guide the surgical management of chronic prosthetic joint infection: a multi-disciplinary team approach.** C Wilson
- 11:20am - 11:30am **Single stage vs. two stage revision arthroplasty for prosthetic joint infections of the hip and knee.** S Wilton
- 11:30am - 11:40am **Periprosthetic fractures.** J Timperley
- 11:40am - 11:50am **Effect of collared cementless stems vs. cemented stems in late failure for peri-prosthetic fracture - has cement finally died?** C Wilson
- 11:50am - 12:00pm **Discussion, meeting closure.** R Ailabouni

>>> Sports Afternoon

Please register your interest directly with the below people for the following sports:

Golf

Sunday 5th Nov, tee off times at 12:30 and 1:20pm.

**Note, limited capacity per hole, first in, first served.*

Cost \$65 pp or \$50 for affiliated members, please pay at the club. Limited to 28 people per session.

Contact: Alex Rutherford
alexrutherford@xtra.co.nz
027 434 7754

Biking

Sunday 5th November from 1.00pm & 12:30pm.

Option 1: Codgers Ride (easy/medium)

Meet downstairs in the Rutherford Hotel lobby with Kate Ball at 12:30pm for a 1-2 hour ride. Bring your own bike or contact Prue Elwood for suggestions on where to hire from.

Contact: Prue Elwood
prue@nzoa.org.nz
027 586 4336

Option 2: Adventure ride - Coppermine (medium/hard)

Meet downstairs in the Rutherford Hotel lobby with Angus Jennings at 1:00pm for a 4-5 hour ride. Bring your own bike or contact Prue Elwood for suggestions on where to hire from.

Contact: Prue Elwood
prue@nzoa.org.nz
027 586 4336

Paddle Boarding

Tuesday 7th Nov, 6:30am, Tahunanui beach - end of the beach closest to Rocks Rd.

\$20 per person, boards and lifejackets included.

**Note limited boards available, first in, first served.*

Please let Kate know if you need a ride to Tahuna - meet 6:15am in the Rutherford Hotel lobby if you do.

Contact: Kate Ball
kball.ortho@gmail.com
022 014 2137

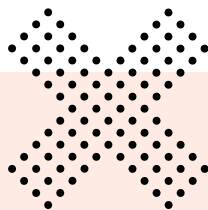

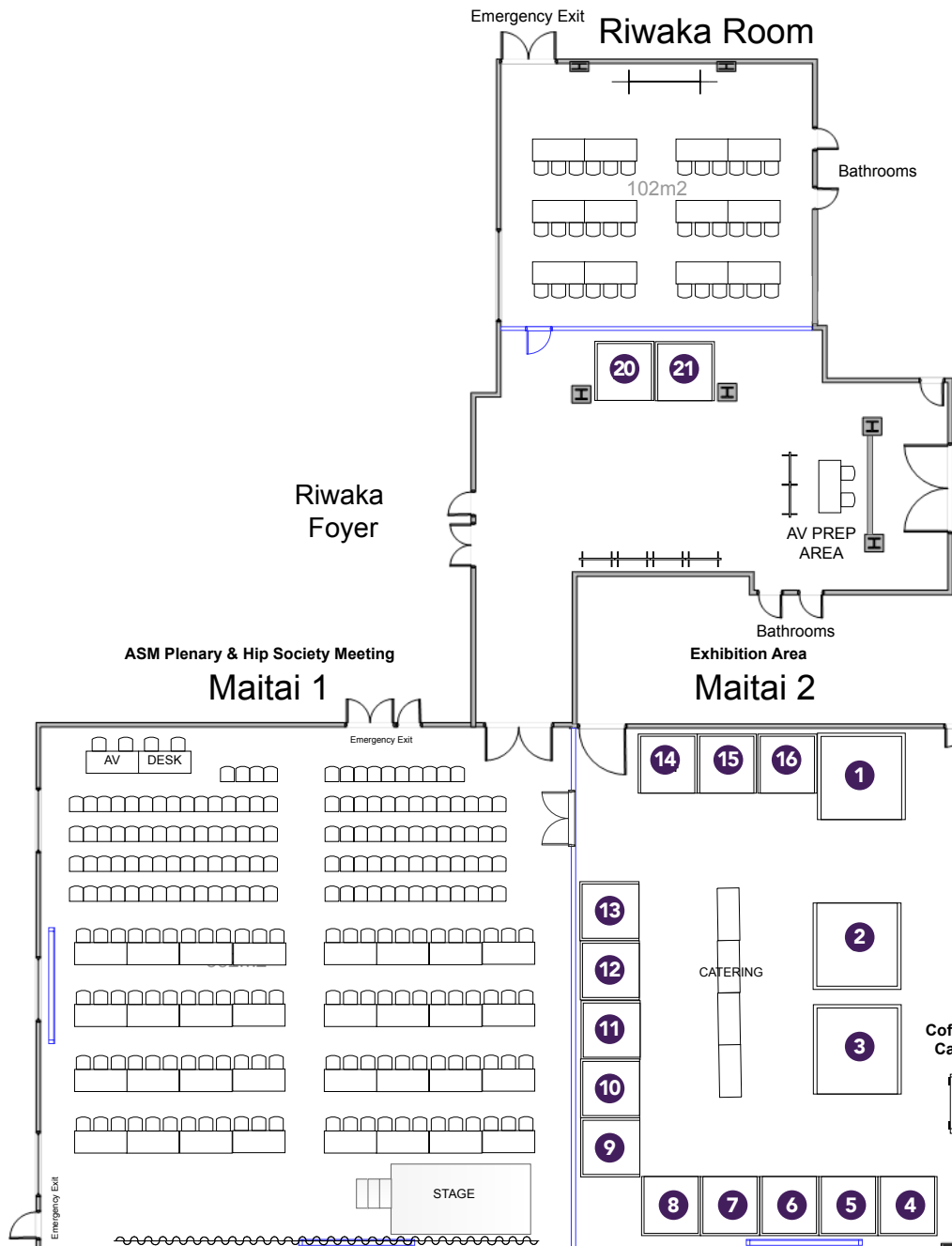

To Hotel Lobby

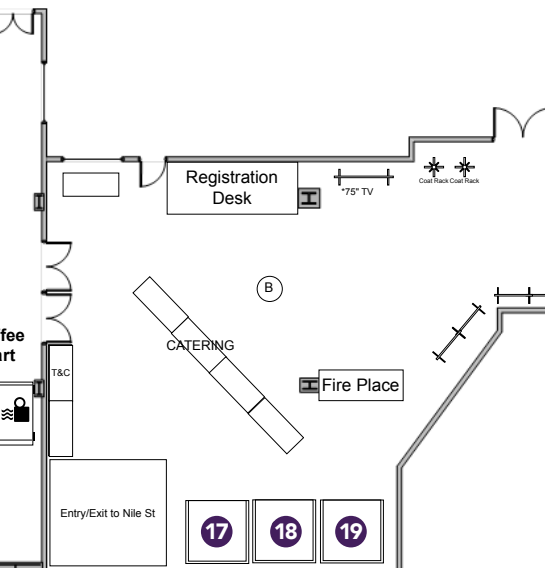

- 1 Zimmer Biomet
- 2 DePuy Synthes
- 3 Stryker
- 4 Smith & Nephew
- 5 REM Systems
- 6 Corin
- 7 Fisher & Paykel Healthcare
- 8 Evolutis New Zealand
- 9 Avanos
- 10 Evolution Healthcare
- 11 DBM Medical Group
- 12 Ossur
- 13 Lima Orthopaedics NZ Ltd.
- 14 Device Technologies
- 15 Life Healthcare
- 16 Pioneer med
- 17 Orb Medical
- 18 Arthrex
- 19 Mathys
- 20 NZ Osteoarthritis Research Network
- 21 Nuvasive

Delegate	Hospital/Business
Ramez Ailabouni	Christchurch Hospital
Gregory Alexander	Gisborne Hospital
Matthew Boyle	Starship Children's Hospital
James Burn	Burn Orthopaedics
Andrew Campbell	Auckland City Hospital
George Chan	Tauranga Hospital
Gareth Coulter	Wellington Hospital
Rob Coup	Whangarei Hospital
Peter Devane	Wellington Hospital
Rob Elliott	North Shore Hospital
Prue Elwood	Education and Training Manager, NZOA
Rob English	North Shore Hospital
Michael Flint	Auckland City Hospital
Nigel Giles	Whakatane Hospital
Nick Gormack	Middlemore Hospital
David Gwynne-Jones	Dunedin Hospital
Nick Keddell	Tauranga Hospital
Richard Keddell	Grace Orthopaedics
Tom Kuperus	Whangarei Hospital
Robert Kusel	Boulcott Hospital
Tony Lamberton	Grace Orthopaedic Centre
Lycia Low	Southern Cross North Harbour
Chuck Luecker	Southland Hospital
Kyla Matenga	Tauranga Orthopaedics
Rod Maxwell	Christchurch Hospital

Delegate	Hospital/Business
Hamish McLaren	Hutt Hospital
David Morley	Waikato Hospital
Bryden Nicholas	Tauranga Hospital
Mary Nugent	Rotorua Hospital
Pablo Ortega-Auriol	University Of Auckland
Pierre Pechon	Palmerston North Hospital
Richard Peterson	Nelson Hospital
Andrea Pettett	Chief Executive, NZOA
Rocco Pitto	Middlemore Hospital
Vaughan Poutawera	Hauora a Toi
Tim Roberts	North Shore Hospital
Amir Sandiford	Southland Hospital
Peter Schneider	Palmerston North Hospital
Konrad Schwanecke	Selina Sutherland Hospital
Rob Sharp	North Shore Hospital
Ivan Spika	Ascot Hospital
Matthew Street	Tauranga Hospital
Yan Ho Bruce Tang	Palmerston North Hospital
Dave Templeton	Timaru Hospital
Helen Tobin	Boulcott Hospital
Chris Williams	Palmerston North Hospital
Sophie Wilton	Tauranga Hospital
Nikki Wright	Conference and Events Manager, NZOA
Mark Wright	Auckand City Hospital

.....

.....

.....

.....

.....

.....

.....

.....

.....

.....

.....

.....

.....

.....

.....

.....

.....

.....

.....

.....

.....

.....



.....

.....

.....

.....

.....

.....

.....

.....

.....

.....

.....

.....

.....

.....

.....

.....

.....

.....

.....

.....

.....

.....

.....

.....

.....



NZOA

New Zealand
Orthopaedic Association