



ATSNZ Disability Expo

6 - 7 November 2024

Due Drop Events Centre, Manukau Auckland



EXPO GUIDE



www.atsnzexpo.nz



An enviro-friendly solution for every door or step

Using recycled tyres, we create durable and versatile rubber ramps designed to make your home or business more accessible and eco-friendly. Order directly from our online store or request a custom, made-to-measure ramp just for you.

Contact us if you have any questions

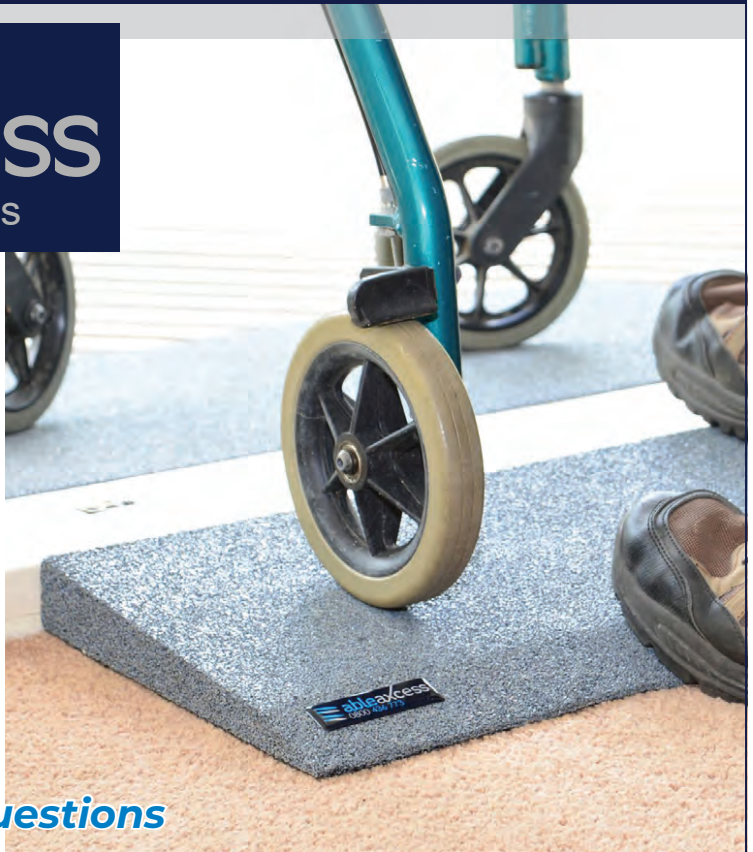

0800 436 773

www.ableaccess.co.nz
quotes@ableaccess.co.nz



It starts with compassionate care

As a family-owned Kiwi business, we strive to make a meaningful difference in people's daily lives through our quality home and community healthcare services.

What we offer

- Personal Care
- Home Help
- Personalised Nursing
- Disability Support Services
- Wound Care
- Physio and Rehabilitation
- Private services

Some services are free under ACC, Ministry of Health, Taikura Trust, Whaikaha, insurance providers and other bureau services.

We're here to help

service@healthvision.co.nz
0508 733 377
healthvision.co.nz



Welcome

Welcome to the 2024 ATSNZ Disability Expo.

On behalf of Assistive Technologies Suppliers New Zealand (ATSNZ - www.ATSNZ.org.nz), I would like to welcome you to the 2024 Disability Expo.

We are proud to bring to you our fifth exhibition of assistive technology, which is aimed at enhancing and expanding the lifestyles of people with disability and seniors across New Zealand.

We are pleased to welcome the exhibitors who have come together to support the Expo, including local small businesses, international organisations and a number of not-for-profit organisations. ATSNZ is honoured to be able to facilitate the Disability Expo as an event that supports all involved with disability of all ages.

The Expo is sure to have something of interest for everyone, whether you are a consumer, caregiver, allied health practitioner, equipment funder or support organisation. Through this year's event, ATSNZ is committed to:

- Showcasing a broad range of assistive technology (AT) and lifestyle services to support choice and control for those with disability, seniors and care givers.
- Educating our expo visitors about the latest advances in AT and related services, and to support the development of their technical skills and knowledge.
- Helping people improve their independence, dignity, health and well-being through awareness of assistive technology options.

The world-class Seminar Program has only been made possible through the generous support of many companies and organisations, both local and international. ATSNZ wishes to pass on its thanks to the outstanding panel of speakers who will be presenting and the supporters of the Expo for making this program possible.

Thank you for taking the time to attend this exceptional event and I hope you will visit us again at future ATSNZ Disability Expos.

Ingrid van Rijn - Executive Officer, ATSNZ

Exhibitors

ABILITYPOST

Stand 82

www.brand.site/abilitypost

abilitypost.nz@gmail.com

Phone: 0273263181



AbilityPost introduces an innovative one-way accessibility gate mechanism, addressing the challenge of out-of-reach magnetic pull-up locks while ensuring containment for fenced areas. Although useful for all, it primarily benefits the wheelchair community, it caters to spaces like schools, parks, playgrounds, and childcare facilities. With an inclusive design and robust aluminum construction, AbilityPost offers both durability and functionality. Just as easily retrofitted to existing gate settings, as it is new installations. AbilityPost is poised to redefine inclusive accessibility in various environments.

ABLE AXCESS

Stand 99

www.ableaxcess.co.nz

quotes@ableaxcess.co.nz or 0800 436 773



Able Axcess Ltd is a New Zealand company that specialises in providing accessible mobility solutions for residential and commercial customers. Our products include: Aluminium Modular Ramps: These are reusable ramps that can be installed quickly and easily anywhere. They are designed and manufactured in our Feilding factory and installed by our trained technicians. Rubber Threshold Ramps: These are made from recycled tyres and help with access over small steps or doorways.

They are wheelchair and walker friendly and can be ordered online with shipping NZ wide. Level Shower Insert: This is a product that converts most standard showers into accessible showers. It is installed by our technicians and does not require any major alterations to the bathroom. We are committed to delivering high-quality products and services that improve the safety and mobility of our customers. We have a reputation for solving problems and standing behind our products. Contact us today for a free quote or visit our website for more information. Phone: 0800 436 773 Web: www.ableaccess.co.nz Email: sales@ableaccess.co.nz

ABLE TECH SERVICES

Stand 80

<https://abletechservices.co.nz/>

Phone: 09 269 8990



Able Tech Services is primarily a service and repair company focused on ensuring your equipment functions optimally all year around and is safe to use for patients and careers alike. Able Tech Services can repair a majority of the equipment brands across New Zealand for a wide range of equipment, from your medical beds, to patient lifting hoists, to wheelchairs, to commodes, to oxygen concentrators, pulse oximeters and much more. Visit our website for more details or reach out to us. www.abletechservices.co.nz 0800 339 336

ACCESS ADVISORS

Stand 73

www.Accessadvisors.nz

info@accessadvisors.nz or 0800 300 099



Access Advisors is a team of experienced digital accessibility experts. We have a mission to help Aotearoa New Zealand become digitally inclusive. We provide a caring, connected, capable and commercially

aware perspective. We tailor our services to meet your business needs by developing solutions with you that are specific to your organisation's goals. We help to ensure that accessibility is built into everything you do. From reviews and discovery to design, development and testing, Access Advisors can help make your organisation become more digitally inclusive.

ACCESS COMMUNITY HEALTH | URU ĀTEA

Stand 50

www.access.org.nz/

referrals@access.org.nz



We're all about meeting you in your space wherever that space may be. Since the 1920s, we've been right here in Aotearoa, offering disability and nursing supports nationwide. We work closely with Whaikaha, Te Whatu Ora, and ACC to lend a hand to over 40,000 people nationwide. Our skilled team of nēhi|nurses and kaiāwhina|support workers are here to help you live your best life. Whether it's reaching your goals or connecting with your community, we're with you every step of the way. A partnership with Access means you paddle your own waka, we come along for the ride. Trust us to be part of your journey and discover a better day, every day.

ACCESSABLE

Tables 13 and 14

www.accessable.co.nz/



Email: info@accessable.co.nz or 0508 001 002

Accessable provides equipment, vehicle and housing modifications to support people with disabilities and injuries to lead mana enhancing lives. We've been working with disabled people, whānau, therapists, funders and our disability sector colleagues for over 20 years, so we have a real understanding of disability, injury related need and the disability

environment. We're also the experts in eligibility and criteria for funding options. Our 90 staff go about their day-to-day with a shared purpose: to support disabled and injured people to live self-determined, ordinary lives.

ACORN STAIR LIFTS

Stand 25

www.acornstairlifts.co.nz/

09 271 8445



Since our earliest days in 1992, Acorn STairlifts has strived to set new standards in quality and innovation for the stairlift industry. Our pioneering designs and engineering excellence have led the way and helped Acorn Stairlifts grow to become the world's leading independent company specialising solely in the manufacture and installation of stairlifts. Our Stairlifts are built to exacting standards in our own factories, our cutting edge stairlifts are now exported to more than 80 countries around the world. By the time you have read through our website, we will have given someone else's life a lift — that's because an Acorn Stairlift is installed somewhere in the world every eight minutes, 365 days-a-year.

ACTIVE HEALTHCARE

Stand 22

www.activehealthcare.co.nz/

shontelle@activehealthcare.co.nz



Active Healthcare is a thriving and established business supplying hospital, community and aged care markets with premium healthcare equipment, education, service and support. With more than 30 years' experience working with assessors, clients and equipment suppliers, Active Healthcare is a well-known and trusted solutions provider to the New Zealand healthcare sector.

AHS SECURITY HARDWARE

Tables 5 and 6

www.ahs.co.nz/accessibility-made-easy/

aklsales@ahs.co.nz



Architectural Hardware [AHS] have been servicing the building industry with architectural hardware for over 30 years. More recently, we have developed a range of hardware and software solutions to improve accessibility for all, specifically door operators for both sliding and swing doors. These great products have transformed lives for disabled people, by increasing their independence and access to their homes and other facilities. Whether you use a keypad, fob, remote, or sensor, getting in and out has become so much easier!

ALLIED MEDICAL

Stands 66 to 68a

www.alliedmedical.co.nz

helpis@alliedmedical.co.nz or 0800 316 181



Allied Medical is an established assistive technology products importer and distributor into the New Zealand market. Each product in our range has been carefully selected to meet the needs of this market, as a response to feedback, input and advice from the end users of our products, and the clinicians who prescribe them. Our primary focus is to provide our customers – along with their clients – world leading assistive technology products, supported with strong product knowledge, readily available technical support and on-going product training.

ARJO

Stand 26

www.arjo.com/en-au/

info.nz@arjo.com



At Arjo, we believe that empowering movement within healthcare environments is essential to quality care. Our products and solutions are designed to promote a safe and dignified experience through patient handling, medical beds, personal hygiene, disinfection, diagnostics, and the prevention of pressure injuries and venous thromboembolism. With over 6500 people worldwide and 65 years caring for patients and healthcare professionals, we are committed to driving healthier outcomes for people facing mobility challenges.

AVANOS

Stand 35

www.avanos.com.au



Avanos is a medical device company that develops, manufactures and markets recognized brands in more than 90 countries. Avanos provides respiratory health and enteral feeding solutions. Some of our recognizable brands are MIC-KEY*, CORTRAK* and BALLARD* Closed Suction Systems. At Avanos, we make it a priority for both clinicians and patients, that our closed suction systems, endotracheal tubes, oral care solutions, and enteral feeding solutions help improve patient outcomes and quality of life.

BEACHWHEELS NZ

Stands 42 - 43

www.beachwheels.co.nz

info@beachwheels.co.nz



Offering everyone the opportunity to experience beaches, parks and trails with easy access. Our goal is to change people's lives, by helping everyone get out and about, doing the things they love with the people they love. There are a lot of benefits to mental and physical health by getting outdoors. And a lot of our products are outdoor all terrain products that can go on trails, over gravel, on the beach, in the water. Wherever you want to go and whatever you want to do, we have a range of products to suit. Beachwheels NZ is built on quality products with exceptional service. With an ever-expanding range of innovative, quality mobility products and a dedicated team to match your needs to our products, your mobility is in the best hands.

BETTER DAYS

Table 17

<https://betterdays.nz/>

admin@betterdays.nz



Based in Tāmaki Makaurau, Auckland, we work kanohi ki te kanohi/ face to face with people of all ages and life stages in their homes, private hospitals, residential care facilities, schools and early childhood centres, as well as delivering full Telehealth services nationwide. We gather a team who share a passion for delivering the highest level of care, genuinely love what they do and work hard to achieve the very best outcomes for our participants

BQ MOBILITY

Stand 23

www.bqmobility.co.nz/

phil@bqmobility.co.nz



BQ Mobility designs and builds innovative equipment for wheelchair users. The SiMAX Handcycle Simulator allows users to connect through exercise. Whether you want to experience the joy of getting your shoulders moving or push the limits to race your mates, the interactive rides have something for everyone. Between Phil's lived experience as a C5/6 quadriplegic and engineer minded approach to design and Paul's meticulous attention to detail, the Hamilton-based team love the buzz of seeing new users light up with excitement and seasoned pros transform their lives through fitness. Give it a GO!

C1 SOUTH

Stands 10 - 12

www.c1south.co.nz/shop

Phone: 0800212333



Delivering Function, Independence & Choice to New Zealanders with a disability for over 20 years. C1 South specialises in wheelchair seating and provides a range of quality, innovative products from around the world to promote function, independence and choice for people with a disability. We are a small company that can respond quickly to ensure that we provide product in a very timely manner through out NZ. We have a great range of cushions and back supports as well as exceptional low tech pressure care options. We also have a large number of gadgets to suit everyone and leisure and recreation options. We also are part of Accessible Beaches NZ and love that we can be part of providing the opportunity for everyone to access our wonderful beaches and waterways.

CANTERBURY CONCEPTS – GRAB RAILS

Stand 91

canterburyconcepts.com.au/
info@canterburyconcepts.com.au



Canterbury Concepts have been an innovator and leader in the design and manufacture of Grab Rails for the aged and disability communities since 1989. Our Grab rails are easy to instal modular and adaptable. Available in White, Beige and Cobalt Blue for dementia and partially sighted clients.

CARE ON CALL

Stand 74

www.careoncall.nz/
Phone: 0800 664 422



Care on Call provides high quality and personalised home care support services for people of all ages throughout New Zealand. Our caregivers come to you, allowing you to receive the assistance you need, while remaining safe and independent in your familiar surroundings. We are here for you 24 hours of the day, 365 days of the year, with services that are tailored to meet your unique needs.

CCS DISABILITY ACTION

Table 3

www.ccsdisabilityaction.org.nz/
Phone: 0800 227 2255



TE HUNGA HAUĀ MAURI MŌ NGĀ TĀNGATA KATOA

CCS Disability Action is the largest pan-disability support and advocacy organisation in Aotearoa New Zealand. We support people with all types of impairments and have been working alongside disabled people since 1935. We are at the forefront of service provision, advocacy and

information sharing in the disability sector. We partner with disabled people, their families and whānau to enable them to have choice and control in their lives. Our vision is to see every disabled person and whānau hauā interwoven into the lives of their whānau and community.

CUBRO

Stands 1 - 2 and 14 - 17

www.cubro.co.nz

0800 452 273

Cubro[®]

We're privileged to partner with Occupational Therapists and Physiotherapists to help more Kiwi's and their whānau participate in life. In recent years, New Zealand's health system has come under extensive pressure. With a rapidly aging population, funding inequities, and chronic staff shortages, Aotearoa needs innovative health solutions from Kiwi companies like ours.

At Cubro, we are dedicated to providing the highest quality equipment for enhanced care. Our unwavering commitment to excellence drives us to exceed even the most stringent standards. We aim to improve patient outcomes by offering solutions designed to transform care and empower healthcare professionals. With streamlined care and efficiency, our equipment seamlessly integrates into workflows, saving time and resources. We prioritise caregiver and patient comfort through superior design and ergonomic solutions. Join us in shaping the future of healthcare delivery.

ENABLE NEW ZEALAND

Table 11

<https://www.enable.co.nz/>

Email: communicationa@enable.co.nz



Enable has been supporting New Zealanders with disability equipment and services since 1974. New Zealand's largest provider of disability equipment and modifications. Enable is contracted by the Government to provide equipment, vehicle and housing modifications to people with a long-term disability for those located from the Bombay Hills down. We also provide this support on ACC's behalf for all of Aotearoa. Each year, we deliver complex services to thousands of New Zealanders to support them in living better lives. We also provide information and advice nationally through Firstport.co.nz, online and at our hotline 0800 171 981. Our Easie Living team support Manawatu-Whanganui with information and equipment through the Easie Living Centre and the Easie Living Mobile Van service.

EPILEPSY FIRST AID

Table 18

<https://epilepsyfirstaid.bigcartel.com/>

+64 21 0243 6472



Epilepsy First Aid is about educating people about what to do when someone has a seizure and appropriate first aid. Krystle does in person speaking events and workshops. Epilepsy First Aid and Snowy's Talent books will be for sale at the Auckland ATSNZ show days. Krystle comes from a lived experience of Epilepsy and wants to get the word out there to give more people confidence to help people with Epilepsy.

www.epilepsyfirstaid.com www.facebook.com/epilepsyfirstaid

GOLDFERN MOBILITY

Stands 44 - 47

www.goldfernmobility.co.nz

GoldfernMobility™

Goldfern Mobility is deeply proud to be a 100% Kiwi family-owned operation. We aim to provide quality products to make everyday tasks a little more manageable for those living with a disability. We genuinely believe our clients deserve the best products to help them live the details of life well. We are intentionally selective with our stock and our size to ensure we meet an expected standard of excellence. We work to modify our equipment as necessary, so everything meets our 3-point standard: Safe. Functional. Affordable.

GOODTOUCH

Table 10

www.goodtouch.co.nz

Email: lauren@goodtouch.co.nz

GoodTouch.co.nz
Intimate Health & Wellness

GoodTouch.co.nz, Intimate health & wellness store specialising in Eco-Friendly, Ethically Produced & Inclusive Products.

GRACE MEDICALS

Stand 19

www.gracemedicals.co.nz/

Phone: 0225167676

 **Grace
Medicals**

At Grace Medicals, we are more than just a supplier; we are your partners in transforming healthcare experiences and outcomes. Established in 2007, Grace Medicals is a New Zealand-based company dedicated to the medical and service industries. We are more than just a supplier, we consider ourselves your partner in advancing healthcare, focusing on positively impacting lives with our comprehensive range of products, services, and healthcare initiatives.

HEADWAY - BRAIN INJURY AUCKLAND

Table 1

www.headway.org.nz/

Phone: 09 520 4807



At Headway, we empower individuals impacted by brain injury and their whānau to live their fullest lives. Through education, expert advice, and peer support, we provide the tools, guidance, and community needed to not just navigate life, but to thrive. Together, we champion resilience, promote well-being, and create pathways to brighter futures.

HEALTHVISION

Stand 24

www.healthvision.co.nz/

0508 733 377 or service@healthvision.co.nz



As a family-owned Kiwi business, Healthvision has been leading the way in community health services for 25-years, bringing together expert care with a compassionate approach that leads to positive outcomes for service users. Healthvision offers a suite of services including nursing, physiotherapy, rehabilitation, home support, and health & wellbeing. By integrating these services seamlessly, Healthvision can deliver more efficient healthcare, which results in better outcomes for service users.

ICARE MEDICAL GROUP

Stands 92 - 94



Icare Medical Group Ltd is an NZ owned and operated company dedicated to providing premium homecare equipment. Our aim is to manufacture equipment that looks and feels as domestic as possible while still meeting clinical standards. We partner with allied health professionals to drive development of products that help change the daily lives of people in need.

IHC NEW ZEALAND - STAND TALL

Stand 76

www.ihc.org.nz/

ihc.events@ihc.org.nz



IHC will advocate for the rights, inclusion and welfare of all people with intellectual disabilities and support them to live satisfying lives in the community. Stand Tall began when the IHC Library noticed there wasn't a lot of information on managing money, specifically for young New Zealanders with intellectual disabilities or neurodiversity. With the support from The Holdsworth Charitable Trust, the library started to investigate creating a resource to support people to become more independent. Developing a game looked like the best way to create a resource that would be fun and help people learn. IHC joined forces with InGame and worked together on different scenarios and designs until this fun game was ready to play. Stand Tall was first presented and tested at a workshop as a board game before it was developed into an online game. The game testers came together to test what is involved with living independently. Once the board game was finalised the online prototype of the game was developed and tested among the same testers. IHC is still working with InGame to create further scenarios and continuing to make changes to keep Stand Tall up to date. At the beginning of the game, you can create an Avatar and decide the best look for you. From there you face many scenarios that reflect living in a flat for example, how much money do you need for groceries? How are you going to remember your chores? Are you going to call the landlord about the broken shelf? All these questions come with three choices, all of which impacts your Avatar's financial, physical and emotional health in negative or positive ways, just like in real life. The scenarios in Stand Tall are realistic example of events that can happen in a shared flat. Stand Tall is suitable for students and people transitioning from school or moving to a more independent lifestyle. Stand Tall is completely FREE and available to download on the Google Play Store or Apple App Store. You can also play on the web www.ihc-standtall.com.

INDEPENDENT LIVING CHARITABLE TRUST

Stands 36 – 37

<https://ilsnz.org/>

Phone: 0800 625 100



Here at Independent Living, we are committed to making daily life easier for disabled people and those living with mobility concerns, by providing the disability equipment NZ can rely on. A not-for-profit organisation, we are your friendly community experts on all things related to disability and helping you to maintain your independence. We work with you to understand your situation, concentrating on what your abilities are. We then find solutions for the areas that you need assistance with. Many of us have experienced disability ourselves, and can work with you for great outcomes. Our stores are packed full of great mobility products and daily living aids- and the team are happy to offer free advice.

INDEPENDENTLYYOU.COM

Table 2

<https://independentlyyou.co.nz/>

Phone: 0800 276 559



From its humble beginnings as a small home business, Brolly Sheets has blossomed into a beacon of family-focused innovation that resonates with parents worldwide. Rooted in a simple yet poignant experience, Kiwi Mum Diane's epiphany while tending to her daughter Mia's wet bed sparked the creation of our flagship product – the very first Brolly Sheet. This heartwarming inception embodies our commitment to making parenthood easier and more joyful. Within the heartwarming tapestry of Brolly Sheets, there exists a cherished chapter named Independently You – an extension of our family's legacy, dedicated to embracing families with care, compassion, and innovation.

INVACARE NEW ZEALAND

Stands 55 - 60

www.invacare.co.nz

0800 468 222



Yes, you can.

Invacare manufactures and distributes a comprehensive range of personal assistance products to help our users enjoy a comfortable, safe and active lifestyle. Our mission is embodied in our company motto to “Make Life’s Experiences Possible”. Today, Invacare is a global leader in the worldwide market for medical products and services used in the home. Invacare designs, manufactures and distributes an extensive line of innovative home and long-term care medical products and services that promote recovery and active lifestyles. We are committed to understanding our customer’s needs and exceeding their expectations to help rebuild and maintain active lifestyles.

JANDS

Stand 78

www.jands.co.nz/

Phone: 09 941 9780



Jands (New Zealand) Ltd provides professional audio and lighting solutions throughout New Zealand. We believe in delivering top-tier products and innovative solutions for our customers. Our expert team supports every step, from technical specification and design to commissioning and implementation. At the ATSNZ Disability Expo, we are proud to feature accessibility solutions from Ampetronic and Listen Technologies, including Auri, helping create inclusive environments through advanced audio technology. In New Zealand, Jands represents leading brands including Ampetronic, Anolis, Blustream, Concierge, Dynacord, Electro-Voice ETC, Furman, L-Acoustics, Listen Technologies, RGBlink and Robe.

LINK ASSISTIVE NEW ZEALAND

Stand 38

<https://linkassistive.co.nz/>

office@linkassistive.co.nz



Link Assistive is a New Zealand supplier of Assistive and Interactive Learning Technologies. Link Assistive's mission is to help people to communicate, connect, learn, and participate by providing high quality personalised, assistive and interactive technology solutions. Our team of skilled professionals provides the right advice, training, and technical support to help find the right solution for our customers.

LOUNA MOBILE BATHROOMS

Stand 20

www.louna.org.nz/

info@louna.co.nz or 027 3336822



With over 30 years experience in the building and occupational therapy industries, LOUNA mobile bathrooms have designed and built mobile bathrooms for people with mobility issues and for people who need temporary bathroom solutions. We stand out from other mobile bathroom providers as we combine our knowledge of building and Occupational Therapy to ensure our clients have the right support and solutions for their needs.

MACA

Trestle 12

www.macahub.org/

Email: contact@macahub.org



MACA is a global leader dedicated to advancing the rights of children and young people with disabilities and medical conditions to safe transport. MACA leads research and advocacy, and provides evidence-based

information and training. AuSAP was established by MACA in 2020 to assess (including crash testing) specialty vehicle restraint systems.

MEDIFAB PTY LTD

Stand 21

www.medifab.co.nz

solutions@medifab.com Phone 0800 543 343



Shaping better lives since 1990. Grown from small beginnings, the Medifab and Spex story is driven by a single-minded purpose – to bring comfort and functionality to people living with disabilities. They design and manufacture specialist seating and high-quality clinical equipment for children and adults with complex medical needs. Established with a genuine passion to help, they innovate to create break-through technologies, so their clients can manage their daily physical and cognitive challenges with the dignity they deserve. Working closely with therapists, carers and clients, their customer-focussed approach and ‘whatever it takes’ attitude is at the heart of everything they do. www.medifab.com

MEDIX 21

Stands 7 - 9

www.medix21.co.nz

admin@medix21.co.nz



Medix 21 is a New Zealand-owned leading supplier of quality, innovative and cost-effective Assistive Technology products and solutions. Our patient-centric team deliver excellent service and honest advice, backed by strong clinical and technical expertise. Collaborating with clients, families and healthcare professionals we are committed to improving quality of life.

MELROSE KIWI CONCEPTS CHAIRS

Stand 6

www.melrosewheelchairs.co.nz

sales@melrosechairs.co.nz

Phone 03 354 5616



Melrose Kiwi Concept Chairs is a New Zealand company manufacturing custom made manual lightweight wheelchairs for NZ and international markets. After an accident Phil Melrose believed he could make a better wheelchair that suited his needs better than any other wheelchair offered him. He bought together a team who were passionate about design and fabrication to build wheelchairs for individuals. After 30 years that small team is now over 40 staff and the same passion to understand the needs of wheelchairs user's remains. Our custom wheelchairs are made to fit you and to suit the way you move. Our wheelchairs are Uniquely You.

MENTIS LTD

Stand 81

www.mentis.co.nz/

Phone: 09 6244285



We supply Software, Technologies, Interactive Tools and Equipment for home, business, and education at all levels. Collectively we term this 'mindware', hence our company name Mentis (Latin for "the mind"). Mentis attends a number of IT focused trade shows. We display, demonstrate, and explain all the equipment we have available. In the disability area, we offer a variety of great products for scanning and reading of lines of text, documents and books. We have a range of software titles that help make writing easier. We also offer tactile creative products to help people develop social, motor, cognitive, and emotional skills. Mentis is a New Zealand owned and operated company based in west Auckland. Doing things right for customers is the most important thing we do.

MOBILITY CENTRE

Stand 18

www.mobilitycentre.co.nz

Phone 07 903 7050



Mobility Centre is NZ's largest retailer of mobility equipment with stores in Hamilton, Tauranga, Hastings and Wellington and van-based services in Auckland, Bay of Plenty and Waikato areas. This is complemented by its online store at www.mobilitycentre.co.nz. Mobility Centre parent organisation has been serving the disabled community in NZ for over 40 years and has staff throughout NZ fulfilling NZ Government disability support contracts.

MOBILITY SUPPLIES NZ

Stand 61

<https://mobilitysuppliesnz.co.nz/>

Phone: +64 6 357 7943



Mobility Supplies NZ is an importer and wholesaler of several niche items including Genny, Harmar, Gastrock, U Step and more

MOVEME HEALTH ORTHOTICS

Stand 83

www.moveme.health/

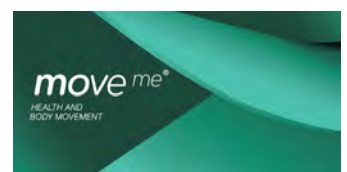

MoveMe is home to New Zealand's top Orthotic wholesale products. MoveMe health carries products from top most companies in the field of Orthotics all across the world, Thuasne, Restorative, Ossur, Otto bock, etc. We are exclusive distributor in New Zealand for Thuasne and Restorative.

MUSCULAR DYSTROPHY ASSOCIATION OF NEW ZEALAND

Table 16

www.mda.org.nz/

Denise@mdn.org.nz



Muscular Dystrophy
New Zealand

Northern

The Muscular Dystrophy Association of New Zealand Inc. (MDANZ) is a member-led organisation established by New Zealanders with lived experience of neuromuscular conditions. We began in the late 1950's as a support group for families affected by muscular dystrophy. Since then, we have broadened our scope to include many other neuromuscular conditions and have become a leading source of information and support to our community.

NEW ZEALAND ARC HEALTH LIMITED

Stands 71 - 72

www.nzarc.co.nz/

pamela@nzarc.co.nz



NEW ZEALAND ARC

New Zealand ARC Health Limited (NZARC) NZARC Health Limited is a healthcare focused company based in New Zealand. We specialise in sourcing, supply chain and digital health care solutions and services, with a particular focus on facilitating trade between China and New Zealand and developing global relationships. Our mission is to provide comprehensive, one-stop smart solutions for companies, leveraging digital healthcare innovations and advanced technologies to optimize processes, enhance efficiency, and improve patient outcomes. We offer a comprehensive suite of services and dedicated support Whānau community. For more information, please feel free to visit our company website via www.nzarc.co.nz

NZ HEALTH GROUP

Stands 96 - 98

**www.nzhealthgroup.com/
marketing@nzhealthgroup.com**



New Zealand Health Group (NZHG) is Aotearoa New Zealand's largest nationwide provider of home and community support services, disability support, rehabilitation, mental health and behavioural support, health staffing, workplace support, sector training, private care and medical alarms. Our team of over 10,000 carers, support workers, nurses, and other health professionals provide more than 100 specialist services across Aotearoa to tens of thousands of New Zealanders every day. With the purpose of achieving equitable wellbeing for everyone, NZHG works in collaboration with government, health authorities, local iwi, and communities to ensure people are supported with the care they need to live their best lives.

OMEOTECHNOLOGY LTD

Stands 3 – 4

**<https://omeotechnology.com/>
hello@omeotechnology.com**



We change the accepted thinking behind personal transportation and mobility, through intelligent and cool design. Omeo Technology is a Kiwi company providing life-changing, cutting-edge technology. We are proudly represented in the North Island by Karen and Trevor of Wheel Adventures, our Agents, who have been with us on our journey since the beginning. The Omeo is a dynamic, two-wheeled mobility device that provides movement through balance. It's patented award-winning design ensures that it has a wide range of uses, manoeuvring with ease and grace through everyday crowds and shared spaces, navigating tight areas, and beyond. From home, to the workplace, to the beach and trails, the Omeo is your passport to an exciting new world of mobility, freedom, and independence. Bringing

back the joy of movement, as your Omeo intuitively creates a relationship between mind, body, and balance, allowing more opportunities to engage with loved ones and the wider community.

PEOPLE FIRST NEW ZEALAND

Table 15

<https://www.peoplefirst.org.nz/>

0800 20 60 70



People First New Zealand is a Disabled People's Organisation (DPO) which means we are run by and for people with learning disability. Our work makes sure people with learning disability have and know their rights and that our communities are inclusive across Aotearoa New Zealand.

PERMOBIL NEW ZEALAND LTD

Stands 27 - 33

www.permobil.com/en-nz

Phone 0800 115 222



For over 50 years, Permobil has been dedicated to providing individuals with innovative assistive technology to help them live life to the fullest. We are passionate about understanding our users' needs and are a global leader with trusted solutions for power and manual wheelchairs, seating and positioning products, and power assist devices. We have qualified and experienced Territory Sales Managers nationwide, who will work with you to provide product advice that ensures patient care is optimised. All products can be quoted on our website www.permobil.com/en-nz or by calling our customer service team on 0800 115 222

PORTABLE X-RAY

Stand 52 plus vehicle in Entrance Foyer

www.portablexray.co.nz/

Phone: +64 9 6230274



Enhancing accessibility in healthcare. Portable X-Ray offers a Radiology service that comes directly to you. We provide X-ray services in rest homes, dementia units, private hospitals, and retirement villages throughout the Auckland and Waikato regions. We also cater to visits in private homes. Our radiographic equipment is entirely portable, allowing us to conduct X-rays in almost any location – navigating stairs is typically manageable. We tailor our service to fulfill the needs of both the patient and physician, meaning patients can be X-rayed while resting in bed or even sitting in a chair. We operate eight (8) X-Ray units on the road, along with two additional vehicles for extra support as needed. Our goal is to provide same-day service. All X-ray images are interpreted by a consulting Radiologist. Many of our patients are too ill, frail, or anxious to be transported to a Radiology department. By bringing the service to their familiar surroundings, we offer them peace of mind and help prevent further injury or discomfort caused by transportation. We Are: *Available 24/7 for all X-ray examinations *Specialists in X-raying bedridden and/or frail patients *Ready for home visits *Flexible to accommodate your needs *Fully portable *Efficient *Providing a hassle-free service *Professional *Proud of our high-quality images

PRIDE MOBILITY PRODUCTS

Stand 13

www.pridemobility.com.au/nz

+64 9 828 0337



Pride Mobility Products is the world's leading innovator and manufacturer of personal mobility products. We are dedicated to helping those with mobility needs live the highest quality of life. Pride Mobility Products New

Zealand provides an extensive range of travel scooters, everyday scooters, power wheelchairs, and power lift recliners to cater to diverse needs.

QUINN LIFTS & ELEVATORS

Stands 85 – 86

www.quinnlifts.co.nz/

Phone: 07 867 6712



Quinn Lifts & Elevators are designers, manufacturers and installers of domestic and commercial passenger elevators and short rise mobility lifts. Our short rise lifts can rise to levels of both 1m and 1.5m, are designed to be free standing and portable while being durable and stable. Proudly New Zealand owned & operated Quinn has been designing, manufacturing, installing and maintaining lifts throughout the South Pacific Basin since 1990. Our reputation has been built by the fact that we stand behind our locally built products and service standards, we pride ourselves on being the most customer-responsive player on the field. Visit www.quinnlifts.co.nz or call our team on 07 867 6712 to find out more.

REHASENSE (NZ) LIMITED

Stands 39 – 41

www.rehasense.com/

Phone: 09-555-3111



REHASENSE

Part of the Global Rehasense Group, Rehasense New Zealand supplies the market with a wide variety of high-quality rollators, light active wheelchairs, power add-ons (PAWS and ECO), long term care beds, access ramps and shower and commode chairs. In New Zealand it supplies direct to wholesale customers and beds through its distribution partner, Liberty Healthcare. Rehasense controls the production of its products from raw material stage right through to finished goods, and offers the best warranties in the market, a measure of its commitment to quality.

REID TECHNOLOGY LTD

Stand 54

www.healthcare.reidtechnology.co.nz/

0508 20 20 10 extn 1

REID TECHNOLOGY

assistive technologies

Reid Technology Ltd is one of the leading suppliers of assistive technology in New Zealand. We offer products that assist people who have hearing, visual or cognitive impairment, helping them lead their lives to the fullest. We will be displaying products from Abilia, Bellman & Symfon, Oricom, Speaksee and WeWALK on our stand.

ROLAPAL LTD

Stands 62, 63, 53, 54

www.rolapal.co.nz/

0211829287

ROLAPAL

Rolapal Ltd is a leading provider of wheelchair seating solutions, offering a diverse range of products to cater to individual needs and preferences. Our vision is to create revolutionary Assistive Technology products which are easy to use, have outstanding comfort & versatility, without requiring maintenance. Our range includes the renowned Dreamline brand, as well as Ignite, Splash, Snooza, and Woven Air, each offering unique features and benefits. Rolapal Ltd continues to revolutionize the wheelchair seating industry, empowering individuals to lead fulfilling and independent lives. For more information on Rolapal and our product lines visit www.rolapal.co.nz

RONGOĀ MĀORI

Stand 77

SA PLUMBING SUPPLY

Stands 48 - 49

<https://sapsltd.nz/>

sean@sapaltd.nz

SA Plumbing Supply Ltd is a specialist provider of bathroom products without the hospital look. Support rails, shower slide rails, basins etc.



SENSORY SAM

Stand 79

<https://sensorysam.co.nz/>

hello@sensorysam.co.nz



Sensory Products with Pizazz! Fidget toys, Weighted Blankets, Calming Products, Chew Necklaces, LED Bubble Tubes, Crashpads, Swings, Sensory Rooms and so much more! Sensory Sam has sensory Aids to relieve anxiety, promote calm, entertain, inspire, distract or focus- At home, in schools, in Therapy, hospitals, or in the car and about. We serve the Neuro-Divergent Community with sensory resources that normalise, promote inclusion, offer a sense of pride and encourage positive engagement when using them. Whether you're Neuro-divergent or Neuro-typical, Autism, ADHD, SPD, Cerebral Palsy, we have stress relieving products that can make a difference. Schools, OT's, families, contact us for funding quotes, invoices or CPS card purchases. hello@sensorysam.co.nz We'd love to hear from you!

SPECIALIST REHAB SERVICES

Table 19

www.srsLtd.co.nz/

Phone: 09 9030960



Specialist Rehab Services Ltd (SRS) is a leading provider of comprehensive rehabilitation services in Aotearoa, dedicated to empowering adults, children, and their whānau to reach their fullest potential for independence and quality of life. With a strong commitment to person-centred care, SRS have a team of highly experienced clinicians who utilise an evidence-based approach to deliver tailored, effective treatment. At the heart of everything we do is a focus on supporting individuals in a compassionate and empowering environment, ensuring the best possible outcomes for those we serve.

TE WANA LTD

Stand 5

www.tewanaltd.co.nz

info@TeWanaLtd.co.nz



Te Wana Ltd - Technologies that Care Providing a range of high-quality medical-grade Care Sensors, Epilepsy Alarms and Assistive Technologies to support families, caregivers and support providers in Aotearoa. Provided full service from assessment, prescription, supply, installation (where possible), and review with a 30-day money-back guarantee on most products. We help customers make the right choices that meet their needs and support them in using the technologies provided to manage the risks identified. Focused on the needs of the individual to maximise independence.

THE BIDET SHOP

Stand 95

www.thebidetshop.co.nz/

+64 9 320 3426



We are the largest retailer of Bidets in New Zealand, we specialise in supplying a wide range of Bidets to suit differing needs. The range of Bidets encompasses: the basic cold water Bidets through the mid-range with side control to the most sought after remote control models. Here at The Bidet Shop we are passionate about customer service and our desire to ensure that our customers purchase the Bidet most suitable for their wants and needs. This also resonates with our impressive warranty system ensuring that our customers are looked after for the long term. Over the years many of our customers have returned to purchase additional Bidets for their homes or to upgrade to the latest in Bidet technology. We are proud of the number of sales we gain from customer referral as once people experience the benefits of a Bidet they are sure to share this knowledge with their friends. Bidets are often referred to as washlets, bidettes or Japanese toilet seats.

THERMOMIX

Stand 70

www.thermomix.co.nz/

Phone: 0279027829



The Thermomix® TM6 is a simple assistive technology that can help users enjoy the confidence and capability to prepare fresh, delicious, nutritious meals at home. Thermomix® creates more independence in the kitchen by combining 20 cooking appliances into one compact unit. It brings more variety to every day with recipe inspiration, helps create menu plans and write shopping lists, and makes cooking favourite foods as easy as pressing 'next'. Thermomix® is also an extra pair of hands for carers and is fantastic for managing food allergies, food intolerances as well as soft food requirements and choking risks.

TLC4U2 IN HOME CARE & TLC4U2 BEACHLANDS RESORT

Stand 51

www.tlc4u2resorts.co.nz/

info@tlc4u2.co.nz



tlc4u2 In Home Care tlc4u2 is here to support you and your whānau/family with professional, quality, and fully-personalised home care services throughout the Northland and Auckland regions. We work in consultation with clients, their whānau/family, and support workers to develop and continuously tailor services to meet the needs of the client. We provide a range of tailored home care services including: • Respite Care • Serious Injury & ACC Funded Care • Restoration Care • Rehabilitation Aged Care • Dementia Care • Overnight & Hourly Care • Palliative Care tlc4u2 Beachlands Resort Located in the picturesque coastal suburb of Auckland, tlc4u2 Beachlands Resort offers accessible holiday, short stay and/or temporary accommodation options in a modern, spacious and peaceful setting. The Resort features ten fully accessible bedrooms, which provide our guests and their whānau with specific spaces that are tailored to meet the needs. This ensures that guests have the flexibility to create the type of stay and level of support that works for them. We have qualified support staff who can assist you with all your individualised care needs, should that be required. Whether you are needing a space to recover, accommodation while your housing modification is taking place or looking to have a weekend getaway. Beachlands Resort can create a package to suit, including accessible transport on request.

TUKI DESIGN CO.

Stand 69

<https://www.tukidesign.com/>

Email: paul@tukidesign.co.nz



Tuki Design Co specialises in the design, manufacture, service and rental of mobility products. With the user at the center of everything we produce, our focus is to provide innovative and beautiful designs tailored to the client. Tuki began manufacturing custom sports-chairs in 2004 under the name RAM. In 2009 the name was changed to Tuki to reflect the company's kiwi roots. Tuki then expanded its range manufacturing not only sports chairs, but the highest quality day chairs, shower commodes, prone trolleys, accessories and customised options for power chairs. Our in-house CNC capabilities and upholsterer also allow us to provide solutions beyond wheelchairs, From shower transfer seats to vehicle adaptations. Tuki's skilled team of fabricators are licensed to carry out maintenance and repairs on all products.

WILSON HOME TRUST

Table 4

<https://wilsonhometruster.org.nz/>

Email: info@wilsonhometruster.org.nz or 0800 948 787



The Wilson Home Trust is a registered Charitable Trust who support children and young adults (up to 21 years) with physical disabilities and their families, in the upper half of the North Island. Established nearly 84 years ago, the Trust's aim is to enhance the lives of physically disabled children and young adults (The Trust's beneficiaries). We do this in many ways including providing information and support, services such as activities, and financial support by way of grant funding.

WS MEDICAL

Stands 64 - 65

www.wsmedical.co.nz

sales@wsmedical.co.nz



At WS Medical, we specialise in providing high-quality rehabilitation solutions designed to enhance patient comfort, support therapists, and improve clinical outcomes. With a strong focus on innovation and practicality, we offer a wide range of products that empower healthcare professionals and caregivers to deliver the best possible care.

For the ATSNZ Expo, we are proud to showcase our Modular Rise Recline Chairs, Mobile Hoists, and Transfer Equipment. Each product in our range is engineered with the needs of both patients and healthcare providers in mind, ensuring functionality, safety, and ease of use. Our Approach: At WS Medical, we pride ourselves on being more than just suppliers. We work closely with therapists and caregivers to understand their challenges and provide tailored solutions.

Our focus on modular design and ergonomic innovation ensures that our products are adaptable to different clinical environments and patient needs. We're also committed to offering outstanding service. Whether it's providing trial options, offering expert clinical advice, or ensuring quick and reliable delivery, WS Medical is dedicated to helping healthcare professionals improve their workflows and patient outcomes.

The award winning

Omeo is changing lives!



With it's cool design, innovative technology and seat steering control driven by self-balancing technology. The Omeo is Kiwi made and designed for both indoors and outdoors, giving new levels of freedom and independence to customers globally.

Come and check us out at booths 3 & 4!

Contact us for further information and to organise a trial with an Agent near you.



omeotechnology.com
hello@omeotechnology.com



Worried that you might miss a nocturnal seizure?



Come visit the Te Wana Ltd stand!

We supplies a range of sensors that can detect:

- Shaking
- Changes in breathing
- Vomiting
- The audible sounds of a seizure
- Incontinence



The Guardian and Companion come with a free app that can record the number, level and intensity of seizures

All devices are manufactured in the UK to the highest standards with 3-year warranties.

021 438 067 sales@TeWanaLtd.co.nz www.TeWanaLtd.co.nz

Te Wana Ltd
Technologies that Care

Professional Seminar Series Programme

Wednesday 06 November 2024

Room 1

TIME	ABSTRACT
9.00am - 9.45am	<p>Independence Redefined! Maximizing Function Through Power Wheelchair Electronics and Environmental Controls</p> <p>Andrew Lopez</p> <p>Power wheelchairs feature some of the most advanced electronics in the complex rehab industry, aiming to maximize user independence through enhanced mobility and comfort. But could they do more to improve overall independence? Despite its value, Bluetooth technology remains vastly underutilized, even though most manufacturers have incorporated it into expandable electronics. This seminar will explore the powerful potential of Bluetooth technology and how it can be integrated with readily available smart technology and environmental controls to maximize user independence.</p> <p>By the end of the session therapists will have an understanding of:</p> <ul style="list-style-type: none">- Types of devices that can be purchased through the consumer market.- Which users would benefit from environmental controls.- Setting up users for successful use of environmental controls.

10.15am – **Advancing evidence-based practice to support children
11.00am and young people’s motor vehicle transport**

Jamie Cockle and Helen Lindner

MACA is a not for profit organisation leading an unprecedented research and work program which is building a new evidence base - improving vehicle transport for children with disabilities and medical conditions.

Medifab and MACA will share their experience of working together over the past five years and how evidence is showing this collaborative approach is advancing evidence based practice.

This presentation will cover recent research, training courses to support clinicians and product consultants, and a world leading crash testing program for specialty vehicle restraint systems. It will also provide an overview of new training courses for New Zealand, and the development of the first accreditation program for ATP’s working in this high risk field.

MACA Chief Executive Helen Lindner and Medifab Clinical Educator Jamie Cockle will share some of these exciting new developments. Discover how you can apply evidence-based practice in this rapidly evolving environment.

Morning Tea & 5 min Exhibitor Showcase in Expo Hall

TIME**ABSTRACT**

11.45am -
12.30pm

The future of prescription: What role will AI play**Tracee-lee Maginnity**

One of the biggest technological advancements currently facing industries globally is the implementation of Artificial Intelligence (AI). What can AI offer in the area of prescribing AT? Is it a tool that can assist in the ever-increasing amounts of report writing associated with the justification processes of prescribing Assistive Technology? Can it assist us manage the paperwork demands? What are some of the advantages and disadvantages of using these technologies to complete funding justifications?

This session will provide a historical understanding of the development of AI and consider the ways in which it may be applicable to current practice. Discussion on the foundations of clinical reasoning will guide the group in considering the role AI may play in future prescription processes.

Lunch & 5 min Exhibitor Showcase in Expo Hall

1.45pm -
2.30pm

Pressure and Posture Care in Lying: Which one to address first?

Claire Grey

Clients with complex and continuing healthcare needs face a silent, ongoing battle—unseen changes in body shape and increased risks of pressure injuries while lying in bed. These issues can develop slowly over time, affecting individuals with limited mobility, regardless of diagnosis or age.

Join us for an insightful session where we will explore essential strategies to protect clients from the risks of static, destructive postures and safeguard their skin. We'll delve into pressure care principles, the importance of selecting the right support surface, and the use of therapeutic positioning systems.

Grounded in the latest clinical evidence and international guidelines, this session will encourage a re-evaluation of your current practices, ensuring the best possible care for those with increased sensory and postural needs. You will gain practical insights and tools to enhance your clinical approach, addressing the intertwined challenges of pressure and posture care in lying.

Discover how to prioritize and balance these critical aspects to improve client outcomes, prevent complications, and provide comprehensive care. This session is designed to equip you with the knowledge and confidence to make informed decisions, ultimately enhancing the quality of life for your clients.

Afternoon Tea & 5 min Exhibitor Showcase in Expo Hall

TIME**ABSTRACT**

3.00pm -
4.00pm

Accessible**Sarah Moyle and Amy Stonestreet**

Members of the Accessable Advisory team will discuss the Ministry's Equipment and Modification Service eligibility and criteria.

They will also outline the advisory process and what information is required in advice submissions to support a smooth process through to service request.

Room 2

9.00am -
9.45am

Equality for the Ageing: Ensuring Access to Assistive Technology for the Aged Care Population**Tracee-lee Maginnity**

Global census and survey data tells us that the world population is not only growing, but also living longer due to improved access to health services and medical and technological advances. Research also confirms that the use of assistive technology is highly effective at improving functional abilities, reducing the risk for costly medical complications, and reducing caregiver burden. However, despite these known benefits, a gap remains between access to assistive technology for younger people as compared to access given for the ageing population. Attitudinal biases exist among certain medical teams and funding agencies regarding the needs of the older adult regarding assistive technology.

This presentation will examine the current approach to power mobility access for older adults with functional impairments related to the ageing process in New Zealand; take a focused look at power mobility and seating and positioning for the ageing person with disability, and will present research-based best practice recommendations for clinical application.

TIME**ABSTRACT**

10.15am - **Through Their Eyes: Young Members of Disability Sport Auckland Share Their Stories**
11.00am

Marcus Jones, Lexyan Kulatea-Ryan and Sally Barkman

Disability Sport Auckland is founded on the vision of enhancing the lives of all disabled Aucklanders, and the mission of delivering and connecting them to quality opportunities in sport, recreation, and play. These opportunities have a profound impact as many of our community members meet others on similar journeys with shared goals and aspirations. Our members often develop deep passions for their sports, continually exceeding all expectations and seeing no barriers to their progress. Our organisation thrives because of our members, therefore they must be the ones to tell the story of their lived experiences with disability. These narratives highlight the opportunities sport have provided, the expectations they continue to surpass, and the growth in their confidence. By sharing these stories, we aim to inspire younger generations that will embark on similar journeys.

Morning Tea & 5 min Exhibitor Showcase in Expo Hall

11.45am - **A clinicians guide to prescribing ultra-light manual**
12.30pm **wheelchairs**

Bianca Brady

What does it mean when you hear the term ultra-light manual wheelchair and how does this set up the user to promote propulsion efficiency and facilitate mobility and functional goals long term?

Clinical guidelines that support the use of the lightest adjustable wheelchairs for the preservation of the upper limb are available to us. As prescribers and suppliers of these chairs, it is important to consider these evidence-based recommendations when investigating wheelchair weight and configuration. Making informed decisions when selecting a wheelchair and components as well as implementing best practice recommendations during the set up can result in great functional gains for the user.

This session will provide a greater understanding of the clinical evidence and best practice guidelines regarding wheelchair weight and configuration with a focus on 5 needs to know areas. This will help promote long term benefits for the user and help avoid common issues encountered.

Lunch & 5 min Exhibitor Showcase in Expo Hall

1.45pm -
2.30pm

On Air & Online - Media & My Life With Cerebral Palsy

Kris Edwards

Just when I thought i had it tough.....

When I was 5 years old they told my parents to put me in a mental hospital because they said I would never learn anything and I would become a vegetable, I was there until I was 13 years old.

From an introverted kid who delivered pamphlets {at \$20 per thousand}

The idea of becoming a radio DJ was born, I could hide in a studio playing music.

From a 17 year old to being part of the senior leadership running and programming the Number One music radio station in New Zealand - The Breeze.

Over the years mixing with the world's biggest stars - Rod Stewart, Michael Buble, Robbie Williams, Ronan Keating to name a few.....

This year i have launched;

The Cerebral Palsy Podcast - featuring people who live and deal with CP every day.

The Para Podcast - the incredible athletes who have fought through adversity to re[reset our country at the Paralympics in Paris!

I tell my story with honesty, humility & humor.

Afternoon Tea & 5 min Exhibitor Showcase in Expo Hall

3.00pm -
4.00pm

Life is a Piece of Art- The Journey of a disabled Mother and her disabled Daughter

Yi Liang Small

Yi is a Chinese who has lived in New Zealand for 20 years. This is a personal story but everyone can relate to. When Yi became disabled after contracted Polio at the age of two. How Yi's mother determined her future to thrive and enabled she travelled the world and then settled in New Zealand. Later, Yi became a mother for a girl, who was diagnosed with intellectual disability when she was born.

Yi's journey with her daughter, cultural shock on how to define the disability. How she adapt to Kiwi culture for supporting her half Chinese half Kiwi disabled daughter, and overcome whatever the life throw to her. She keeps optimistic and enthusiastic.

Yi advocates for herself and her daughter, raising the awareness by speaking on disability rights for other disabled people and whānau.

New Zealand disability community is dedicating to lead better lives by embracing the Enabling Good Lives Principles. In her presentation Yi will focus on how to practice for the better lives of herself and her daughter beyond her Chinese and Kiwi cultures, adapt the change, build resilience through self-determination on the mana of EGL principles.

Hope this presentation will bring the insight how cultural diversity alongside EGL principles to enhance our lives when we support ourselves and our disabled children.

8.45am -
9.30am

Unique power functions that create client centered solutions

Jacelyn Goh

Often the difference between disability and ability is the application of assistive technology that matches the unique functional abilities of our clients. There have been many advances in technology for how individuals who use powered mobility can add on specialised seating functions and controls to enhance their participation in the world that surrounds them.

Join us to explore the clinical applications of powered lateral tilt, latitude (seat to floor), anterior tilt and standing functions; along with alternate drive control systems, that through clinical application, have vastly improved the quality of life for the unique individuals we will showcase through our clinical studies. We will explore the research available to assist in our decision making and ensure we use outcome measures that showcase client centered processes aren't lost in a tick box society.

10.00am - **Upcycling in Tonga**
10.45am

Jacqueline Abel and Sue Fairhall

Have you ever wondered what happens to donated or equipment that cannot be reissued in New Zealand? Since 2005, Altus Pacific Aid has collaborated with several Pacific Island communities to provide complex wheeled mobility, postural seating and lying solutions. The COVID-19 pandemic disrupted annual mobility clinics in Tonga, rendering much of the previously donated equipment unreliable or beyond repair and in dire need of replacement.

Altus Pacific Aid partners with the Mango Tree Centre in Tonga, which networks with the local disabled community there. The Centre hosts annual wheelchair and seating clinics, where assessors and technicians from NZ refurbish and upcycle donated mobility equipment for those in need.

This presentation will highlight the recent volunteer work completed at the wheelchair and seating clinic in Nuku' alofa, Tonga (2023/ 2024) and comment on future goals for wheelchair and seating clinics and other aspects of work done by Altus.

Morning Tea & 5 min Exhibitor Showcase in Expo Hall

11.15am - **MND: Maintaining independence through power mobility.**
12.00pm

Deb Wilson and Helen Lappin

Motor Neurone Disease (MND), is a progressive neuro-degenerative disease affecting the motor neurones of the brain and spine. The prevalence in New Zealand is thought to be higher than the international average with approximately 400 people living with MND at any one time. Symptoms can include muscle weakness, spasticity, fasciculations and atrophy which progress throughout the course of the disease. Symptoms can initially present as stumbling or foot drop, difficulties with swallowing or speech, reduced dexterity and/or weak grip, and less commonly breathing problems or behavioural and cognitive changes.

In addition to supporting mobility and participation, early access to power mobility is an important strategy for muscle preservation. This session will review MND symptoms at onset and the importance of understanding the likely progression when selecting a power mobility device, alternative drive control options and programming parameters to accommodate for future changes.

Lunch & 5 min Exhibitor Showcase in Expo Hall

1.00pm -
1.45pm

“It isn’t working”: Exploring options once a wheelchair has been delivered

Tracee-lee Maginnity

Whether you were the original prescriber or have just met the client conducting regular seating and wheelchair reviews can be complex with psychosocial, best-practice, time-restraints, and cost considerations. If then, you hear the dreaded “it isn’t working” relating to a cushion, wheelchair or even a key accessory, it can be overwhelming to know what to do.

Join us as we explore the when, the why and the how of wheelchair reviews to empower the user to maximise their AT outcome. We will also explore the importance of wheelchair reviews, including the frequency and key things to look out for.

2.00pm -
2.45pm

Considering Cushion Selection – How can we use ISO testing data to assist in the process.

Tracee-lee Maginnity

ISO Cushion standards are based on objective, scientific laboratory analysis of support surfaces. These tests measure the critical characteristics of wheelchair cushions. Can these tests contribute to evidence based practice to assist in the clinical reasoning processes when determining potential solutions?

How can this standardised, lab-based data be considered along with the needs and goals of the individual? What else do we need to consider when identifying cushion most appropriate for an individual users? Come along and join us in this session where we will deep dive into the concepts and uses of ISO testing to support clinical reasoning.

8.45am -
9.30am

Considerations for robust power wheelchair prescription

Jacqueline Abel

Prescribing a power wheelchair requires assessing the user's environment to ensure optimal mobility and safety. Key factors include indoor vs. outdoor use, where indoor wheelchairs need excellent maneuverability, a small turning radius, and compatibility with various floor surfaces. Outdoor wheelchairs must be durable, with good suspension, stability, and long battery life. Terrain type influences the need for robust features like larger wheels for rough surfaces. Accessibility considerations include home compatibility with ramps and doorways and community access via public transportation. The user's lifestyle, activities, and weather conditions dictate additional features for work, school, recreation, and all-weather use. Storage and transportability are essential, considering ease of disassembly and storage space. Physical and cognitive abilities require appropriate control systems and support, while battery life and convenient charging are crucial for daily use. Maintenance, warranty, and local service availability ensure long-term reliability. These factors make power wheelchair selection more relevant to the client experience and will be discussed during this session to assist therapists with power wheelchair prescription.

10.00am - **Artificial Intelligence Training for Disabled People and**
10.45am **Allies**

Tim Young

Artificial Intelligence (AI) is changing the world. It has the potential to reduce inequality or massively increase inequality. The outcome will depend on how educated disabled people and allies are on how to use and not use AI.

AI can be useful for disabled people in various ways, such as providing a personal assistant, increasing productivity at work, helping with communication, and automating smart homes. AI can enable people with disabilities to access information, services, and opportunities that would otherwise be inaccessible or difficult to use. AI can also empower people with disabilities to express their creativity, preferences, and opinions.

AI is very powerful and can be used for good, but it can also be dangerous. Disabled people, and allies in the disability sector need to be aware of how it can affect your life negatively to be able to get the most out of it. Knowing about the potential downsides of AI helps people make smart choices about using AI, guides the creation of rules to keep AI safe and fair, and helps prevent harm. Additionally, it prepares us to handle job changes caused by AI and ensures that AI benefits everyone equally, not just a few. Overall, understanding AI's negative impacts helps us use this technology in ways that are good for society and fair to everyone.

Morning Tea & 5 min Exhibitor Showcase in Expo Hall

11.15am - **Assistive Technology, Discrimination and the Law**
12.00pm

Nick Johnston

Auckland Disability Law is a Community Law Centre that has the specific focus of supporting the Deaf and disabled community when they encounter legal issues related to their disability.

One of the many barriers disabled people face is discrimination around their adaptive technology. This occurs across many areas of life, from employment, to accommodation, and even just going about their daily business. This presentation will discuss the law around disability discrimination in New Zealand, with a particular focus on what the law says about assistive technology.

We will talk about the law around reasonable accommodations for disability, and explore the options available to people who feel they have been discriminated against, including how both Auckland Disability Law and the Human Rights Commission can help.

Lunch & 5 min Exhibitor Showcase in Expo Hall

1.00pm -
2.30pm

Addressing Paediatric Hip Health: Practical Approaches for Positive Outcomes

Jamie Cockle

Navigating the complexities of paediatric hip health is essential when working with children with neurological impairments and disabilities. This session delves into the prevalent challenges associated with hip joint issues and their secondary complications in this population. We explore the significance of consistent postural support throughout the day and night, coupled with opportunities for weight-bearing and active movement in promoting optimal hip health.

Join to unravel the intricacies of hip development and health within the neurodisability population. The focus extends beyond theory to practical considerations, highlighting the essential balance between 24-hour movement and 24-hour postural care. Gain insights and actionable strategies to make a positive impact, paving the way for a healthier future.

2.00pm -
2.45pm

Standing Tall for Health and Participation

Mellinda Clarke

Supported standing for children and adolescents with physical disabilities has research-based health benefits that can deliver positive outcomes to promote quality of life. However, there are many considerations and key practice guidelines that need to be addressed to make the best choices in frame scripting, set up and use.

This session will focus on reviewing the up-to-date research in this area of practice, highlighting the benefits of standing as a whole and the wider implications for physical programmes, as well as how to implement the key practice guidelines. Considering both approaches of early intervention and planning for challenging postures with the practical implications, let's take a closer look at supported standing and its importance in promoting function, participation, and health for all.

Speakers



Jacqueline Abel

Jacqui Abel is an Occupational Therapist who holds a Post Graduate certificate in Health Professional Education from Auckland University of Technology. With over 20 years of experience as an Occupational Therapist, she has held clinical and leadership roles in both the public and private sectors across South Africa and New Zealand. Jacqui has specialized in spinal cord injury rehabilitation, gaining extensive experience in this field. Her interests include complex wheelchair and seating, equipment provision, and spinal cord injury rehabilitation. She has achieved WMPM Level 3 with a customised fabrication endorsement and has served on the Enable Accreditation panel for wheelchair seating accreditation. Jacqui worked as a Professional Advisor with Accessable for 2 years and currently contracts with Specialist Rehab Services, focusing on complex wheelchair and seating assessments and equipment prescription.



Bianca Brady

As an occupational therapist, Bianca began her career in physical rehabilitation where her passion grew for working with neurological conditions and physical challenges that impact daily life. Bianca has worked with NSW Health and as a community-based therapist. Her current role as Clinical Educator for APEX Mobility brings together 15 years of experience in tailoring solutions to suite individual needs and her passion for education. She joined the APEX Mobility team to focus her experience and skills in providing learning opportunities for seating and wheeled mobility. She remains an advocate for people who access care and support to achieve life goals with assistive technology as well as serving to provide opportunities to foster growth and learning for others.



Mellinda Clarke

Mellinda is an experienced physiotherapist of 24+ years with a strong paediatric and disability focus throughout her career and a passion for helping both children and adults achieve their goals. Her work began with the Cerebral Palsy League in Brisbane and then a move to New Zealand where she worked across a Child Development Unit, a hospital for the elderly, a Physical Disability Unit within a regular school, 10 years with Ferndale Special School in Christchurch, and then 7 years as Team Leader and Clinical Lead and Training Supervisor for Wheelchair and Seating with an international private rehabilitation firm APM Workcare NZ. The move back to Australia brought a shift to an Assistive Technology Consultancy role, and then her current role with Apex Mobility as a Clinical Educator. Here she focuses on education in the Assistive Technology and disability sector, where through clinical education she aims to continue to help people young and old and their families live their best life.



Jamie Cockle

Jamie is the paediatric clinical educator for Medifab, one of the largest importers and manufacturers of paediatric Assistive Technology (AT) in Australia.

Upon graduating from his Physiotherapy BSc, Jamie immediately specialised in paediatrics, spending the early part of his career working in acute hospital settings within the NHS in England and Wales. During this time, he developed a passion for Neurological disability and rehabilitation, working closely with children and their families throughout their hospital journey and beyond.

Today, Jamie supports clinicians across Australia and New Zealand to develop their knowledge and skills, delivering a range of paediatric focussed clinical education in a variety of settings. He is passionate about AT and what it offers for children by ensuring that no matter of their impairment, they have opportunities to be well supported as they grow

and develop. Jamie aims to build confidence and assist all stakeholders he works with to get the best from AT, supporting children to be active and participate in what's important to them and their family.



Kris Edwards

Award Winning Radio Presenter & Programmer

Senior Manager at The Breeze Radio Network

2023 NZ Radio Award Winner

Co-Creator/Host - The Cerebral Palsy Podcast & Para

Podcast {para athletes - released August 12}

1st degree black belt in Aikido

Sue Fairhall

Sue Fairhall is an occupational therapist who has a passion for postural care, wheelchairs and the development of sitting and lying ability. Sue has worked in this field for over 25 years with a background working in the community, as a pediatric OT and as a VNDT. Sue has had opportunities to use and grow her skills as a Charge OT, Seating specialist and educator for an international company, lecturer at AUT, professional advisor for 10 years and on the accreditation panel for wheelchairs and seating and been involved in product development. Sue currently contracts to Specialist Rehab Services doing complex wheelchair seating and equipment solutions. Sue serves on the management team for Altus Pacific Aid and has been working in the Pacific islands running education sessions and wheelchair clinics for 17 years.



Jacelyn Goh

Jacelyn (better known as Jace) is an Occupational Therapist with extensive experience and expertise in neurological rehabilitation. After graduating from La Trobe University in 2008, she began her career in Singapore, working in acute and rehabilitation settings. Over the years, she has gained valuable experience by working in various countries and healthcare systems.

Ten years ago, Jace moved to Melbourne, Australia, where she continued her career as an Occupational Therapist. During this time, she worked in both

public and private settings and gained experience in the National Disability Insurance Scheme (NDIS) sector, working with diverse client groups.

In 2021, Jace joined the team at Linds Rehabilitation where she holds the role of product representative and clinical educator. Her specific interest lies in complex wheelchair seating and prescription. In her current position, she provides consultation and conducts education sessions to assist other occupational therapists in their wheelchair prescription process.

With her extensive knowledge of Occupational Therapy and her focus on neurological rehabilitation, Jace plays a vital role in helping other therapists optimize their wheelchair prescription techniques and ensure clients receive the most suitable mobility outcomes.



Nick Johnston

Nick Johnston is Community Educator at Auckland Disability Law, and responsible for ADL's legal education programme in the Auckland and Northland regions. Nick is a former occupational therapist, and his years spent supporting stroke survivors back into employment and witnessing the challenges they faced first hand has fuelled his passion for social justice and his desire to ensure that everyone knows of their rights and obligations under the law.



Marcus Jones, Sally Barkman and Lexyan Kulatea-Ryan

Disability Sport Auckland will present with Sally Barkman, a 20-year-old wheelchair racing competitor and Lexyan Kulatea-Ryan a 10-year-old who participates in many of our activities. They have been members of our organisation for 4 years, with lived experience of disability.

Sally is pursuing a career in wheelchair racing. She understands the value of introducing and providing quality opportunities for sport and recreation to people living with disabilities, especially from a young age.

Lexyan has developed great confidence and built lasting relationships with his peers who have similar life experiences, through being involved with sport, recreation and play.



Helen Lappin

Helen Lappin: Following graduation from Otago Polytechnic in 1998 as an Occupational Therapist, Helen worked in New Zealand, Australia and the UK in several practice areas including elderly rehab, neuro rehab, and assistive technology. Since returning to New Zealand in 2008, she has been working solely as a Seating and Wheelchair Therapist for Te Whatu Ora and more recently for the Laura Fergusson Brain Injury Trust. Helen contributed to the New Zealand MND Best Practice Recommendations and is a member of the MoH credentialing panel for wheeled mobility and postural management.

Helen Lindner

The founder and CE of MACA, Helen is a leading global road safety and policy expert for the transport of children with disabilities and medical conditions in motor vehicles.

Helen is represented on Australian Standards committees for child restraints and seatbelts and led the review of the 2013 Australian/New Zealand Standard 4370 Restraint of children with disabilities, or medical conditions, in motor vehicles.

She has a Master of Public Policy and Management, a Graduate Diploma in Administration of Child and Family Programs, a Diploma of Teaching and a Certificate IV in Workplace Training and Assessment.

<https://www.linkedin.com/in/helen-lindner/>



Andrew Lopez

Andrew Lopez is an Occupational Therapist specialising in Complex Seating and Wheelchair Prescription. Over the last six years, Andrew has established himself as a passionate Assistive Technology specialist, with a strong

emphasis on optimizing seating and mobility outcomes. Andrew's recent career advancement has led him to join Quantum Australia as a Product Specialist and Clinical Educator for NSW, where he can share his passion in educating others in the realm of wheelchairs and seating.



Tracee-lee Maginnity

Tracee-lee Maginnity joined Permobil Australia in July 2019, as a clinical education specialist. Originally from New Zealand, she graduated Auckland University of Technology with a BSc (Occupational Therapy) in 2003 and has since worked in various roles related to seating and mobility including assessing, prescribing and educating. After gaining experience as an assessor and prescriber, prescribing for both disability and injury. She moved to Australia in 2011 to take on the Senior Occupational Therapist role in an NGO custom moulded seating service. She then worked in clinical consulting and education roles until joining Permobil. Tracee-lee is passionate about maximising functional outcomes with end users and the importance of education within the industry. Tracee-lee has presented at conferences, expos, rehab centres, hospitals and universities both locally and internationally. She has also been part of working groups providing feedback to government initiatives both independently and with local organisations. She has mentored many therapists interested in AT and was part of the pilot competency program now a requirement for prescribing therapists in New Zealand. Her experience includes working with individuals with complex postures to achieve customised client focused outcomes and working holistically to ensure best user outcomes.



Joana Santiago

Joana Santiago is the Head of Clinical Education for Medifab. She completed her degree in Occupational Therapy in Portugal and soon developed a passion for Posture Care and Wheelchair Seating & Positioning. With more than 15 years of experience, Joana takes pride in her flexible capability to reach good clinical outcomes by

considering the individual needs, wants, and expectations of those she works with. Joana is based in Australia where she primarily assists clinicians by sharing her knowledge and expertise through education and mentoring programs. Furthermore, she positively influences the development, supply, and training of Medifab's extensive range of products.

She is a specialist in her field and has presented at a variety of national and international conferences, around the world.



Yi Liang Small

Yi has 11 years of working experience with/for people with learning/intellectual disabilities. She is a Team Leader for the North Island team of the organisation she works for. She has facilitated many projects.

Yi has a physical disability from Post Polio Syndrome, a wheelchair user and her daughter has an intellectual disability.



Deb Wilson

Deb Wilson is an Occupational Therapist with over 30 years clinical experience. She is the Training Lead of Seating To Go, a leading wheelchair and seating assessment, training and repair service in New Zealand. In 2009, she helped develop the NZ Ministry of Health (now

Whaikaha – Ministry for Disabled People) wheeled mobility and postural management credential for occupational therapists and physiotherapists. She is the NZ Chair for OSS and has contributed to capacity building in the Pacific Islands with Motivation Australia and Altus Resource Trust. Deb was a member of the ISWP Wheelchair Educators Package Development Group.



Tim Young

Tim uses his experience to improve outcomes and opportunities for disabled people in his role as Chief Executive of My Life My Voice. My Life My Voice facilitates a Peer Support Network nationwide, a

Kaitūhono/Connector service in Mid-Central, and trains disabled people in how to use Artificial Intelligence.

Tim Young is the CEO of Smart Access, which has developed a navigation system for disabled people and other pedestrians. Tim started his business, which focuses on improving infrastructure accessibility, after facing many obstacles and uncertainty when travelling around the country as a tetraplegic and wheelchair user.

Tim has completed a MSc in Psychology, developed an educational video game, a work placement program for disabled job seekers, and Co-founded the Magical Bridge Trust to build more accessible playgrounds.

Exhibition Floorplan

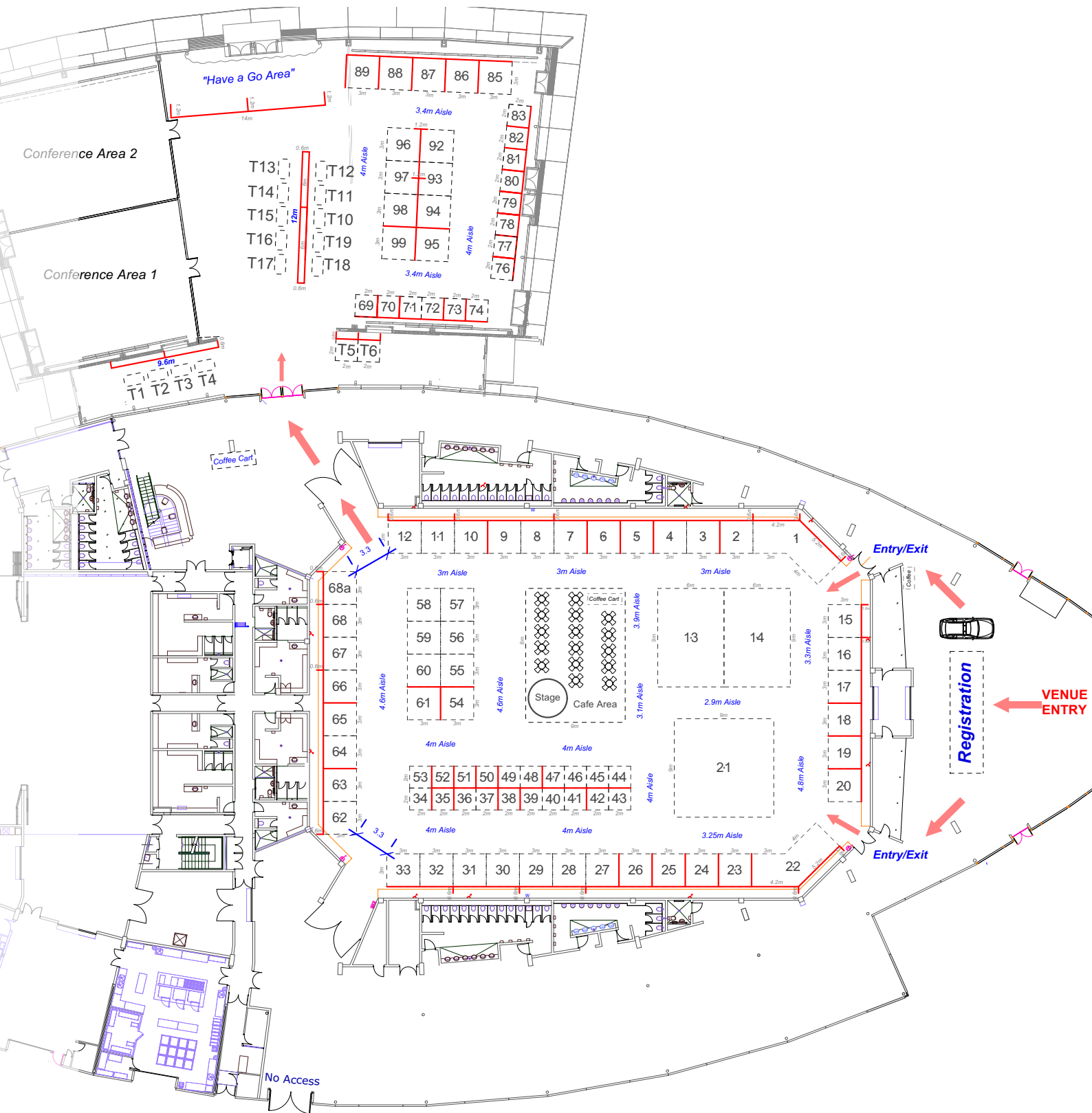

Exhibitor

Exhibitor	Stand
Cubro	1 - 2
Omeo Technologies	3 - 4
Te Wana Ltd	5
Melrose Kiwi Concept Chairs	6
Medix 21	7 to 9
C1 South	10 to 12
Pride Mobility Products	13
Cubro	14-17
Mobility Centre	18
Grace Medicals	19
Complete Mobile Bathrooms	20
Medifab Pty Ltd	21
Active Healthcare	22
BQ Mobility	23
Healthvision	24
Acorn Stairlifts	25
Arjo	26
Permobil New Zealand Ltd	27-33
Avanos	35
Independent Living Charitable Trust	36 - 37
Link Assistive New Zealand AKL	38
Rehasense (NZ) Limited	39, 40, 41
Beachwheels NZ	42 - 43
Goldfern Mobility	44-47
SA Plumbing Supply	48-49
Access Community Health	50
tlc4u2	51
Portable X-Ray	52
Reid Technology Ltd	54
Invacare New Zealand	55 - 60
Mobility Supplies NZ	61
Rolapal Ltd	62, 63, 53, 34
WS Medical	64 -65
Allied Medical Ltd	66, 67 & 68a
Tuki Design Co	69
Thermomix	70
New Zealand ARC Health Limited	71 and 72
Access Advisors	73
Care On Call	74
IHC New Zealand – Stand Tall	76
Jands	78
Sensory Sam	79
Able Tech Services	80
Mentis Ltd	81
Ability Post	82
Moveme Health	83
Quinn Lifts & Elevators	85 - 86
Canterbury Concepts	91
Icare Medical Group	92-94
The Bidet Shop	95
NZ Health Group	96, 97, 98
Able Access	99
Headway - Brain Injury Auckland	Table 1
Independentlyou.com	Table 2
CCS Disability Action	Table 3
Wilson Home Trust	Table 4
AHS Security Hardware	Tables 5 & 6
Goodtouch Ltd	Table 10
Enable New Zealand	Table 11
MACA	Table 12
Accessible	Tables 13 & 14
People First New Zealand	Table 15
Muscular Dystrophy Association of NZ	Table 16
Better Days Rehabilitation	Table 17
Epilepsy First Aid	Table 18
Specialist Rehab Services	Table 19

Booth Number	Client
1 - 2	Cubro
3 - 4	Wheel Adventures
14 - 17	Cubro
5	Te Wana Ltd / Kitcal
6	Melrose Kiwi Concept Chairs
7 - 9	Medix 21
10 - 12	C1 South
13	Pride Mobility Products
18	Mobility Centre
19	Grace Medicals
20	Complete Mobile Bathrooms
21	Medifab
22	Active Healthcare
23	BQ Mobility
24	Healthvision
25	Acorn Stairlifts
26	Arjo
27 - 33	Permobil
35	Avanos
36 - 37	Independent living
38	Link Assistive New Zealand
39 - 41	Rehasense
42 - 43	Beachwheels
44-47	Goldfern Mobility
48 - 49	SA Plumbing Supply
50	Access Community Health
51	TLC4u2
52	Portable X-Ray
54	Reid Technology
55 - 60	Invacare
61	Mobility Supplies
63,62,53,34	Rolapal
64 - 65	WS Medical
66-68	Allied Medical
69	Tuki Design
70	Thermomix
71 - 72	New Zealand ARC Health Limited
73	Access Advisors
74	Care on Call
76	Stand Tall
77	Rongoā Māori
78	Jands
79	Sensory Sam
80	Able Tech Services
81	Mentis
82	AbilityPost
83	MoveMe Orthotics
85 - 86	Quinn Engineering
89	Canterbury Concepts Grab Rails
92 - 94	Icare Medical Group
96 - 98	Geneva Healthcare, Healthcare NZ, NZCL
95	The Bidet Shop
99	Able Access



Contact Us at the Expo



events@iconevents.co.nz
or
ingrid@atsnz.org.nz

www.atsnzexpo.nz