



Is **BLING** Better?

Delivering urban street design in changing times



ALAN GRAY

Principal / Urban Designer



MEGAN WALKER

Principal / Landscape Architect



Bridge Street, Whakatū Nelson

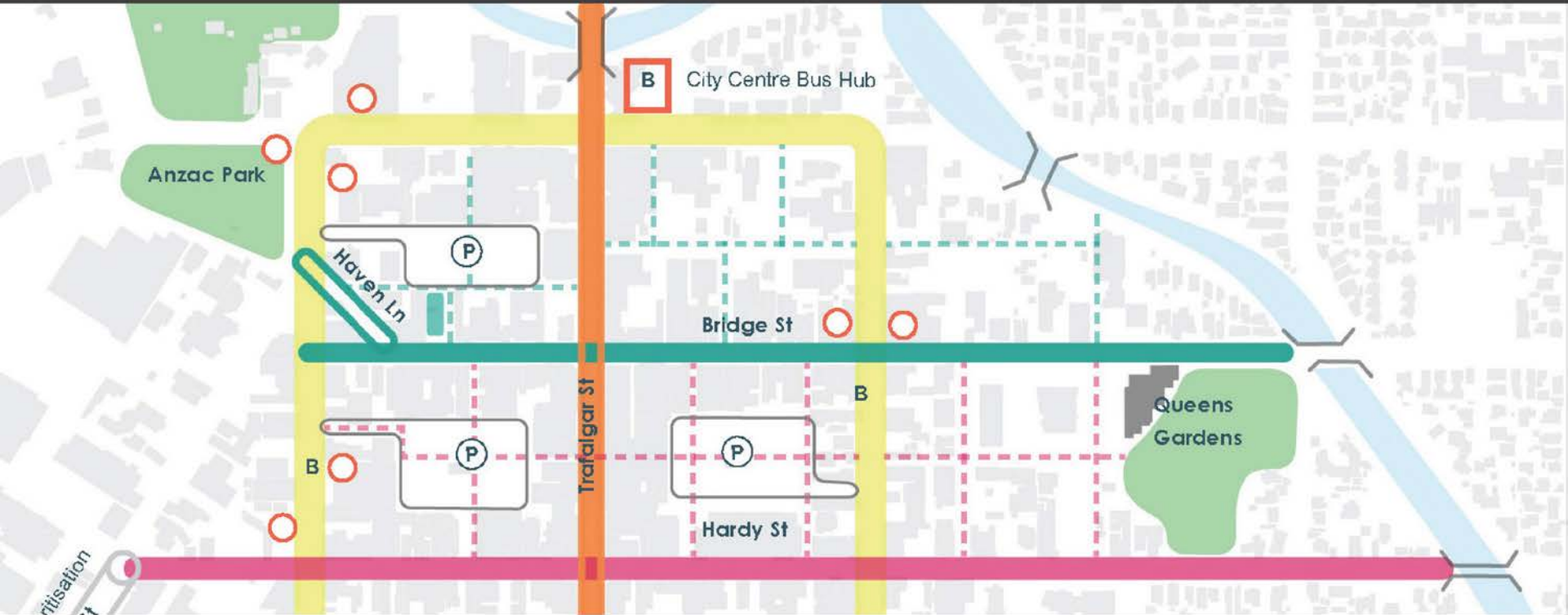

Changing Context



**CLIMATE
RESPONSE**



**FUNDING
PRIORITIES**



**RATES
CAPS...?**

ETC.

Changing Context

NELSON WEATHER EVENT



\$36MIL FOR INFRASTRUCTURE

LOCAL ELECTION

GENERAL ELECTION

LTP

GPS LAND TRANSPORT

LOCAL ELECTION
4% RATES CAP

2020 2021 2022 2023 2024 2025 2026 2027



STRATEGY



SCHEMATIC DESIGN



CONCEPT TO DETAILED DESIGN



CONSTRUCTION

WE ARE HERE

Te Ara o Whakatū - NCC



2021



Schematic Design

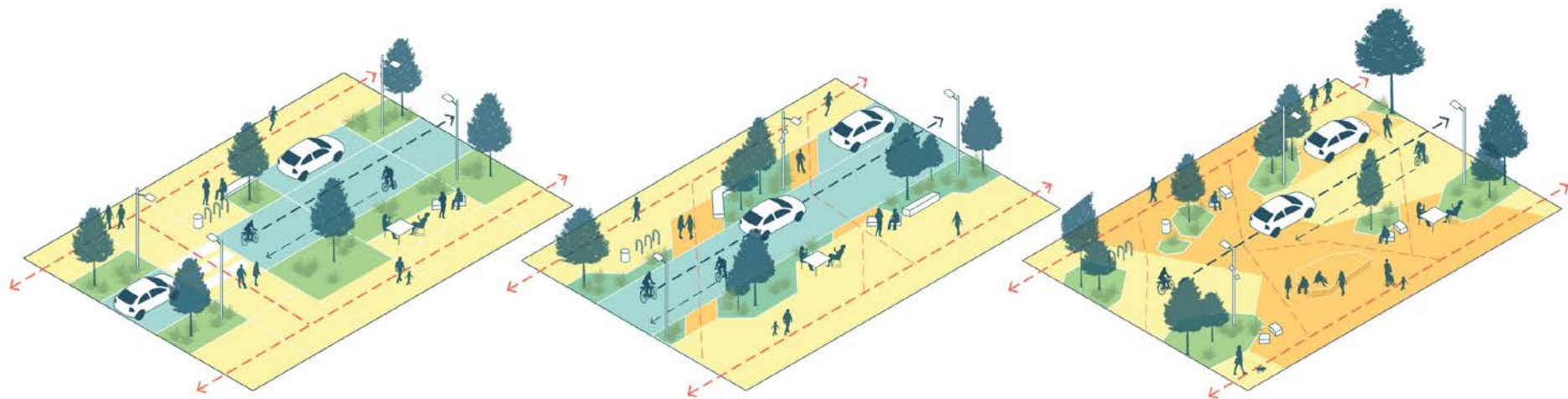

Disrupting the linear

Channelised

Hybrid

Fractal



2022



Schematic Design



2022

Concept Design



2023

Detailed Design

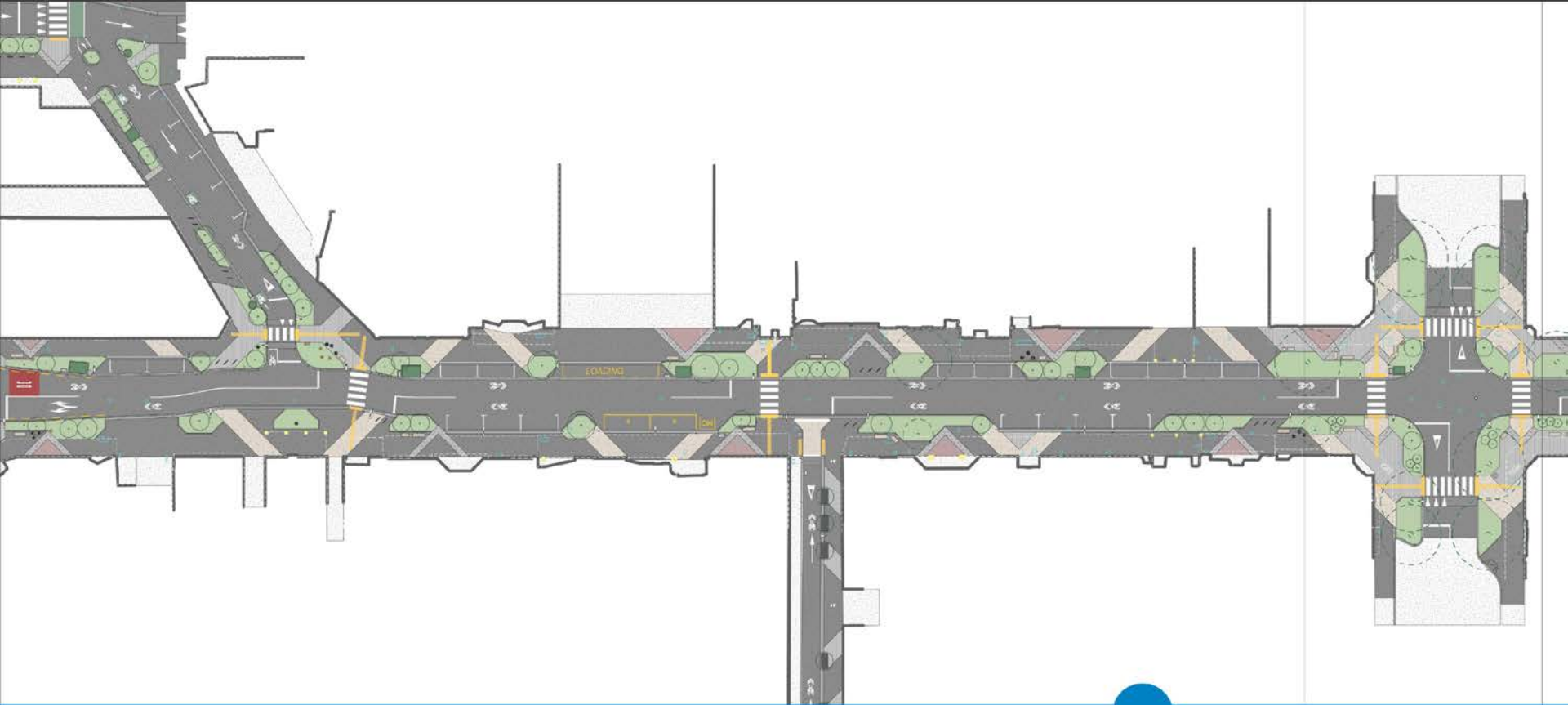

2025

Learnings from Bridge St



1
**Focus
Investment**



2
**Flexible
Design**

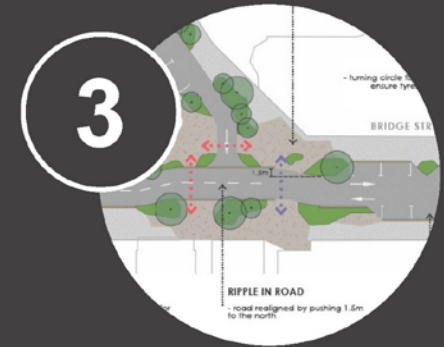

3
**Spatial
Allocation**







4
**Leverage
'Need-to-haves'**

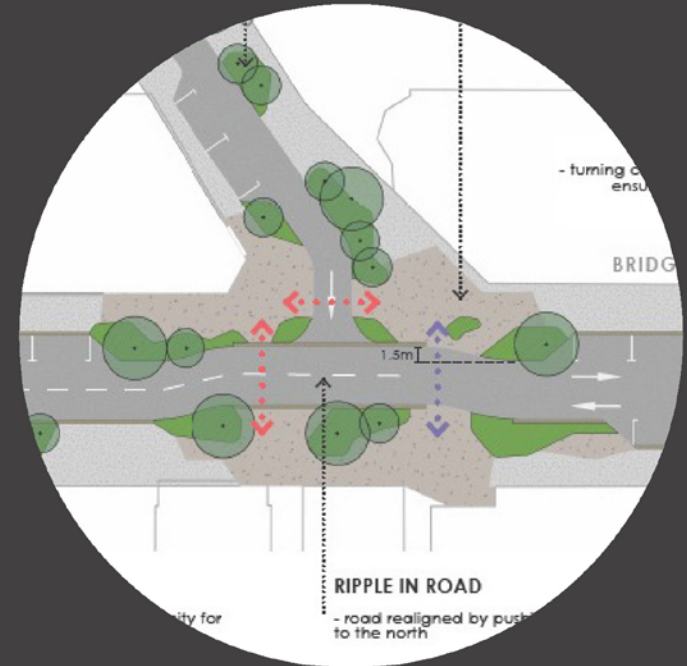
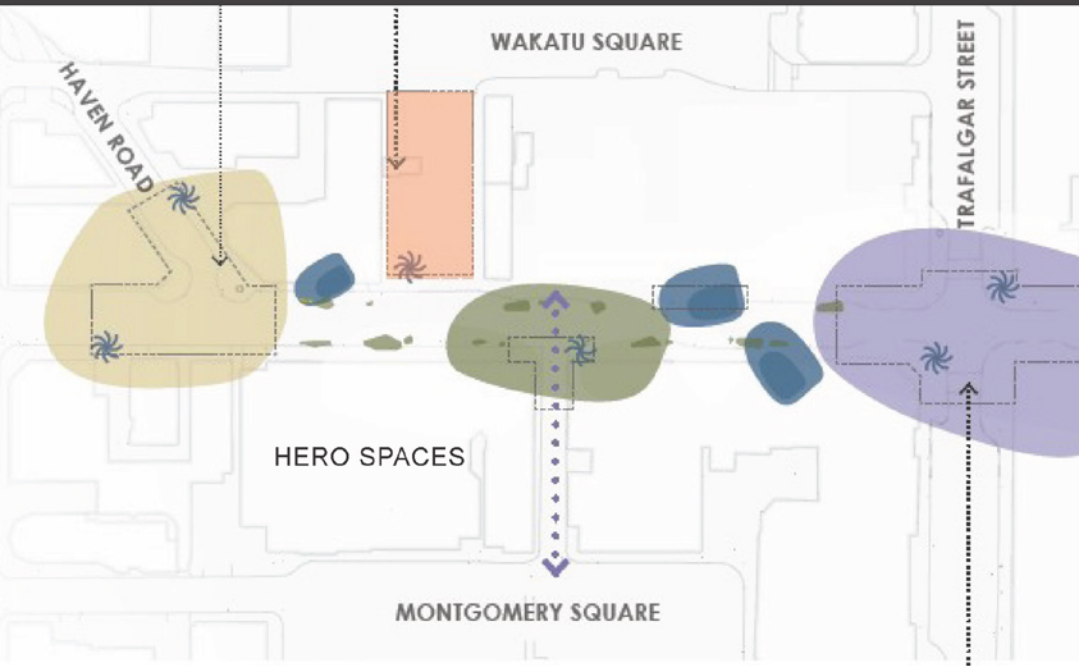

5
**Embed cultural
values**

1 Focus Investment



-  HERO SPACE
-  ENTRANCE THRESHOLD
-  TRANSITIONAL SPACE

2 Flexible Design



TWO-WAY



+

FUTURE ONE-WAY?



3 Spatial Allocation



4 Leverage 'need-to-haves'

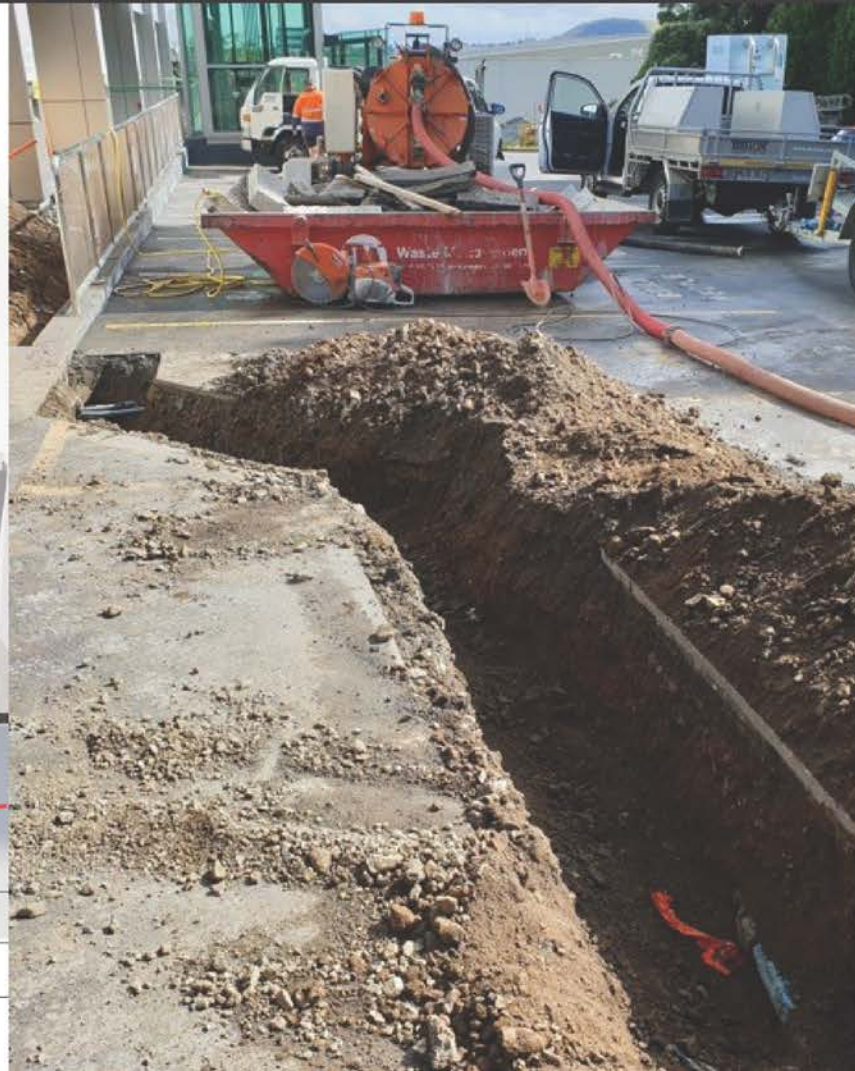
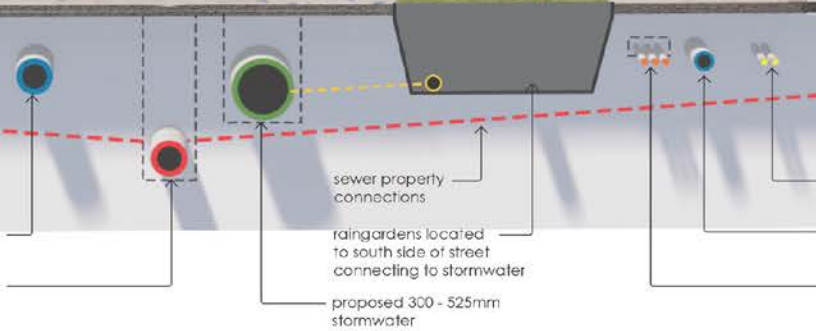

5 Embed cultural values

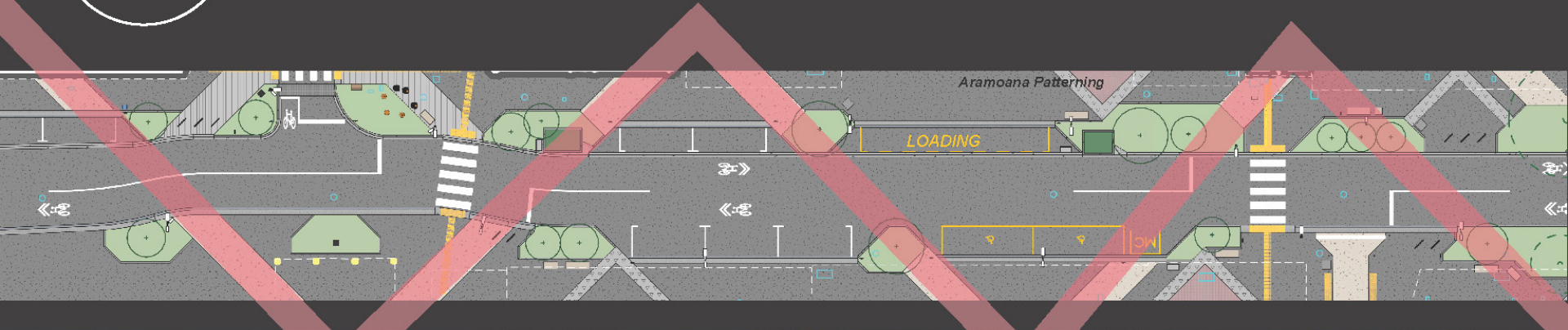

Bridge Street Outcomes



**City Centre
Greening**



**Street-based
Activities**



**Active
Travel**



**Cultural
Values**



**Raising
Residents**

Final Thoughts



**Aspiration
2021**



**Construction
2026**

Thank you



Alan.Gray@boffamiskell.co.nz



Megan.Walker@boffamiskell.co.nz