



# Hayes Paddock

Creating a Walkable Neighbourhood



**Hamilton  
City Council**  
Te kaunihera o Kirikiriroa



# Hayes Paddock - Creating a Walkable Neighbourhood

The Hayes Common, Hayes Paddock and Wellington Street Beach is an area which attracts a lot of visitors to the area either by walking, biking, and other sustainable modes.

There is a strong desire line for pedestrians to cross there to access the river, playground, and café.

## Overall Project Objectives:

- Improve walkability
- Improve bikability
- Improve Connections to the River



# What we were working with



18 March 2026

Neighbourhood

# Data Driven decisions

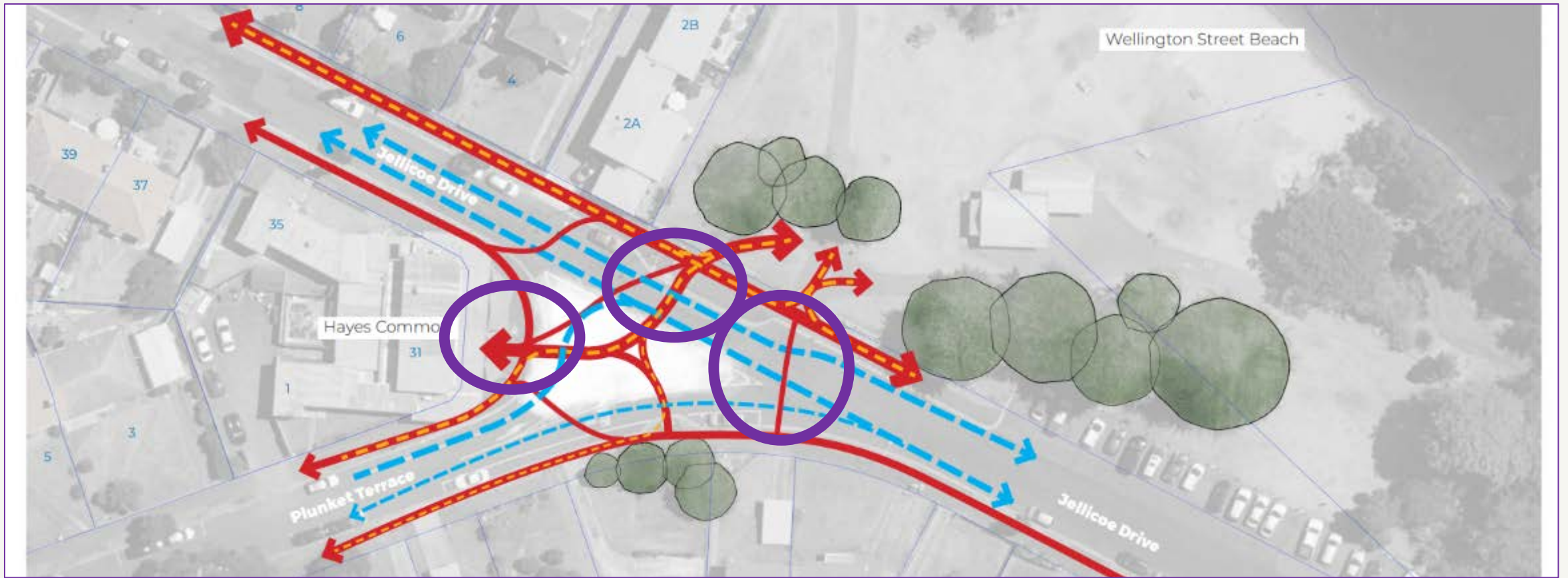

# Safety and Accessibility Issues

- High travel demand to the area - through all modes
- Drivers use the intersection to complete U-turns, especially when visitors are looking for a carpark
- Obstructive parking near the intersection and driveways
- The pedestrian crossing gets obstructed by the buses when they stop
- Entry speeds into Plunket Terrace *feel high* and visibility of pedestrians at the crossing is blocked by parked vehicles

# Community Engagement

**Extensive community engagement on the two options shown below was undertaken between 17 May and 16 June 2023. A rescheduled focus group meeting took place on 26 June 2023.**

Summary below of how the project was communicated:

- Several meetings with Hayes Common Café before community engagement started;
- brochure delivery to the neighbourhood;
- media story with the Waikato Times;
- project collateral displayed at Hayes Common Café ;
- Corflute signs around Hayes Paddock;
- Facebook post and sponsored Facebook by Hamilton City Council;
- Facebook post by Waka Kotahi NZ Transport Agency;



**Come to our  
drop-in session to get  
more information and  
provide feedback:  
Monday 12 June  
4.30pm - 7pm  
Hayes Common café**

# Community Engagement

## Feedback was gathered through the following channels:

- 'Have Your Say' online survey;
- multiple rounds of door knocking and conversations with immediate neighbours on Plunket Terrace, Jellicoe Drive and Galway Avenue;
- drop boxes at Hayes Common Café;
- two focus groups at Hayes Common Café;
- a drop-in session at Hayes Common Café; and
- two pop-up conversations at Hayes Paddock Reserve.

**Have your say**  
**Hayes Paddock neighbourhood changes**

Please take a brochure and give us your feedback by placing it in the boxes provided

Tell us what to do ...

**Option one: cul-de-sac**

- larger community space – 350m<sup>2</sup>
- no exit to Jellicoe Drive from Plunket Terrace (at this end)
- no left turn into Plunket Terrace from Jellicoe Drive
- parking location changes.

**Option two: one way exit**

- smaller community space – 220m<sup>2</sup>
- right turn only from Plunket Terrace to Jellicoe Drive
- no left turn into Plunket Terrace from Jellicoe Drive
- parking location changes.

**Feedback closes 16 June 2023.**  
For more information, please go to: [Hamilton.govt.nz/CERF](https://www.hamilton.govt.nz/CERF)

WAKA KOTAHI  
NZ TRANSPORT  
AGENCY

Transport Choices

Climate Emergency  
Response Fund Programme

Hamilton City Council  
Te Kaitiaki o Ōhāriu

# Options presented to the Public

Option 1 - cul-de-sac Plunkett Terrace

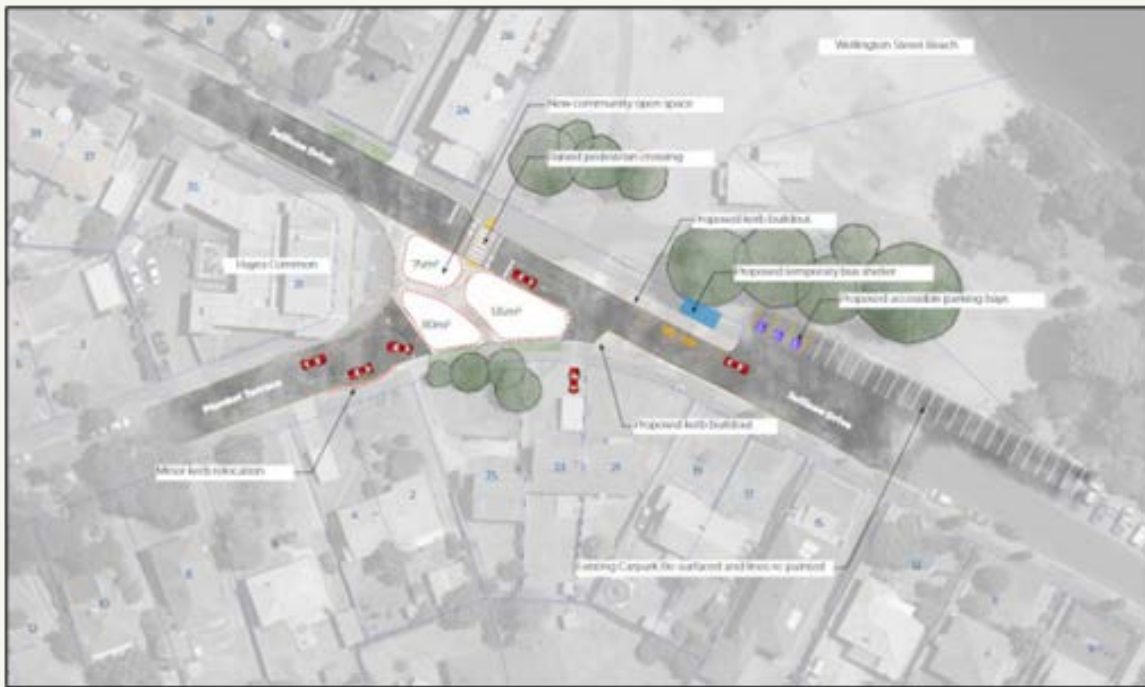

Option 2 – one-way exit from Plunkett Terrace onto Jellicoe Drive

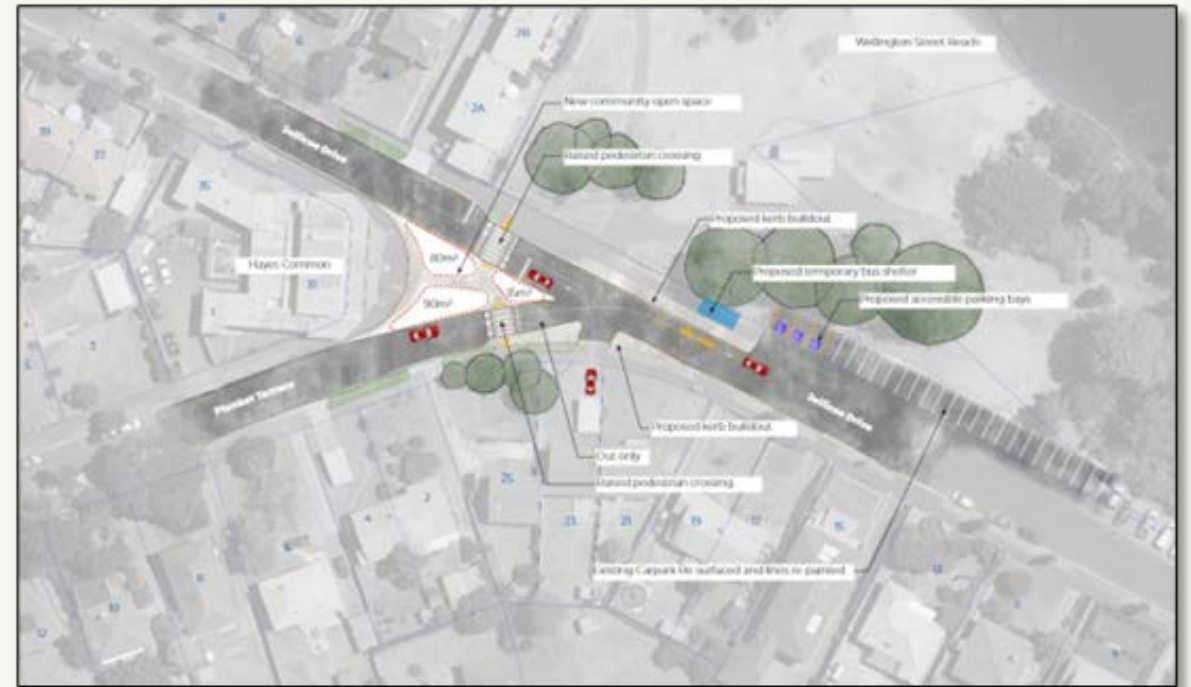

# Options presented to the Public results

Preferred Option	Responses	Percentage
Cul-de-sac (Option 1)	99	42%
One-way exit (Option 2)	66	28%
Opposed	62	27%
No preference	6	3%
<b>TOTAL RESPONSES</b>	<b>233</b>	<b>100%</b>

# Back to the drawing board.....

Following on from the public engagement a subsequent Council meeting, we were asked to look at option around keeping Jellicoe Drive open two-way.

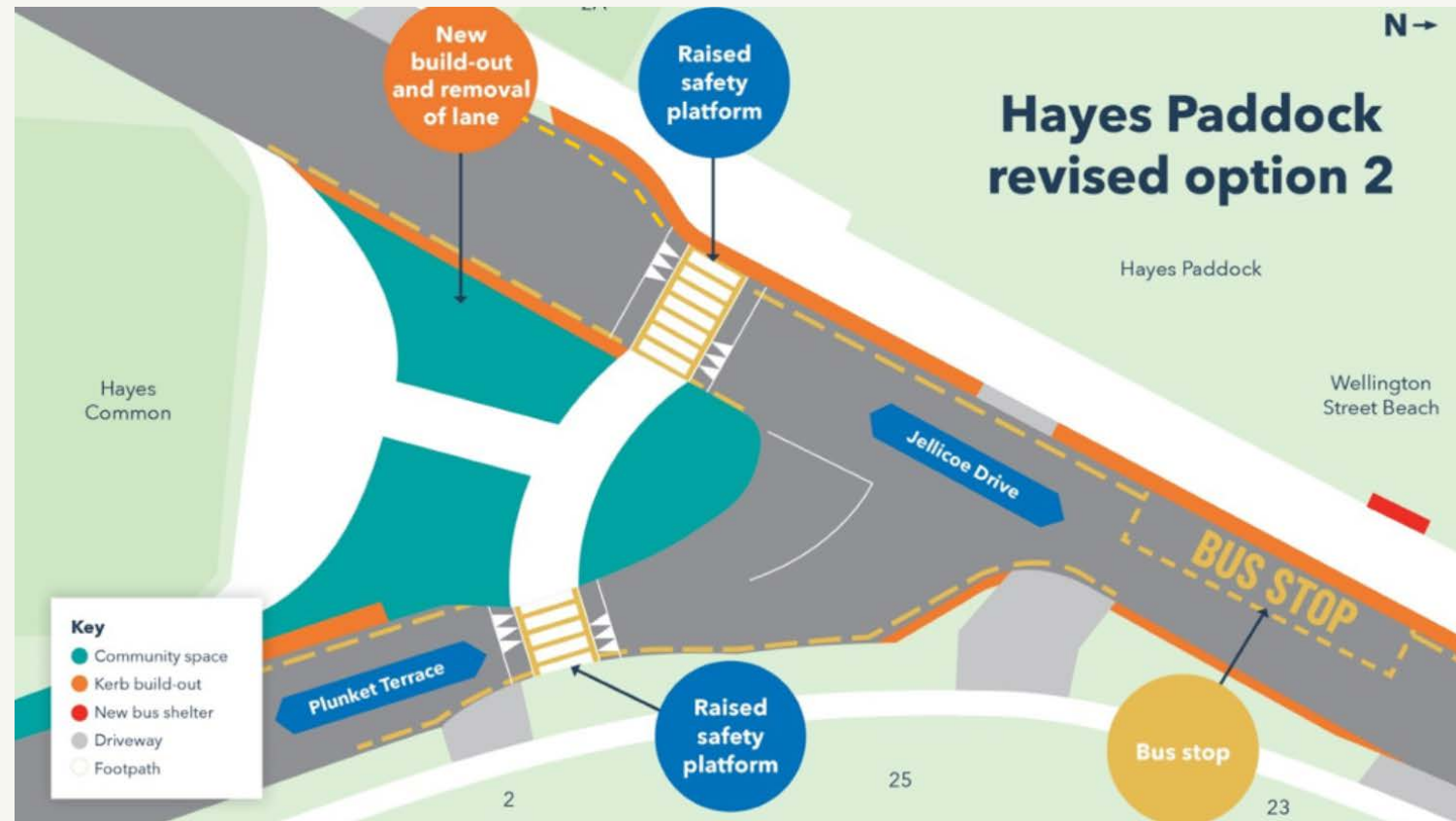

# Community Space Design

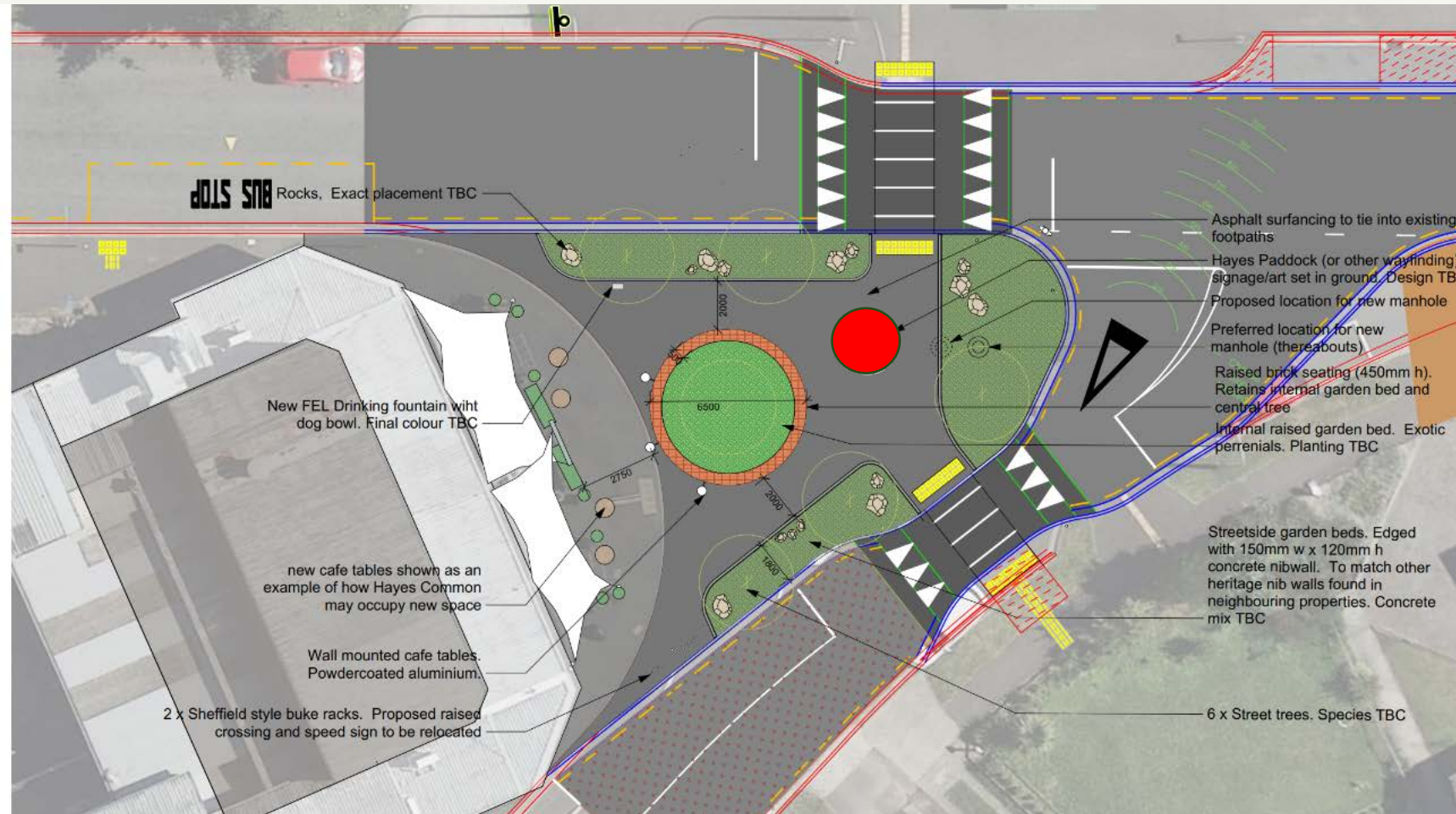

# Sculpture

Acquired from the Artist,  
originally on display from  
the Boon Street Art Festival

Fits the area well:

- Doesn't block sightlines
- Low maintenance
- Interesting, but doesn't take away from the area



# Construction

Started in April 2024

Brought a great contractor on board

Café worked with us - to find the best time to build

Closed the road for the first two weeks



# Construction



# Official Site opening June 2024



# Site opens to public



18 March 2026

Presentation title

17





# Activation Event

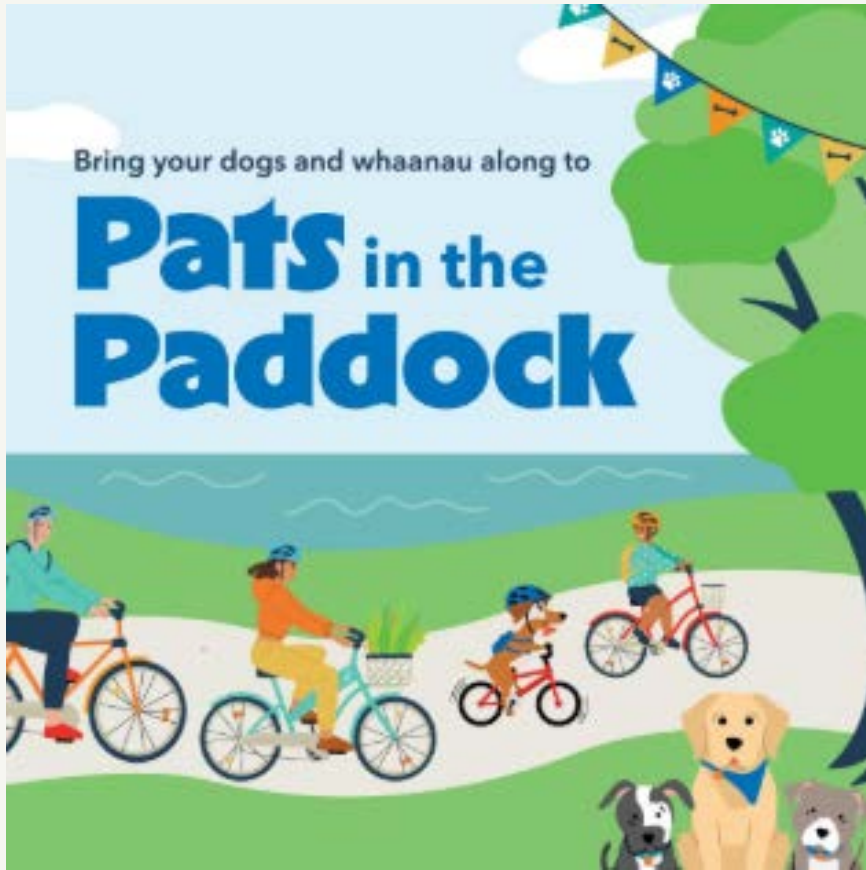

# Is it now Walkable?



Total number of pedestrian using the area	
Before	After
387	435



Total number of Cyclists using the area	
Before	After
70	44



Patronage Data (Monthly Average)			
33 Jellicoe Drive		2A Jellicoe Drive	
Before	After	Before	After
29	50	51	58

# Changes in 2025

## Improvements to Wellington Street Beach



18 March 2026

Preser



Politics

**‘Style and energy’ - van de Molen wins MPs manu challenge**

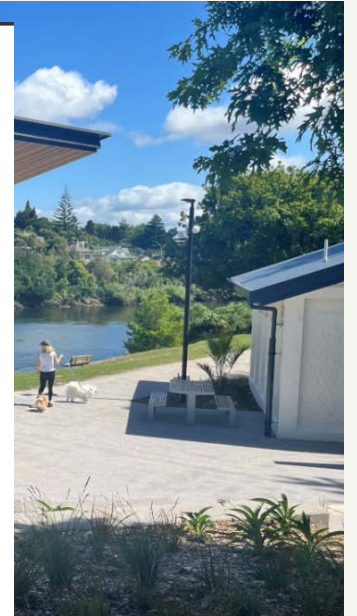

 07 838 6699

 HamiltonCityCouncil

 info@hcc.govt.nz

 @hamilton\_city\_nz

**hamilton.govt.nz**

