



*Tauranga City*

# Street Design Toolkit: Five years on

Peter Siemensma

Sarah Dove

10 March 2026

# Introduction

- Are you involved in any phase of road planning or road design?
  - Do the various teams have different objectives?
  - Are some people still unhappy with the result?
- 
- Well, you're not alone! These challenges were the reason for Tauranga City to develop the Street Design Toolkit
- 
- Toolkit being used for 5 years, so time to share our experience.



# Link and Place

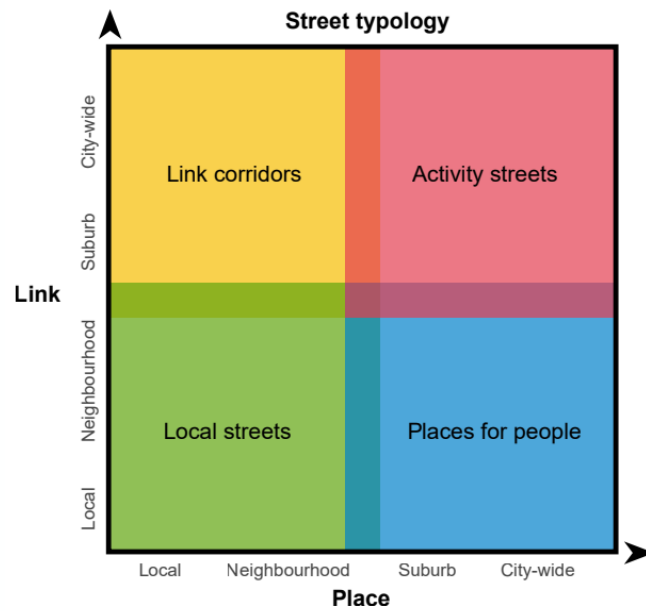

# Street Design Toolkit

## Guide

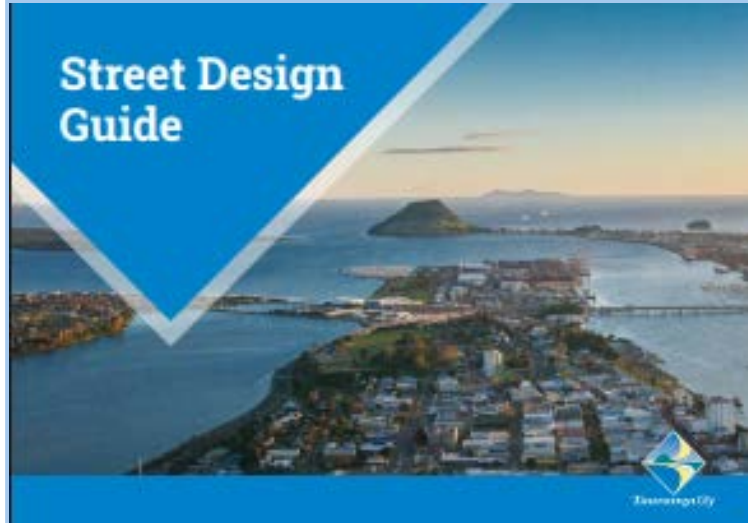

## Toolkit

Movement lane elements (1)

Select one element

Indicator	<input type="checkbox"/> Dual carriageway (two lanes in each direction)	<input checked="" type="checkbox"/> One lane in each direction, with central reservation	<input type="checkbox"/> Two-way street, with no central reservation	<input type="checkbox"/> Single lane street, two-way with passing bays	<input type="checkbox"/> Single lane street, one-way
Road classification: Collector	Acceptable and preferred	Mandatory unless criteria met	Acceptable but not preferred	Prohibited	Prohibited
*"Vehicular" traffic volumes per day: 1000-5000	Acceptable but not preferred	Mandatory unless criteria met	Acceptable but not preferred	Prohibited	Prohibited
Bus route: Secondary	Prohibited unless criteria met	Mandatory unless criteria met	Prohibited unless criteria met	Prohibited unless criteria met	Prohibited unless criteria met
Freight: Or freight class	Mandatory unless criteria met	Acceptable and preferred	Prohibited	Prohibited	Prohibited
On-cycle plan or planned key cycle route: Yes	Not Applicable	Not Applicable	Not Applicable	Not Applicable	Not Applicable
Overland flow path: Minor	Not Applicable	Not Applicable	Not Applicable	Not Applicable	Not Applicable
Located within or adjacent to stormwater escape decommissioning zone: Yes	Not Applicable	Not Applicable	Not Applicable	Not Applicable	Not Applicable

Driving elements (1)

Select all elements that apply

Indicator	<input type="checkbox"/> Solid or planted central median	<input checked="" type="checkbox"/> Access restriction	<input checked="" type="checkbox"/> Wide lane for truck or bus (pavement lane)	<input type="checkbox"/> Bus/High occupancy vehicle (HOV) lane	<input type="checkbox"/> Central flush median
Road classification: Collector	Acceptable but not preferred	Acceptable and preferred	Not Applicable	Not Applicable	Acceptable and preferred
*"Vehicular" traffic volumes per day: 1000-5000	Acceptable but not preferred	Acceptable and preferred	Acceptable and preferred	Not Applicable	Acceptable and preferred
Bus route: Secondary	Not Applicable	Acceptable and preferred	Mandatory	Acceptable and preferred	Acceptable and preferred
Freight: Or freight class	Not Applicable	Mandatory	Mandatory	Acceptable and preferred	Mandatory unless criteria met
On-cycle plan or planned key cycle route: Yes	Not Applicable	Not Applicable	Not Applicable	Not Applicable	Not Applicable
Overland flow path: Minor	Not Applicable	Not Applicable	Not Applicable	Not Applicable	Not Applicable
Located within or adjacent to stormwater escape decommissioning zone: Yes	Not Applicable	Not Applicable	Not Applicable	Not Applicable	Not Applicable

## Design Diagrams

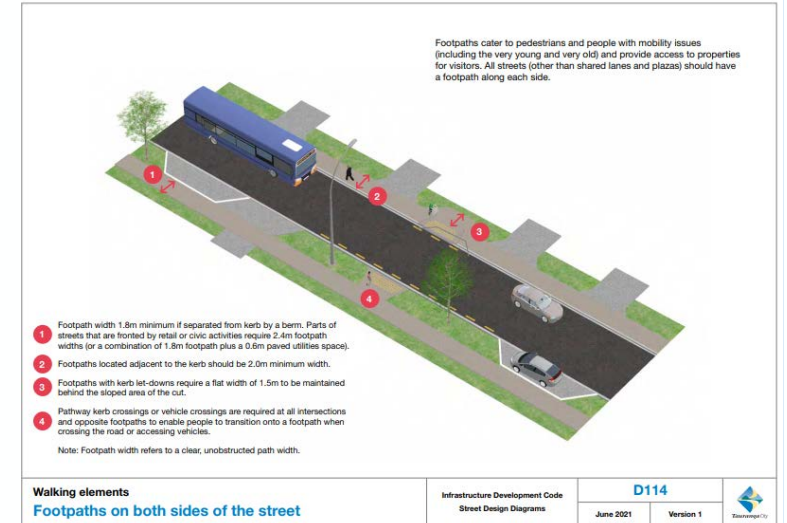

# Two examples: 1: Wairakei 2: Tauriko West

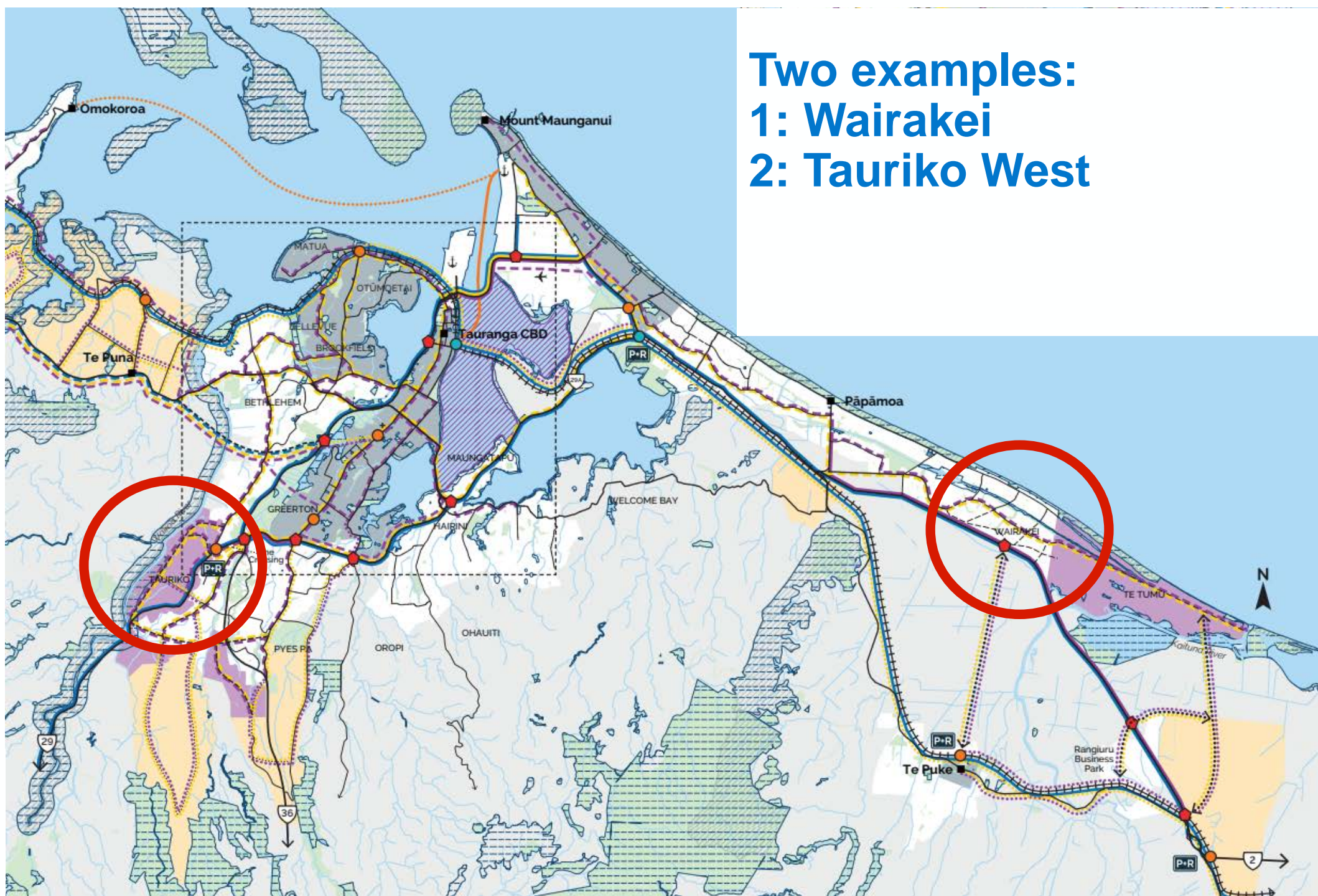

# Wairakei / The Sands Town Centre



# Local road - Residential



## Street design tool report

### Project details

Project name	Golden Sands Stage 70
Street reference	Carronade Street
Designer	
Company	
Contact phone number	
Email address	
Revision number	
Revision date	
Additional comments	

### Project Location

Reviewed:  Safety Team

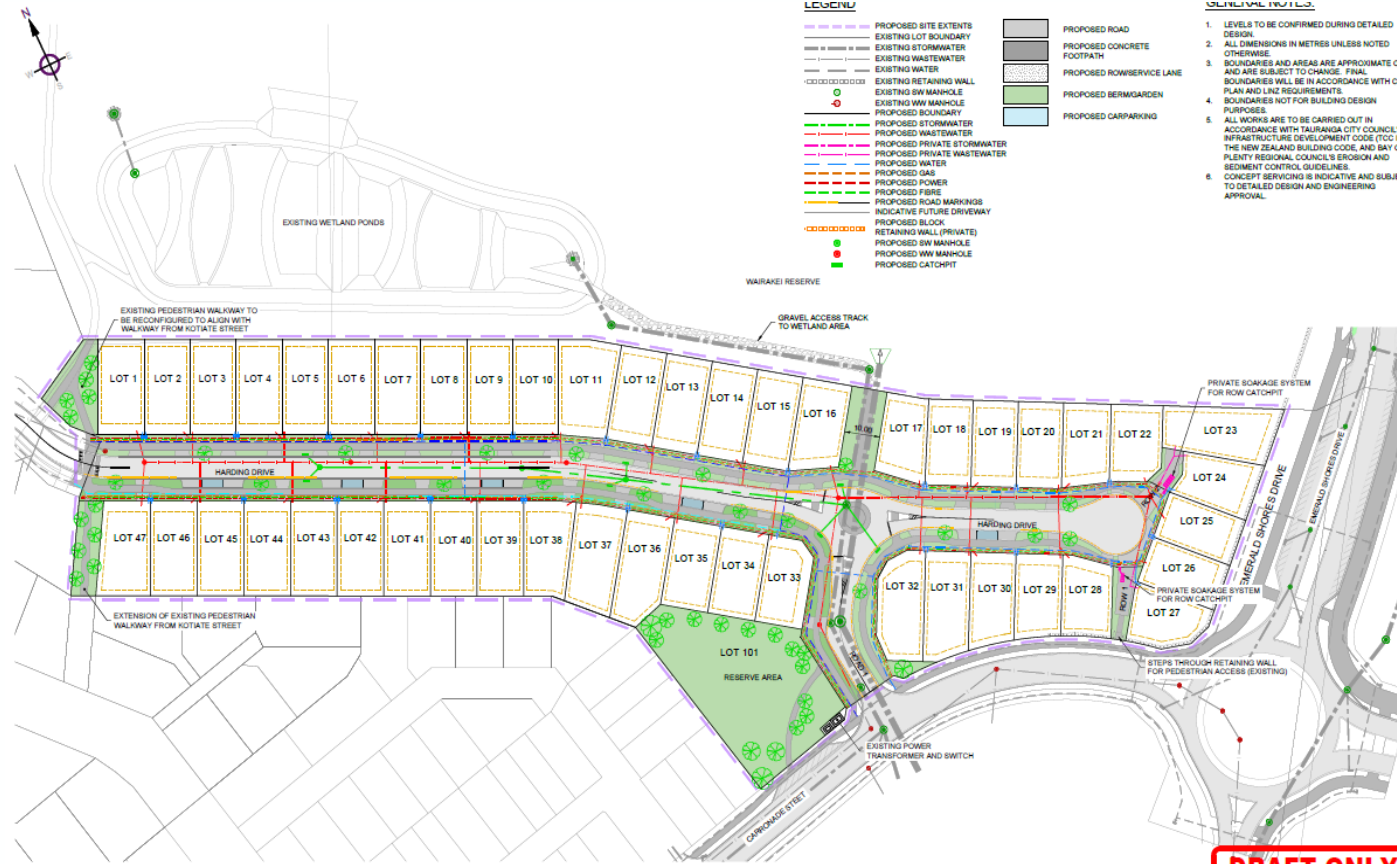

# Example: Tauriko West – Te Ara Hoia Drive (“spine road”)

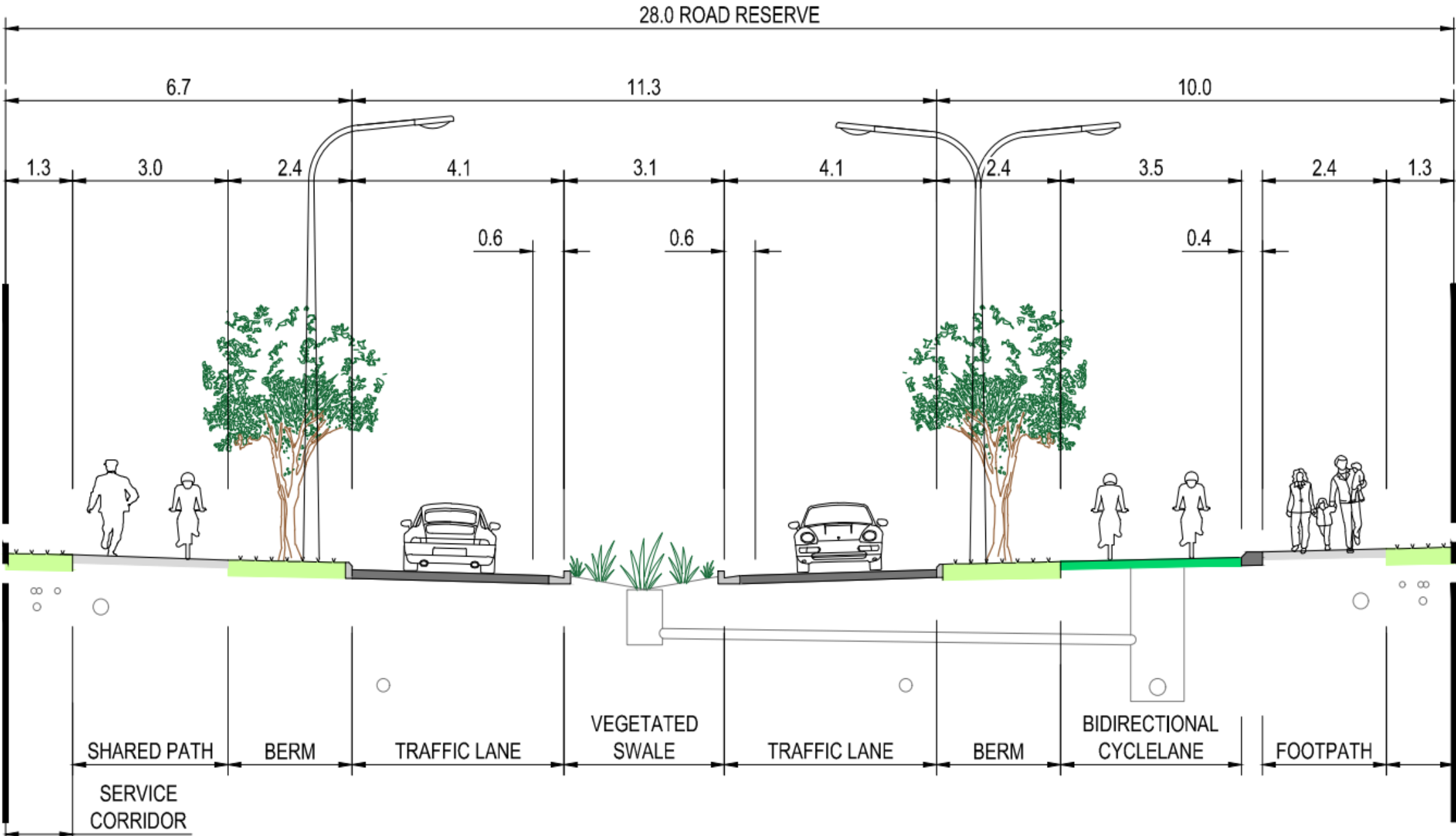

# Can we have it all?

- **Trade-offs** are inevitable
- Ask the **right questions**, and **involve everyone** to answer these
- Tauranga's Street Design Toolkit helps to do that, and it does deliver good outcomes!





# Thank you



Peter.Siemensma@tauranga.govt.nz  
Sarah.Dove@tauranga.govt.nz



tauranga.govt.nz

