

Max Pawsey Reserve – Stormwater Harvesting

Darshana Pradhan – City of Casey

Nick Andrewes – Engeny Australia

Julian Giannetti – Engeny Australia



Presentation Overview

- About Casey (1)
- Project Background & History (1)
- Project Timeline (1)
- Project Stakeholders (1)
- Detailed Design
- Stakeholder Inputs(1)
- Stakeholder Engagement(1)
- Before Detailed Design (1)
- Construction (2)
- Questions

About Casey

- One of the fastest growing municipalities in Victoria
- Council's Vision is to build Water Efficient City and adopted IWM plan in 2015
- Council has achieved a 21% reduction in per capita water usage from baseline year 2004/05 through water saving projects.
- As a part of alternative water supplies under IWM Plan within Casey followings sites are prioritised for stormwater harvesting
 - Staged delivery of Narre Warren alternative water network- Max Pawsey Reserve, Prospect Hill, Narre Warren Retarding Basin
 - Betula Reserve and Myuna Farm
 - Casey Fields
 - Muddy Gates

Project Background & History

- Narre Warren Alternative Water Network
 - Stage 1a – Deliver harvested stormwater to sports fields
 - Stage 1b & 1c – Deliver harvested stormwater to Aquatic Centre (Casey ARC)
 - Stage 2 & 3- Deliver harvested stormwater to residential and commercial properties within Narre Warren Precinct



Project Staging & Reuse Supply

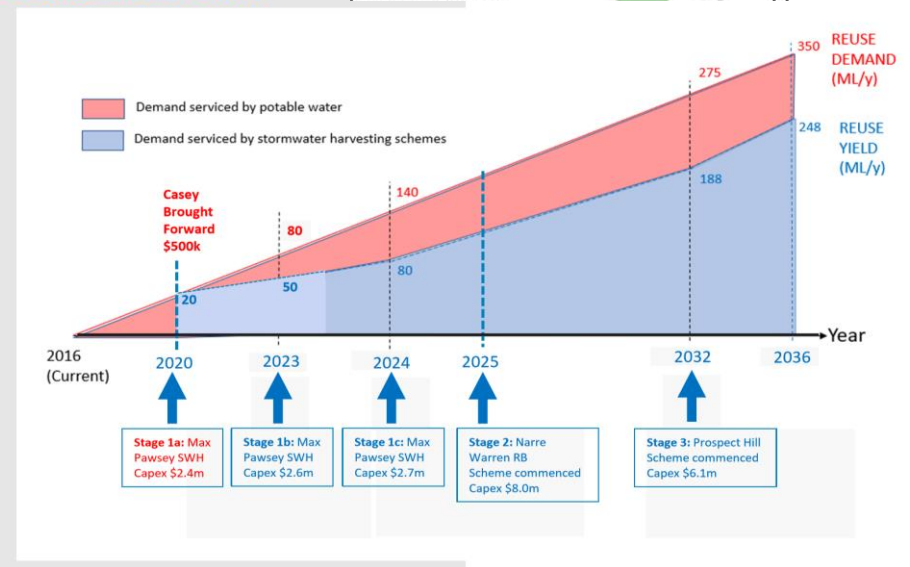

Project Timeline



Project Stakeholders

- Community
 - Involved through all phases of the project timeline
- Project Sponsors / Funding Partners
 - DEECA(formerly DELWP) - \$1.7M
 - Melbourne Water- \$550K
 - South East Water- \$200K
 - Council's contribution- \$ 3.55M
 - Total project budget to deliver stage 1A is approx. \$6M

Detailed Design

IN A RETARDING BASIN REFER TO ENGINEER'S SPECIFICATION FOR FLOOD MANAGEMENT REQUIREMENTS AND APPROVAL PRIOR TO COMMENCEMENT OF CONSTRUCTION

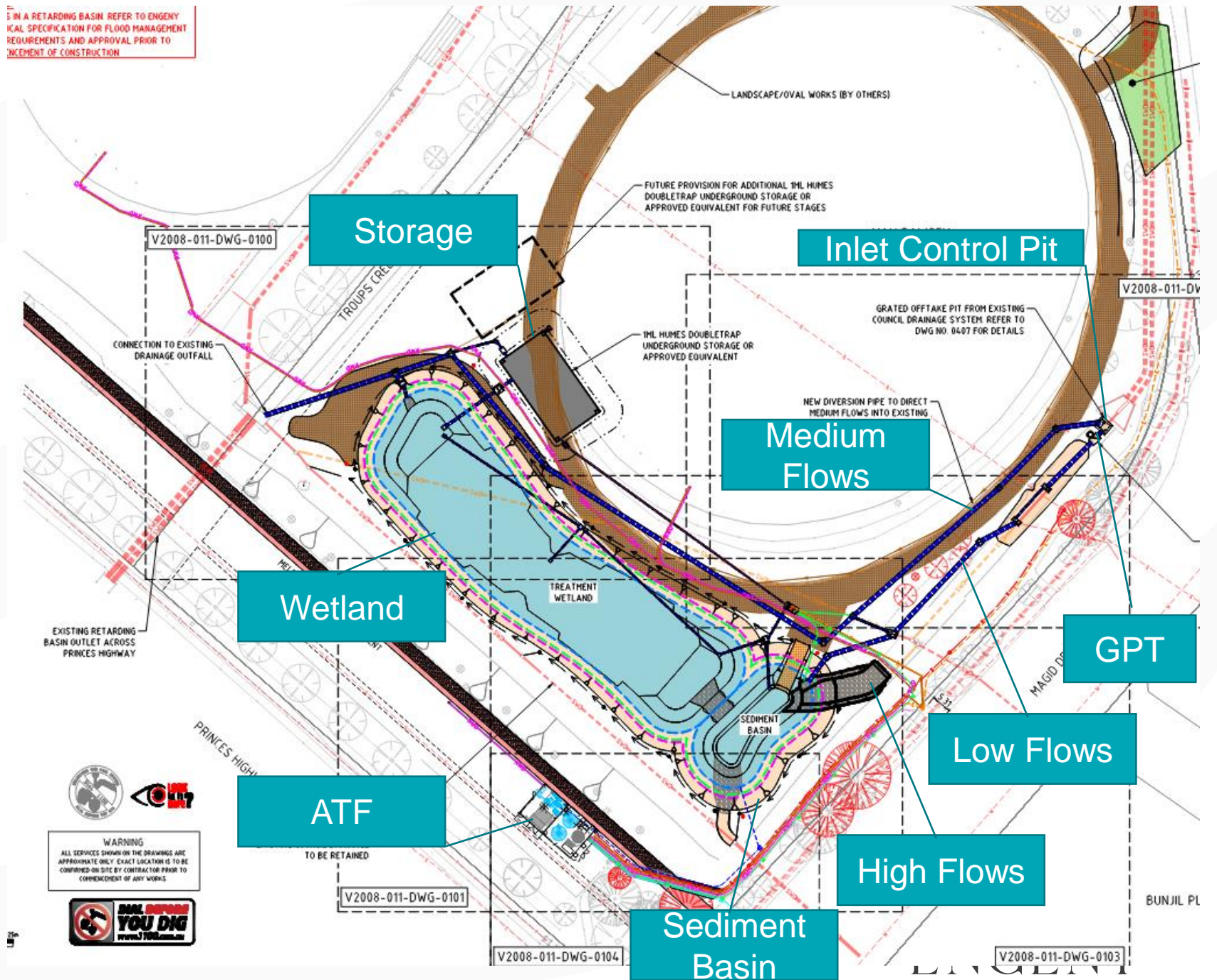

Detailed Design

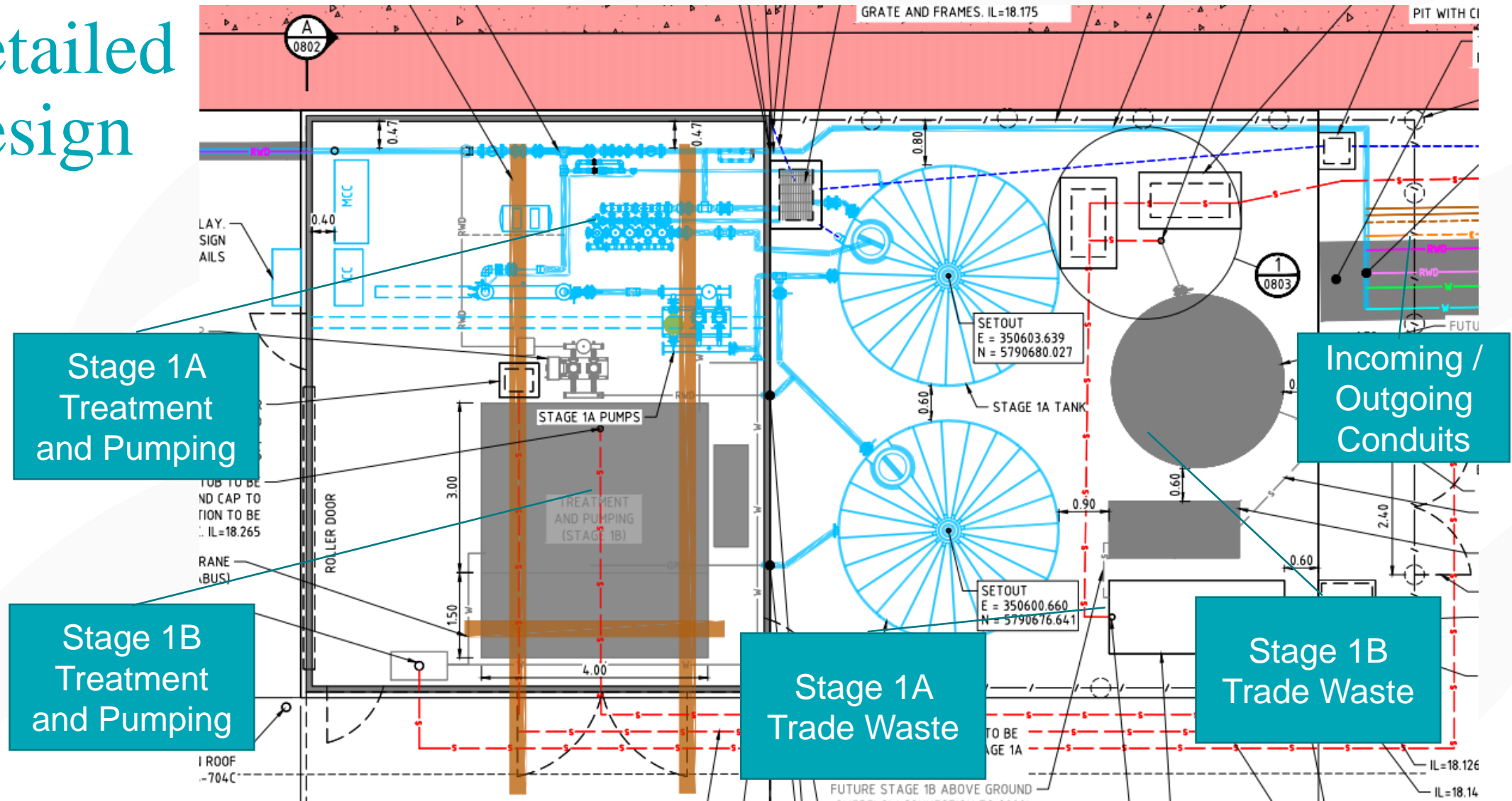

Stakeholder Inputs

Stakeholder	Design inputs
City of Casey <ul style="list-style-type: none"> - Design & Construction - Water Planning - Open Space / Recreation - Maintenance 	<ul style="list-style-type: none"> - Aesthetic outcomes - Integration with sportfield upgrade - Irrigation operation and monitoring - Maintenance of structures
Melbourne Water (MW) <ul style="list-style-type: none"> - SWH application - Build over asset application - New connection application - Review of proposed design 	<ul style="list-style-type: none"> - Failure modes and effects assessment - Connection to and replacement of existing MW asset - Retarding basin storage evaluation - Feedback on detailed design
South East Water <ul style="list-style-type: none"> - Asset Ownership (Stage 1B) - Trade Waste 	<ul style="list-style-type: none"> - Heavily involved in the design of the Advanced Treatment Facility (ATF) to ensure design suits their maintenance and operation requirements after asset handover (Stage 1B) - Approval process to direct wastewater from ATF to sewer system
EPA	Confirm water quality requirements <ul style="list-style-type: none"> - Stage 1A (National stormwater harvesting guidelines) - Stage 1B (Potable)

Stakeholder Engagement

- Early engagement to define potential conflicts
- Define champions within each organisation
- Regular tracking of a feedback and comments register
- Workshops with multiple stakeholders
- Regular meetings to discuss project progress to ensure all parties expectations are aligned – no surprises

Before Detailed Design

- Power supply location
- Location of sediment dry out area
- Hand over
 - When (if a multi-stage project)
 - What (where does it start and stop)
 - Specific requirements
 - Monitoring and control (e.g. IRRINET vs SCADA)
 - Products
 - Operation and Maintenance
 - Water quality treatment standard
- Approvals
 - Additional approvals / investigations required if work is in a retarding basin!

Construction

- Commencement Date – April 2022
- Construction Quality Assurance (CQA) role



Construction



Questions



ENGENY



ENGENY

www.engeny.com.au