

CHRIST CHURCH GRAMMAR SCHOOL — PREP SCHOOL & EARLY LEARNING CENTRE Queenslea Drive, Claremont

Architect: With_Architecture Studio

Building Contractor:

Educational and architectural ideas:

Established in 1910, CCGS is a PP-Y12 day and boarding school for boys in Perth. Scheduled for completion in 2019, the new Preparatory School will accommodate 580 boys in a premium learning environment for boys. Accommodation for pre-kindergarten and Kindergarten is also included, a new offering by Christ Church.

A core goal of the project is to consolidate the physical footprint of the Preparatory School, previously dispersed across the campus in a variety of circa 1950-1986 buildings. The new project gave the educational leaders an opportunity to create learning spaces and environments that responded to the needs of the contemporary educational setting and provide flexibility for future innovation and change.

The development is configured over three levels with GLAs on the lowest and upper-most levels, separated by a middle plane of administrative and specialist learning spaces.

The spaces were designed to be expansive and flexible. The briefing process focused specifically on enhancing boys' education, providing maximum natural light and light control to support crossover from meditation to a 'working brightness'; sound control in terms of mitigation and projection; temperature control was also an important factor; and in the Early Years, classes have a seamless transition from indoor to outdoor learning.

A key feature of the form and arrangement of the new Preparatory School is the central Innovation Hub. Sited within a large undercover play space this sculptural element houses the Library, Technology & Research and Innovation Room to be used by older students to complete longer, in-depth, STEM projects and challenges.

FACTS / FIGURES:

Gross Floor Area	6,200m ²
Final Contract Sum	\$23.1m (ex GST)
Cost per m²	\$3,725/m ² (ex GST)
Building Completion	December 2018



Image: With_Architecture Studio

Tour sponsored by:



First Floor Level

Year Four
Year Five
Year Six
Innovation Room

Upper Ground Level

Administration
Library, Research & Technology
Global Classroom
Peter Moyes Center
Visual Arts
Centre for Excellence
Learning Development Centre

Lower Ground Level (Oval)

Year Pre-kindergarten
Year One
Year Two
Year Three

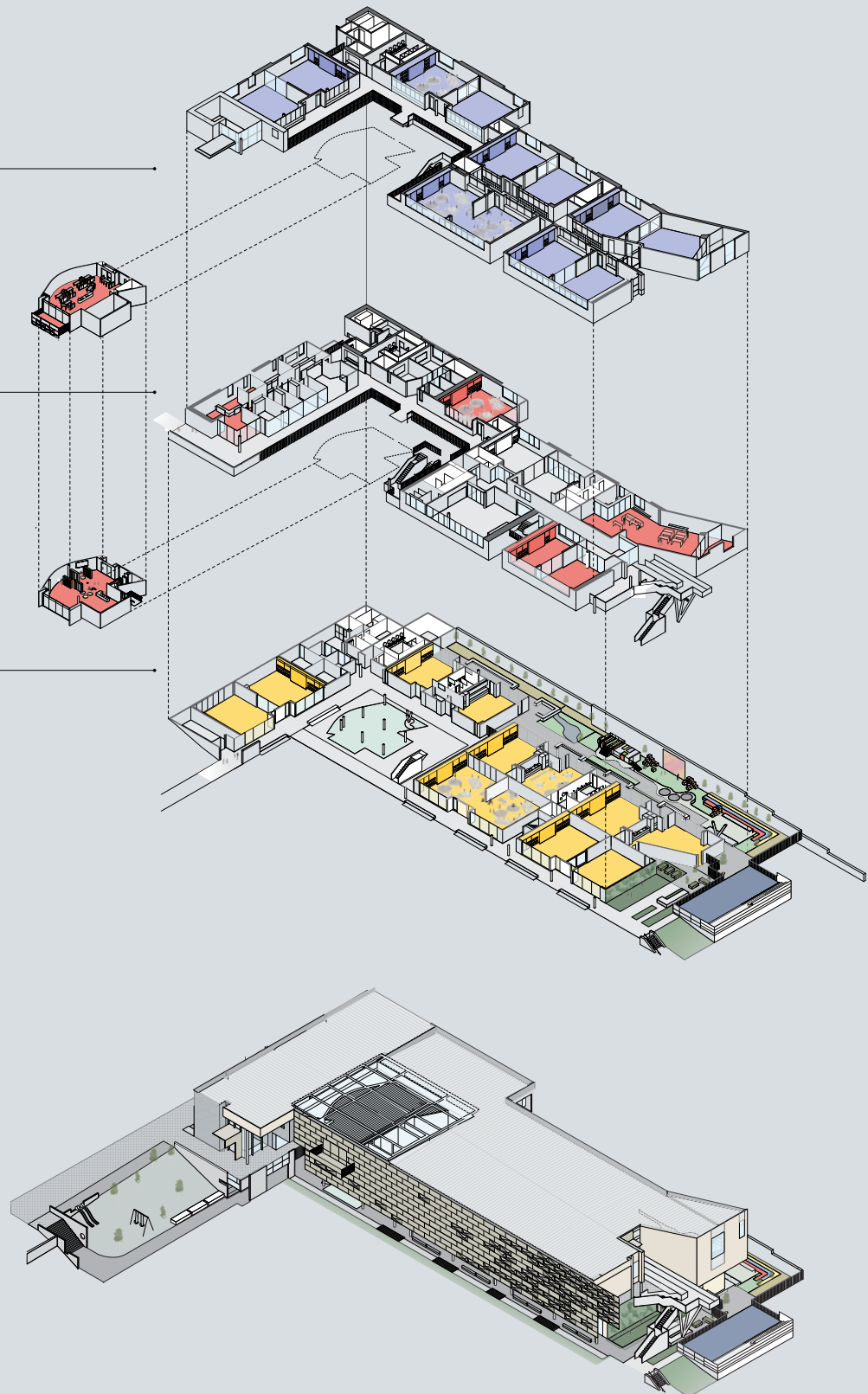

donaldson+warn

CHRIST CHURCH GRAMMAR SCHOOL — PREP SCHOOL