

# TRANS FORM ANCE

TRANSFORMING  
THE LEARNING  
LANDSCAPE

Learning Environments Australasia  
19th Annual Conference

28-31 MAY 2019  
Perth Convention  
& Exhibition Centre  
[transformance.a4le.org.au](http://transformance.a4le.org.au)



## ST JOHN BOSCO COLLEGE 170 Monticello Parkway, Piara Waters

**Architect:** Santelli Architects

**Building Contractor:** Stage 1 – Badge,  
Stage 2 – Sanpro Construction

### Educational and architectural ideas:

St John Bosco College's vision is based around creating a flourishing environment in which every student can thrive in a Catholic learning community; where development of the whole person is of utmost importance. This, along with the college's motto "Joy In Learning" assisted in shaping both the pedagogy and design language of the college.

Education at St John Bosco College is centred around The Image of the Child, The Learning Process and Environment.

St John Bosco College believe that all students can be curious, creative, critical, reflective and independent thinkers.

The flexible spaces enable a variety of learning experiences. With the ability to operate as single closed classrooms flooded with natural light, or as 4 classrooms opening between each other and central spill-out spaces, any educator's style can be accommodated.

The hardwearing material palette, splashes of colour and purposeful transparency provide a sensible and yet inspiring environment that echoes St John Bosco College's motto "Joy in Learning."

The central courtyard is the heart of the school, encouraging a sense of community that will be further developed as the campus grows into an eventual K-12 Catholic College catering for approximately 1600 students and 150 staff.

### FACTS / FIGURES:

<b>Gross Floor Area</b>	2,937.6m <sup>2</sup>
<b>Building Completion</b>	Stage 1 – Jan 2015, Stage 2 – Jan 2017



**Photographer:** Matt Biocich

Tour sponsored by:



# ST JOHN BOSCO COLLEGE

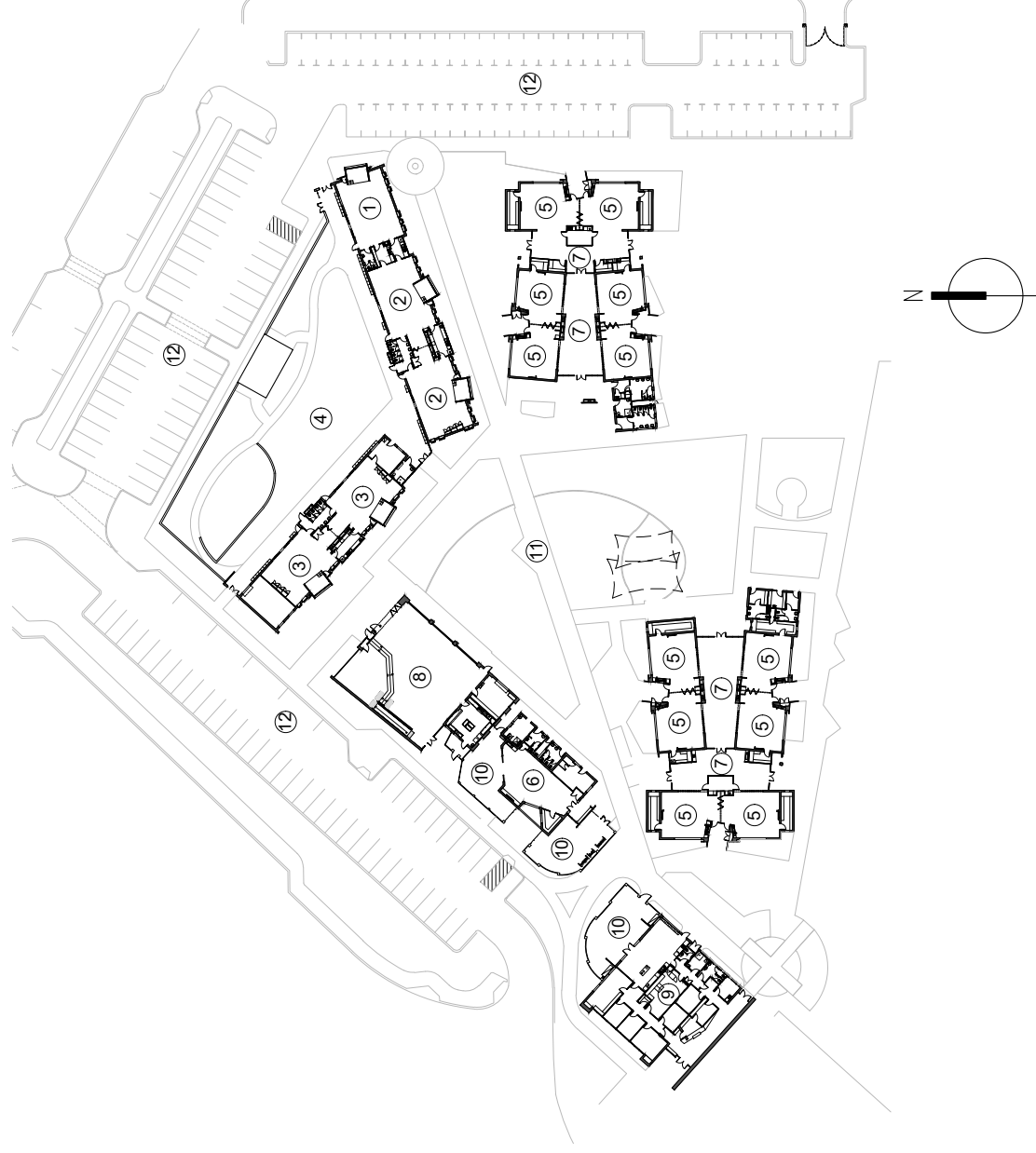

## LEGEND

- ① 3 YEAR OLD GROUP
- ② KINDERGARTEN GENERAL LEARNING AREA
- ③ PRE-PRIMARY GENERAL LEARNING AREA
- ④ EARLY-LEARNING PLAY AREA
- ⑤ PRIMARY GENERAL LEARNING AREA
- ⑥ MULTI-PURPOSE AREA
- ⑦ COLLABORATIVE LEARNING SPACE
- ⑧ COVERED ASSEMBLY
- ⑨ PRIMARY ADMINISTRATION BUILDING
- ⑩ EXTERNAL COURTYARD
- ⑪ JUNIOR COMMUNITY HUB
- ⑫ CARPARK